

2023 Legislative Directory Errata Sheet (January 25, 2023)



As of January 25, 2023, the following errata to the Legislative Directory are shown in italics and corrected in bold.

p.2	Journal Clerk, <i>Tyler Leenknecht</i> > Jacob Watkins
p.2	Doorkeeper, <i>Jacob Watkins</i> > Jim Montgomery
p.3	Pool Secretary I, <i>Elijah Phipps</i> > Hope Alles
p.4	Central Administration <i>Julie Cooper</i> > Hayley Kaae
p.6	March 24 JFAC Target to Complete Budget Setting > Sine Die Target
p.13	Mark Sauter (o) 332-1035 (h) 332-1035
p.16	Ben Toews (o) 332-1322 (h) 209-7791
p.22	DISTRICT 10 ADA & CANYON COUNTIES
p.25	Kenny Wroten Address: PO Box 3324 / Nampa 83653
p.27	Clay Handy (o) 332-1074 (h) 332-1074
p.28	Colin Nash Committees: <i>State Affairs</i> > Appropriations
p.29	Dustin Manwaring (o) 332-1079 (h) 252-5295
p.30	Brooke Green Committees: <i>Appropriations</i> > State Affairs

p.34	Removed : <i>Committee: Business</i> > Jason A Monks
p.36	Chenele Dixon ... (h) 281-5664 > 332-1024
p.47	DISTRICT 35 BANNOCK , BEAR LAKE, BONNEVILLE, ...
p.55	Senate Transportation Secretary: <i>Tessa Nixon</i> > Lena Amoah
p.55	House Business Secretary: <i>Elbia Christensen</i> > Michelle Anderson
p.55	House Judiciary, Rules & Administration Secretary: <i>Jamie Daniels</i> > Nancy Conrad
p.55	House Local Government Secretary: <i>Michelle Anderson</i> > Elijah Phipps
p.55	House Resources & Conservation Secretary: <i>Michelle Anderson</i> > Cameron Douglas
p.55	House Revenue & Taxation Secretary: <i>Amily Kleinworth</i> > Jocelyn Lamb
p.55	House Ways & Means Secretary: <i>Ways & Means Secretary</i> > Wendy Carver-Herbert
p.59	Senate Transportation Secretary: <i>Tessa Nixon</i> > Lena Amoah
p.60	House Appropriations <i>Brooke Green</i> > Colin Nash
p.61	Removed: <i>Jason Monks</i> > House Business Committee
p.61	House Business Secretary: <i>Elbia Christensen</i> > Michelle Anderson
p.61	Added <i>Ivie, Crystal (WG108)</i> ...332-1408
p.63	House Judiciary, Rules & Administration Secretary: <i>Jamie Daniels</i> > Nancy Conrad
p.64	House Local Government Secretary: <i>Michelle Anderson</i> > Elijah Phipps
p.64	House Resources & Conservation Secretary: <i>Michelle Anderson</i> > Cameron Douglas
p.65	House Revenue & Taxation Secretary: <i>Amily Kleinworth</i> > Jocelyn Lamb
p.65	House State Affairs <i>Colin Nash</i> > Brooke Green

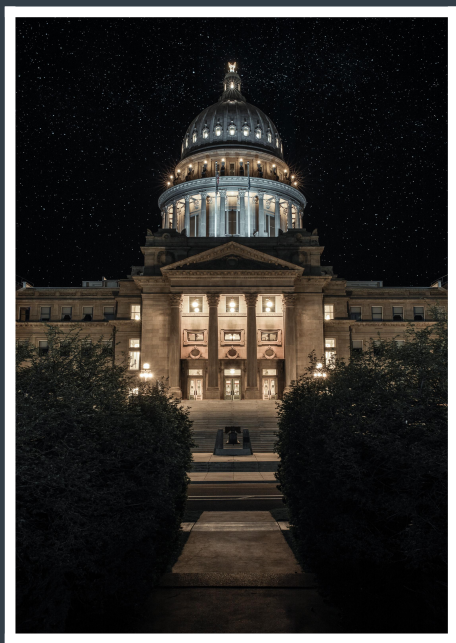

p.66	House Ways & Means Secretary: <i>Ways & Means Secretary</i> > Wendy Carver-Herbert
p.67	Added Alles, Hope (E138)...332-1051
p.67	Added Carver-Herbert, Wendy (EW12)...332 - 1159
p.68	Removed <i>Crawford, Amanda (WG10) ... 332-1418</i>
p.68	Removed <i>Daniels, Jamie (EW56) ... 332-1127</i>
p.68	Removed <i>Guerber, Steve (WG10B) ... 332-1408</i>
p.69	Removed <i>Kleinworth, Amily (EW54) ... 332-1125</i>
p.69	Removed <i>Leenknecht, Tyler (W326A) ... 332-1312</i>
p.71	<i>Phipps, Elijah (E138)...332-1051</i> > (EW16)...332-1147
p.71	Removed <i>Secretary, Ways & Means (EW12)... 332-1159</i>
p.72	Removed <i>Wagner, Zachary (WG10B) ... 332-1408</i>
p.72	Added Watkins, Jacob (W326A) ... 332-1403

2023 Legislative Directory



**1st Regular Session
67th Idaho Legislature**

LEGEND

	1st Congressional District
	2nd Congressional District
	State Legislative District Boundary

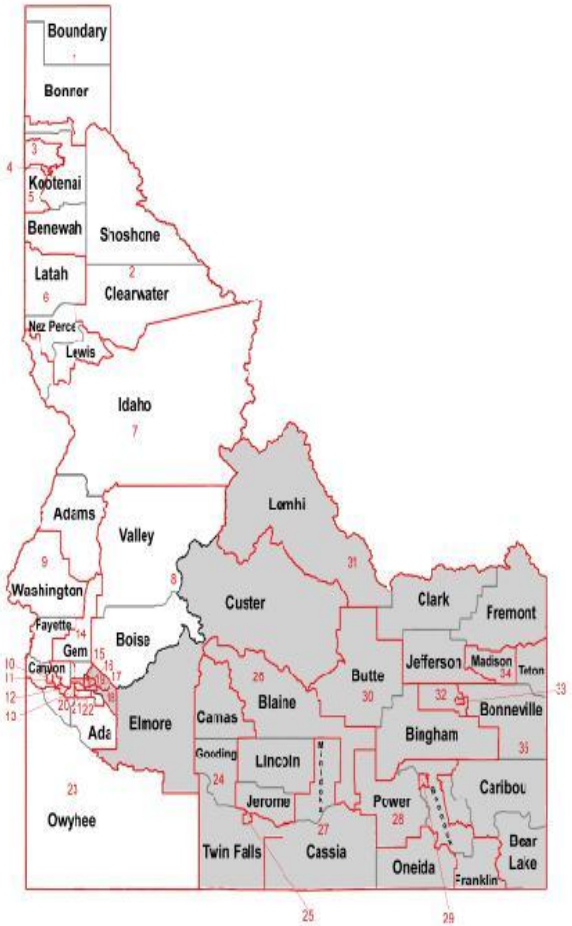

Cover Photo Midnight at the Capitol by: Dominic Tierno

CONTENTS

Senate Leadership and Administration	2
House Leadership and Administration	3
Legislative Staff Offices	4
Important Session Dates	6
Senators, Alphabetical	7
Representatives, Alphabetical	9
Legislators by District	13
Floor Maps	48
Senate Committees	56
House Committees	60
Legislative Attachés & Support Staff	67
State Government	73
Elected Officials	81
Capitol Correspondents	83
Orders of Business	85

All area codes in this Legislative Directory are 208 unless otherwise noted

How to Contact Legislators

Website	legislature.idaho.gov
Legislative Information Center	(208) 332-1000
Toll Free & TDD	800-626-0471
E-mail	idleginfo@lso.idaho.gov
Regular Mail	P.O. Box 83720, Boise, ID 83720-0038 (House) 83720-0081 (Senate)
Street Address	State Capitol, 700 W. Jefferson Boise, ID 83720

IDAHO IN SESSION

In-Capitol Cable TV:

Senate, Ch. 3.2; House, Ch. 3.1; JFAC, Ch. 3.3

Auditorium WW02, Ch. 4.1; Senate WW17, Ch. 97.1

Idaho Public Television Statewide Broadcast Channels:

Senate, World - .4; House, Plus Channel - .2

Audio/video streaming on:

www.idahoptv.org/shows/idahoinsession/Legislature/

**Current Legislative Directory information available at:
www.legislature.idaho.gov**

SENATE

(All area codes are 208 unless otherwise noted)

Leadership

President Pro Tempore, Chuck Winder (W331).....	332-1300
Admin Asst to Pro Tem, Rellie Wisdom (W331).....	332-1302
Majority Leader, Kelly Anthon (W330).....	332-1305
Asst to Majority Ldr, Peggy Moyer (W330).....	332-1303
Assistant Majority Leader, Abby Lee (W428).....	332-1308
Asst to Asst Maj Ldr, Kay Maurin (W428).....	332-1307
Majority Caucus Chair, Mark Harris (W435).....	332-1304
Asst to Maj Cauc Chr, Gaye Bennett (W435).....	332-1341
Minority Leader, Melissa Wintrow (W303).....	332-1410
Minority Chief of Staff, Heidi Pantera (W304).....	332-1351
Assistant Minority Leader, James Ruchti (W406).....	332-1411
Min Caucus Chr, Janie Ward-Engelking (W405).....	332-1412

Presiding Officer

President of the Senate, Scott Bedke (E219).....	334-2200
--	----------

Administration

Secretary of the Senate, Jennifer Novak (W327).....	332-1309
Sec to Sec of Senate, Twyla Melton (W326).....	332-1310
Journal Clerk, Jacob Watkins (W326A).....	332-1312
Assistant Clerk, Jim Hickey (W326A).....	332-1311
Sergeant at Arms, Sarah Jane McDonald (W307).....	332-1400
Asst Sergeant at Arms, Jerry Csutoras (WW26).....	332-1401
Chaplain, Doug Armstrong.....	332-1302
Doorkeeper, Jim Montgomery.....	332-1403

Security

Main Number.....	334-2222
3rd Floor.....	332-1403
4th Floor.....	332-1402
West Wing.....	332-1404

HOUSE OF REPRESENTATIVES

(All area codes are 208 unless otherwise noted)

Leadership

Speaker of the House, Mike Moyle (E303).....	332-1111
Chief of Staff to Speaker, MaryLou Molitor (E303)..	332-1111
Majority Leader, Megan Blanksma (E307).....	332-1120
Assistant Majority Leader, Sage Dixon (E406).....	332-1120
Majority Caucus Chair, Dustin Manwaring (E407).....	332-1120
Committee Secretary, Cameron Douglas (EW62)...	332-1136
Minority Leader, Ilana Rubel (E329).....	332-1132
Minority Chief of Staff, Joy Thomas (E331).....	332-1132
Asst Min Ldr, Lauren Necochea (E423).....	332-1132
Minority Caucus Chair, Ned Burns (E424).....	332-1132

Administration

Chief Fiscal Officer, Terri Franks-Smith (E333).....	332-1112
Chief Clerk of the House, Erica McGinnis (E304).....	332-1141
Assistant Chief Clerk, Cyrus Vore (E306).....	332-1143
Journal Clerk, Michelle Wonacott (E306).....	332-1142
Secretarial Supervisor, Susan Werlinger (EW45).....	332-1161
Pool Secretary I, Hope Alles (E138).....	332-1051
Pool Secretary II, Jazz Alexis (E110).....	332-1068
Pool Secretary III, Minority Staff (EG29).....	332-1191
Pool Secretary IV, Pool Secretary (EG07).....	332-1051
Sergeant at Arms, Jeff Wall (E311).....	332-1150
Asst Sergeant at Arms, Kim Blackburn (E311).....	332-1151
Doorkeeper, Third Floor.....	332-1154
Chaplain, Tom Dougherty.....	332-1111

Security

Main Number.....	334-2222
3rd Floor.....	332-1154
4th Floor.....	332-1155
East Wing.....	332-1157

LEGISLATIVE STAFF OFFICES

(All area codes are 208 unless otherwise noted)

Legislative Services Office

Capitol Building - W114

Terri Kondeff, Director (W125)..... 334-4828
Paul Headlee, Dep Director (W124)..... 334-4746

Central Administration - W114.....334-2475

Hayley Kaae, Admin. Assistant (W114)..... 334-4855
Michelle O'Brien, Sp. Proj. Coordinator (W135).. 334-4850
Erin Phipps, Revenue Analyst (W129)..... 334-4856
Kolby Reddish, Legal Counsel (W123)..... 332-1293

Budget and Policy Analysis - C305.....334-3531

Keith Bybee, Division Manager (C305)..... 334-4739
Jared Tatro, Deputy Div. Manager (C318)..... 334-4740
Janet Jessup, Principal Analyst (C416)..... 334-4730
Christine Otto, Principal Analyst (C421)..... 334-4732
Jill Randolph, Principal Analyst (C415)..... 334-4749
Matt Farina, Analyst (C419)..... 334-4743
Tim Hibbard, Analyst (C420)..... 334-4858
Frances Lippitt, Analyst (C417)..... 334-4745
Nathan Osborne, Analyst (C418)..... 334-4741
Alex Williamson, Analyst (C319)..... 334-4742
Angela Haugh, Project Specialist (C308)..... 334-3537
Shane Winslow, Data Systems Coord. (C317).... 334-4738

Information Technology - W114.....334-4747

Glenn Harris, Division Manager (W120)..... 334-4835
Norma Clark, Deputy Div. Manager (W118)..... 334-4849
Soren Jacobsen, Sr. IT Specialist (W121)..... 334-4848
Help Desk (W120)..... 334-4747

Legislative Audits - 700 W. State St., Ste 100.....334-4875

April Renfro, Division Manager..... 334-4826

LEGISLATIVE STAFF OFFICES

(All area codes are 208 unless otherwise noted)

Shelley Woods, Sr. Admin. Assistant.....	334-4832
Patrick Aggers, Managing Auditor.....	334-4865
Kellie Bergey, Managing Auditor.....	334-4831
Amy Brown, Managing Auditor.....	334-4866
Jim Combo, Managing Auditor.....	334-4840
Lori Hendon, Quality Assurance Mgr.....	334-4868

Research and Legislation - W133.....334-4834

Kristin Ford, Division Manager (W144).....	334-4859
Katharine Gerrity, Deputy Div. Manager (W139).	334-4867
Baylie Moore, Admin. Assistant (W133).....	334-4845
Elizabeth Bowen, Prin Drafting Atty (W141).....	334-4851
Ryan Bush, Prin Drafting Atty (W140).....	334-4857
Matt Drake, Sr. Drafting Atty (W142).....	334-4825
Trevor Ahrens, Leg Drafting Atty (W131).....	334-4821
Lara Disney, Senior Editor (W143).....	334-4852
Olivia Johnson, Editor (W132).....	334-4843
Jennifer Kish, Information Liaison (W149).....	334-4854

Legislative Research Library - 1st Floor C114.....334-4822

Eric Glover, Legislative Librarian (C113).....	334-4863
--	----------

Copy Center - C104.....334-4823

Legislative Information Center - Grdn Rotunda....332-1000

Gift Shop - CG24.....332-1013

Dianne Smith, Manager (Gift Shop).....	332-1013
--	----------

Office of Performance Evaluations

954 W. Jefferson - 2nd flr

Rakesh Mohan, Director.....	332-1480
-----------------------------	----------

IMPORTANT SESSION DATES

January 9	Legislature Convenes
January 20	Senate Personal Bill Introduction Deadline
January 27	House Personal Bill Introduction Deadline
February 3	36th Day Bill and Joint Resolution Legislative Services Office RS Deadline
February 13	36th Day Bill and Joint Resolution/Constitutional Amendment Introduction Deadline, with exceptions for privileged committees: Senate Finance, Judiciary and Rules, and State Affairs Committees; and House Appropriations, Education, Health & Welfare, Revenue & Taxation, State Affairs and Ways & Means Committees
February 17	JFAC Target to Complete Budget Hearings
March 3	Committee Target to Report on Rules Review
March 6	Transmittal Date for Joint Resolutions/Constitutional Amendments Target for Transmittal of All Legislation Between Houses
March 10	JFAC Target to Complete Budget Setting
March 24	Sine Die Target (75th Day)

SENATORS

28 Republicans / 7 Democrats

(All area codes are 208 unless otherwise noted)

	District	Page
Adams, Ben (R), Canyon County.....	12	24
332-1336 Rm: WW27		
Anthon, Kelly Arthur (R), Cassia, Minidoka, Onei....	27	39
332-1305 Rm: W330		
Bernt, Treg A. (R), Ada County.....	21	33
332-1331 Rm: WG45		
Bjerke, Carl J. (R), Kootenai County.....	5	17
332-1421 Rm: WG44		
Burtenshaw, Van T. (R), Clark, Fremont, Jeffers.....	31	43
332-1342 Rm: WW37		
Carlson, Cindy J. (R), Adams, Idaho, Nez Perce	7	19
332-1355 Rm: WG36		
Cook, Kevin (R), Bonneville County.....	32	44
332-1358 Rm: WW46		
Den Hartog, Lori (R), Ada County.....	22	34
332-1340 Rm: WW28		
Foreman, Daniel D. (R), Latah, Lewis, Nez Percé.....	6	18
332-1405 Rm: WG37		
Grow, C. Scott (R), GEM & Ada Counties.....	14	26
332-1334 Rm: C305		
Guthrie, Jim (R), Bannock, Franklin, Power Cour.....	28	40
332-1348 Rm: WW42		
Harris, Mark (R), Bannock, Bear Lake, Bonneville.....	35	47
332-1304 Rm: W435		
Hart, Phil (R), Benewah, Clearwater, Kootenai,	2	14
332-1345 Rm: WG33		
Hartgen, Linda Wright (R), Twin Falls County.....	25	37
332-1318 Rm: WW31		
Herndon, Scott (R), Bonner & Boundary Countie.....	1	13
332-1349 Rm: WG35		
Just, James R. "Rick" (D), Ada County.....	15	27
332-1407 Rm: WG11		
Lakey, Todd M. (R), Owyhee, Canyon, Ada Coui.....	23	35
332-1328 Rm: WW48		
Lee, Abby (R), Payette, Washington, Canyon Cc.....	9	21
332-1308 Rm: W428		

SENATORS

(All area codes are 208 unless otherwise noted)

	District	Page
Lenney, Brian (R), Canyon County.....	13	25
332-1329 Rm: WG55		
Lent, Dave (R), Bonneville County.....	33	45
332-1313 Rm: WW39		
Nichols, Tammy (R), Ada & Canyon Counties.....	10	22
332-1423 Rm: WG34		
Okuniewicz, Doug (R), Kootenai County.....	3	15
332-1338 Rm: WW33		
Rabe, Alison "Ali" (D), Ada County.....	16	28
332-1409 Rm: WG03		
Ricks, Doug (R), Madison County.....	34	46
332-1301 Rm: WW50		
Ruchti, James D. (D), Bannock County.....	29	41
332-1411 Rm: W406		
Schroeder, Geoff (R), Boise, Valley, Elmore, Cus.....	8	20
332-1344 Rm: WW30		
Semmelroth, Carrie (D), Ada County.....	17	29
332-1352 Rm: WG02		
Taylor, Ron C. (D), Blaine, Lincoln, Jerome Cour....	26	38
332-1353 Rm: WG12		
Toews, Ben (R), Kootenai County.....	4	16
332-1322 Rm: WG54		
Trakel, Chris T. (R), Canyon County.....	11	23
332-1320 Rm: WG04		
VanOrden, Julie (R), Bingham & Butte Counties....	30	42
332-1346 Rm: WW35		
Ward-Engelking, Janie (D), Ada County.....	18	30
332-1412 Rm: W405		
Winder, Chuck (R), Ada County.....	20	32
332-1300 Rm: W331		
Wintrow, Melissa (D), Ada County.....	19	31
332-1410 Rm: W303		
Zuiderveld, Glenneda (R), Camas, Gooding, Twi....	24	36
332-1347 Rm: WG06		

REPRESENTATIVES

59 Republicans / 11 Democrats

(All area codes are 208 unless otherwise noted)

	District	Page
Alfieri, Joe (R), Kootenai County.....	4	16
332-1065 Rm: EG66		
Allgood, Christopher M. "Chris" (R), Canyon Cou.....	11	23
332-1044 Rm: EG58		
Andrus, Kevin (R), Bannock, Bear Lake, Bonneville.....	35	47
332-1045 Rm: EW11		
Barbieri, Vito (R), Kootenai County.....	3	15
332-1177 Rm: EW08		
Berch, Steve (D), Ada County.....	15	27
332-1039 Rm: EG47		
Blanksma, Megan (R), Boise, Valley, Elmore, Clatskanie.....	8	20
332-1054 Rm: E307		
Boyle, Judy (R), Payette, Washington, Canyon County.....	9	21
332-1064 Rm: E133		
Bundy, Matthew "Matt" (R), Boise, Valley, Elmore, Clatskanie.....	8	20
332-1181 Rm: E141		
Burns, Ned (D), Blaine, Lincoln, Jerome Counties.....	26	38
332-1174 Rm: E424		
Cannon, David M. (R), Bingham & Butte Counties.....	30	42
332-1086 Rm: E101		
Cheatum, Richard W. "Rick" (R), Bannock, Franklin, Blaine.....	28	40
332-1046 Rm: EG64		
Chew, Sue (D), Ada County.....	17	29
332-1049 Rm: EG32		
Clow, Lance W. (R), Twin Falls County.....	25	37
332-1188 Rm: EW49		
Cornilles, Jeff J. (R), Canyon County.....	12	24
332-1033 Rm: EG52		
Crane, Brent J. (R), Canyon County.....	13	25
332-1058 Rm: EW46		
Crane, Jaron (R), Canyon County.....	12	24
332-1059 Rm: EW38-1		
Dixon, Chenele (R), Camas, Gooding, Twin Falls.....	24	36
332-1024 Rm: EG57		
Dixon, Sage G. (R), Bonner & Boundary Counties.....	1	13
332-1185 Rm: E406		

REPRESENTATIVES

(All area codes are 208 unless otherwise noted)

	District	Page
Durrant, Melissa (R), Owyhee, Canyon, Ada Co.....	23	35
332-1055 Rm: E157		
Ehardt, Barbara (R), Bonneville County.....	33	45
332-1189 Rm: EW16		
Ehlers, Jeff (R), Ada County.....	21	33
332-1072 Rm: E137		
Erickson, Marco Adam (R), Bonneville County.....	33	45
332-1073 Rm: E147		
Furniss, Rod (R), Clark, Fremont, Jefferson, Ler....	31	43
332-1056 Rm: E150		
Galaviz, Soñia R. (D), Ada County.....	16	28
332-1083 Rm: EG36		
Gallagher, Jacyn (R), Payette, Washington, Can.....	9	21
332-1166 Rm: E138-A		
Gannon, John (D), Ada County.....	17	29
332-1082 Rm: EG40		
Garner, Dan (R), Bannock, Franklin, Power Coui....	28	40
332-1081 Rm: EG50		
Green, Brooke (D), Ada County.....	18	30
332-1080 Rm: EG48		
Handy, Clay (R), Cassia, Minidoka, Oneida Cour....	27	39
332-1074 Rm: EW38-2		
Hawkins, Dale R. (R), Benewah. Clearwater, Ko.....	2	14
332-1070 Rm: EG61		
Healey, Dori (R), Ada County.....	15	27
332-1176 Rm: EG55		
Hill, Edward H. "Ted" (R), GEM & Ada Counties....	14	26
332-1124 Rm: E158		
Holtzclaw, James (R), Ada County.....	20	32
332-1041 Rm: EW08		
Horman, Wendy (R), Bonneville County.....	32	44
332-1071 Rm: C316		
Kingsley, Mike (R), Adams, Idaho, Nez Perce Co.....	7	19
332-1133 Rm: E140		
Lambert, Tina (R), Owyhee, Canyon, Ada Count....	23	35
332-1047 Rm: EG60		

REPRESENTATIVES

(All area codes are 208 unless otherwise noted)

	District	Page
Lanting, Greg L. (R), Twin Falls County.....	25	37
332-1182 Rm: EG59		
Manwaring, Dustin (R), Bannock County.....	29	41
332-1079 Rm: E407		
Mathias, Chris (D), Ada County.....	19	31
332-1076 Rm: EG41		
McCann, Lori (R), Latah, Lewis, Nez Perce Cour.....	6	18
332-1184 Rm: E105		
Mendive, Ron (R), Kootenai County.....	5	17
332-1040 Rm: EW62		
Mickelsen, Stephanie Jo (R), Bonneville County.....	32	44
332-1042 Rm: E139		
Miller, Steve (R), Camas, Gooding, Twin Falls C....	24	36
332-1061 Rm: E115		
Mitchell, Brandon (R), Latah, Lewis, Nez Perce	6	18
332-1175 Rm: E102		
Monks, Jason A. (R), Ada County.....	22	34
332-1036 Rm: EW54		
Moyle, Mike (R), Ada & Canyon Counties.....	10	22
332-1122 Rm: E303		
Nash, Colin (D), Ada County.....	16	28
332-1075 Rm: EG38		
Necochea, Lauren (D), Ada County.....	19	31
332-1078 Rm: E423		
Nelsen, Jack (R), Blaine, Lincoln, Jerome Counti....	26	38
332-1032 Rm: EG53		
Palmer, Joe A. (R), Ada County.....	20	32
332-1062 Rm: EW60		
Petzke, James (R), Ada County.....	21	33
332-1043 Rm: EG54		
Pickett, Douglas T. (R), Cassia, Minidoka, Oneid....	27	39
332-1123 Rm: EG02		
Price, Elaine (R), Kootenai County.....	4	16
332-1048 Rm: EG67		
Raybould, Britt (R), Madison County.....	34	46
332-1173 Rm: E104		

REPRESENTATIVES

(All area codes are 208 unless otherwise noted)

	District	Page
Raymond, Jerald (R), Clark, Fremont, Jefferson,....	31	43
332-1183 Rm: E159		
Redman, Jordan (R), Kootenai County.....	3	15
332-1180 Rm: EG65		
Roberts, Nate (D), Bannock County.....	29	41
332-1031 Rm: EG37		
Rubel, Ilana (D), Ada County.....	18	30
332-1034 Rm: E329		
Sauter, Mark (R), Bonner & Boundary Counties.....	1	13
332-1035 Rm: EG63		
Scott, Heather (R), Benewah, Clearwater, Koote.....	2	14
332-1190 Rm: E134		
Shepherd, Charlie (R), Adams, Idaho, Nez Perce.....	7	19
332-1067 Rm: E113		
Skaug, Bruce D. (R), Ada & Canyon Counties.....	10	22
332-1178 Rm: EW56		
Tanner, Josh (R), GEM & Ada Counties.....	14	26
332-1057 Rm: E135A		
Vander Woude, John (R), Ada County.....	22	34
332-1037 Rm: EW14		
Weber, Jon O. (R), Madison County.....	34	46
332-1053 Rm: EW12		
Wheeler, Josh (R), Bannock, Bear Lake, Bonne.....	35	47
332-1179 Rm: EG62		
Wisniewski, Tony (R), Kootenai County.....	5	17
332-1060 Rm: E142		
Wroten, Kenny (R), Canyon County.....	13	25
332-1063 Rm: EG51		
Yamamoto, Julie (R), Canyon County.....	11	23
332-1052 Rm: EW58		
Young, Julianne (R), Bingham & Butte Counties.....	30	42
332-1038 Rm: E103		

DISTRICT 1

(All area codes are 208 unless otherwise noted)

BONNER & BOUNDARY COUNTIES**Scott Herndon (R) - Senate**1st Term**Address:** 246 Otts Road, Sagle 83860**Phone:** (o) 332-1349 (Session Only)

(h) 610-2680

E-mail: SHerndon@senate.idaho.gov

Homebuilder

Wife - Arlene Herndon

Committees: Education; Finance**Mark Sauter (R) - House Seat A**1st Term**Address:** PO Box 1031, Sandpoint 83864**Phone:** (o) 332-1035 (Session Only)

(h) 332-1035

E-mail: MSauter@house.idaho.gov

Fire Service (Retired)

Committees: Agricultural Affairs;

Education; Judiciary, Rules &

Administration

**Sage G. Dixon (R) - House Seat B**5th Term**Assistant Majority Leader****Address:** PO Box 206, Ponderay 83852**Phone:** (o) 332-1185 (Session Only)

(h) 610-4800

E-mail: SDixon@house.idaho.gov

Self-employed

Wife - Veronica

Committees: Business; Revenue &

Taxation; Transportation & Defense; Ways

& Means

DISTRICT 2

(All area codes are 208 unless otherwise noted)

BENEWAH, CLEARWATER, KOOTENAI, SHOSHONE, BONNER COUNTIES



Phil Hart (R) - Senate

1st Term

(Served 4 terms, House 2004-2012)

Address: PO Box 540, Kellogg 83837

Phone: (o) 332-1345 (Session Only)

(h) 772-2522 (b) 772-2522

(f) 772-1881

E-mail: Phil.Hart@senate.idaho.gov

Structural Engineer

Committees: Agricultural Affairs; Judiciary
& Rules; Transportation



Heather Scott (R) - House Seat A

5th Term

Address: PO Box 134, Blanchard 83804

Phone: (o) 332-1190 (Session Only)

(h) 332-1190

E-mail: HScott@house.idaho.gov

Aquatic Biologist

Husband - Andrew

Committees: VICE CHAIR-Judiciary, Rules
& Administration; Environment, Energy &
Technology; State Affairs



Dale R. Hawkins (R) - House Seat B

1st Term

Address: PO Box 245, Fernwood 83830

Phone: (o) 332-1070 (Session Only)

(h) 568-1275

E-mail: DHawkins@house.idaho.gov

Small Business Owner/Retired

Wife - Debra Hawkins

Committees: Commerce & Human
Resources; Education; Local Government

DISTRICT 3
KOOTENAI COUNTY

(All area codes are 208 unless otherwise noted)



Doug Okuniewicz (R) - Senate

1st Term

(Served 1 term, House 2020-2022)

Address: PO Box 810, Hayden 83835

Phone: (o) 332-1338 (Session Only)
(h) 918-1495

E-mail: DougO@senate.idaho.gov

IP Management/Small Business Owner
Wife - Lori

Committees: CHAIR-Transportation;
Resources & Environment



Vito Barbieri (R) - House Seat A

7th Term

Address: 564 E Prairie Ave,
Dalton Gardens 83815

Phone: (o) 332-1177 (Session Only)
(h) 620-0873

E-mail: VBar@house.idaho.gov

Attorney (Retired)
Wife - Joy

Committees: CHAIR-Environment, Energy
& Technology; Business; Ethics and House
Policy; State Affairs



Jordan Redman (R) - House Seat B

1st Term

Address: 1410 Lincoln Way,
Coeur d' Alene 83814

Phone: (o) 332-1180 (Session Only)
(h) 252-5070

E-mail: JRedman@house.idaho.gov

Business Owner
Wife - Amy

Committees: Business; Environment,
Energy & Technology; Health & Welfare

DISTRICT 4
KOOTENAI COUNTY

(All area codes are 208 unless otherwise noted)



Ben Toews (R) - Senate

1st Term

Address: 911 N 5th St,
Coeur d' Alene 83814

Phone: (o) 332-1322 (Session Only)
(h) 209-7791

E-mail: BToews@senate.idaho.gov
Entrepreneur

Wife - Elisha

Committees: VICE CHAIR-Education;
State Affairs; Transportation



Joe Alfieri (R) - House Seat A

1st Term

Address: 1200 East Skyline Dr,
Coeur d' Alene 83814

Phone: (o) 332-1065 (Session Only)
(h) 699-0021

E-mail: JAlfieri@house.idaho.gov
Wife - Caroline Alfieri

Committees: Judiciary, Rules &
Administration; Local Government; State
Affairs



Elaine Price (R) - House Seat B

1st Term

Address: 1107 E Sherman Ave,
Coeur d' Alene 83814

Phone: (o) 332-1048 (Session Only)
(h) 654-3228

E-mail: EPrice@house.idaho.gov
Small Business Owner
Husband - Richard Price

Committees: Commerce & Human
Resources; Education; Local Government

DISTRICT 5
KOOTENAI COUNTY

(All area codes are 208 unless otherwise noted)



Carl J. Bjerke (R) - Senate

1st Term

Address: 212 W Ironwood Dr,
Coeur d' Alene 83814

Phone: (o) 332-1421 (Session Only)
(h) 704-0925

E-mail: CBjerke@senate.idaho.gov
Deputy Chief SMFD (Retired)

Wife - Lesli Bjerke

Committees: VICE CHAIR-Finance; Health
& Welfare



Ron Mendive (R) - House Seat A

6th Term

Address: 3732 S Dusty Ln,
Coeur d'Alene 83814

Phone: (o) 332-1040 (Session Only)
(h) 667-9330

E-mail: RMendive@house.idaho.gov
Self-employed, Construction and Land
Services (Semi-retired)

Wife - Sherlene

Committees: CHAIR-Resources &
Conservation; Education



Tony Wisniewski (R) - House Seat B

3rd Term

Address: PO Box 2483, Post Falls 83854

Phone: (o) 332-1060 (Session Only)
(h) 889-3437

E-mail: TWisniewski@house.idaho.gov
Engineer (Retired)/Small Business Owner
Wife - Melody

Committees: Commerce & Human
Resources; Education; Environment,
Energy & Technology

DISTRICT 6

(All area codes are 208 unless otherwise noted)

LATAH, LEWIS, NEZ PERCE COUNTIES**Daniel D. Foreman (R) - Senate**1st Term

(Served 1 term, Senate 2016-2018)

Address: PO Box 8254, Moscow 83843**Phone:** (o) 332-1405 (Session Only)

(h) 332-1405

E-mail: DForeman@senate.idaho.govUSAF Colonel/Idaho Law Enforcement
(Retired)

Wife - Maria

Committees: VICE CHAIR-Judiciary &
Rules; Agricultural Affairs; Commerce &
Human Resources**Lori McCann (R) - House Seat A**2nd Term**Address:** 1027 Bryden Avenue,
Lewiston 83501**Phone:** (o) 332-1184 (Session Only)

(h) 743-5517 (b) 743-5517

E-mail: LMcCann@house.idaho.govBusiness Owner, Cattle Rancher, and
Property Developer

Husband - William Vern McCann, Jr.

Committees: VICE CHAIR-Education;
Agricultural Affairs; Commerce & Human
Resources**Brandon Mitchell (R) - House Seat B**2nd Term**Address:** PO Box 8897, Moscow 83843**Phone:** (o) 332-1175 (Session Only)

(h) 596-5001

E-mail: BMitchell@house.idaho.gov

Small Business Owner

Wife - Marcie

Committees: VICE CHAIR-Transportation
& Defense; Business; Health & Welfare

DISTRICT 7

(All area codes are 208 unless otherwise noted)

ADAMS, IDAHO, NEZ PERCE COUNTIES

Cindy J. Carlson (R) - Senate

1st Term

Address: 1525 Big Salmon Rd,
Riggins 83549

Phone: (o) 332-1355 (Session Only)
(h) 494-2633

E-mail: CCarlson@senate.idaho.gov
Business Owner

Husband - Guy Carlson

Committees: Agricultural Affairs;
Education; Transportation



Mike Kingsley (R) - House Seat A

4th Term

Address: 3413 Bluebird Cir,
Lewiston 83501

Phone: (o) 332-1133 (Session Only)
(h) 791-8600

E-mail: MKingsley@house.idaho.gov
Semi-retired

Wife - Carolyn

Committees: VICE CHAIR-Local
Government; Commerce & Human
Resources; Health & Welfare



Charlie Shepherd (R) - House Seat B

2nd Term

Address: PO Box 293, Pollock 83547

Phone: (o) 332-1067 (Session Only)
(h) 859-0023

E-mail: CShepherd@house.idaho.gov
SRJSD243 Maintenance Supervisor

Wife - Susan

Committees: VICE CHAIR-Resources &
Conservation; Revenue & Taxation;
Transportation & Defense



DISTRICT 8

(All area codes are 208 unless otherwise noted)

BOISE, VALLEY, ELMORE, CUSTER COUNTIES

Geoff Schroeder (R) - Senate

1st Term

Address: 300 S 10th E,
Mountain Home 83647

Phone: (o) 332-1344 (Session Only)
(h) 332-1344

E-mail: GSchroeder@senate.idaho.gov
City Attorney and Prosecutor
Wife - Kenda

Committees: VICE CHAIR-Local
Government & Taxation; Agricultural Affairs;
Resources & Environment



Matthew "Matt" Bundy (R) - House Seat A

2nd Term

Address: 1735 Castle Way,
Mountain Home 83647

Phone: (o) 332-1181 (Session Only)
(h) 599-2379

E-mail: MBundy@house.idaho.gov
Teacher/Retired USAF
Wife - Colette

Committees: VICE CHAIR-Commerce &
Human Resources; Appropriations;
Environment, Energy & Technology; Ethics
and House Policy



Megan Blanksma (R) - House Seat B

4th Term

Majority Leader

Address: 595 S Thacker Rd,
Hammett 83627

Phone: (o) 332-1054 (Session Only)
(h) 366-7976

E-mail: MBlanksma@house.idaho.gov
Agribusiness Owner/Operator
Husband - Jeffery

Committees: Health & Welfare; Resources
& Conservation; Transportation & Defense;
Ways & Means



DISTRICT 9

(All area codes are 208 unless otherwise noted)

PAYETTE, WASHINGTON, CANYON COUNTIES



Abby Lee (R) - Senate

5th Term

Assistant Majority Leader

Address: 5370 Elmore Rd,
Fruitland 83619

Phone: (o) 332-1325 (Session Only)
(h) 332-1325

E-mail: ALee@senate.idaho.gov
Public Relations

Committees: Health & Welfare; Judiciary &
Rules; State Affairs



Jacyn Gallagher (R) - House Seat A

1st Term

Address: 827 Pringle Road,
Weiser 83672

Phone: (o) 332-1166 (Session Only)
(h) 960-0051

E-mail: JGallagher@house.idaho.gov
Retired

Husband - Bob

Committees: Agricultural Affairs; Health &
Welfare; Judiciary, Rules & Administration



Judy Boyle (R) - House Seat B

8th Term

Address: PO Box 57, Midvale 83645

Phone: (o) 332-1064 (Session Only)
(h) 355-3225 (b) 355-3225
(f) 355-3225

E-mail: JBoyle@house.idaho.gov
Agriculture and Writer

Committees: Agricultural Affairs;
Education; Resources & Conservation

DISTRICT 10

(All area codes are 208 unless otherwise noted)

ADA & CANYON COUNTIES



Tammy Nichols (R) - Senate

1st Term

(Served 2 terms, House 2018-2022)

Address: 10 S Hawthorne Dr #651,
Middleton 83644

Phone: (o) 332-1423 (Session Only)
(h) 917-2409

E-mail: TNichols@senate.idaho.gov
Small Business Owner

Committees: VICE CHAIR-Agricultural
Affairs; Education



Mike Moyle (R) - House Seat A

13th Term

Speaker of the House

Address: 480 N Plummer Rd, Star 83669

Phone: (o) 332-1122 (Session Only)
(b) 286-7842

E-mail: MMoyle@house.idaho.gov
Agribusiness

Wife - Janet



Bruce D. Skaug (R) - House Seat B

2nd Term

Address: 1226 E Karcher Rd,
Nampa 83687

Phone: (o) 332-1178 (Session Only)
(h) 466-0030

E-mail: BSkaug@house.idaho.gov
Attorney

Wife - Debra

Committees: CHAIR-Judiciary, Rules &
Administration; Local Government; State
Affairs

**DISTRICT 11
CANYON COUNTY**

(All area codes are 208 unless otherwise noted)



Chris T. Trakel (R) - Senate

1st Term

Address: PO Box 315, Caldwell 83606

Phone: (o) 332-1320 (Session Only)
(h) (986) 210-7653

E-mail: CTrakel@senate.idaho.gov

U.S. Marine Corps (Retired)

Wife - Nicole Trakel

Committees: Local Government &
Taxation; Transportation



Julie Yamamoto (R) - House Seat A

2nd Term

Address: 2619 S Willow Brook Pl,
Caldwell 83605

Phone: (o) 332-1052 (Session Only)
(h) 989-4487

E-mail: JYamamoto@house.idaho.gov

Retired Educator/Administrator

Husband - Leland Sasaki

Committees: CHAIR-Education;
Resources & Conservation; Transportation
& Defense



**Christopher M. "Chris" Allgood (R) -
House Seat B**

1st Term

Address: 1322 Wilson St, Caldwell 83605

Phone: (o) 332-1044 (Session Only)
(h) 249-0876

E-mail: CAllgood@house.idaho.gov

Private Investigator/City

Councilman/Retired Police Officer

Wife - Alisha

Committees: Environment, Energy &
Technology; Judiciary, Rules &
Administration; State Affairs

**DISTRICT 12
CANYON COUNTY**

(All area codes are 208 unless otherwise noted)



Ben Adams (R) - Senate

1st Term

(Served 1 term, House 2020-2022)

Address: 1921 Hoover St, Nampa 83686

Phone: (o) 332-1336 (Session Only)
(h) 546-9393

E-mail: BAdams@senate.idaho.gov

Public Speaker

Wife - Rebecca

Committees: VICE CHAIR-Resources & Environment; Finance; Local Government & Taxation



Jeff J. Cornilles (R) - House Seat A

1st Term

Address: 1313 W Raelin Drive,
Nampa 83686

Phone: (o) 332-1033 (Session Only)
(h) 880-3562 (b) 880-3562

E-mail: JCornilles@house.idaho.gov

Life and Employee Benefits Sales

Wife - Kerriann Cornilles

Committees: Business; Local Government; Revenue & Taxation



Jaron Crane (R) - House Seat B

1st Term

Address: PO Box 1804, Nampa 83653

Phone: (o) 332-1059 (Session Only)
(h) 466-0613

E-mail: JCrane@house.idaho.gov

Business Owner

Wife - Clarissa J. Crane

Committees: Business; State Affairs; Transportation & Defense

**DISTRICT 13
CANYON COUNTY**

(All area codes are 208 unless otherwise noted)



Brian Lenney (R) - Senate

1st Term

Address: PO Box 3753,
Nampa 83653-3753

Phone: (o) 332-1329 (Session Only)
(h) 614-1289

E-mail: BLenney@senate.idaho.gov

Committees: VICE CHAIR-Commerce &
Human Resources; Education



Brent J. Crane (R) - House Seat A

9th Term

Address: PO Box 86, Nampa 83653

Phone: (o) 332-1058 (Session Only)
(b) 466-0613

E-mail: BCrane@house.idaho.gov

Vice President - Crane Alarm Service
Wife - Rochenda

Committees: CHAIR-Ethics and House
Policy; CHAIR-State Affairs; Business



Kenny Wroten (R) - House Seat B

1st Term

Address: PO Box 3324, Nampa 83653

Phone: (o) 332-1063 (Session Only)
(h) 989-8292

E-mail: KWroten@house.idaho.gov

Banking/Business Development
Wife - Diane Wroten

Committees: Judiciary, Rules &
Administration; Local Government;
Revenue & Taxation

DISTRICT 14

(All area codes are 208 unless otherwise noted)

GEM & ADA COUNTIES



C. Scott Grow (R) - Senate

4th Term

Address: 4250 W Sugarberry Ct,
Eagle 83616

Phone: (o) 332-1334 (Session Only)
(h) 870-4000

E-mail: SGrow@senate.idaho.gov
Retired CPA/Business Owner

Wife - Rhonda

Committees: CHAIR-Finance; Local
Government & Taxation



Edward H. "Ted" Hill (R) - House Seat A

1st Term

Address: 2488 E Windrose Street,
Eagle 83616

Phone: (o) 332-1124 (Session Only)
(h) 407-2102

E-mail: THill@house.idaho.gov

Airline Pilot

Wife - Heidi Hill

Committees: Education; Resources &
Conservation; Transportation & Defense



Josh Tanner (R) - House Seat B

1st Term

Address: PO BOX 125, Eagle 83616

Phone: (o) 332-1057 (Session Only)
(h) 781-5211

E-mail: JTanner@house.idaho.gov
Business Owner

Wife - Dominique Tanner

Committees: Appropriations; Resources &
Conservation

**DISTRICT 15
ADA COUNTY**

(All area codes are 208 unless otherwise noted)



James R. "Rick" Just (D) - Senate

1st Term

Address: 11544 W Jenilyn Court,
Boise 83713

Phone: (o) 332-1407 (Session Only)
(h) 362-9892 (b) 362-9892

E-mail: RJust@senate.idaho.gov
Writer

Wife - Rinda Just

Committees: Finance; Local Government
& Taxation; Transportation



Steve Berch (D) - House Seat A

3rd Term

Address: PO Box 4903, Boise 83711

Phone: (o) 332-1039 (Session Only)
(h) 890-9339

E-mail: SBerch@house.idaho.gov
Businessman

Committees: Business; Education; Local
Government



Dori Healey (R) - House Seat B

1st Term

Address: 12404 W View Ridge Street,
Boise 83709

Phone: (o) 332-1176 (Session Only)
(h) 718-0464

E-mail: DHealey@house.idaho.gov
Advanced Practice Registered Nurse
Husband - Patrick Healey

Committees: Commerce & Human
Resources; Health & Welfare; Local
Government

**DISTRICT 16
ADA COUNTY**

(All area codes are 208 unless otherwise noted)



Alison "Ali" Rabe (D) - Senate

1st Term

(Served 1 term, Senate 2020-2021)

Address: 6161 West Plantation Lane,
Boise 83703

Phone: (o) 332-1409 (Session Only)
(h) 283-4010

E-mail: ARabe@senate.idaho.gov

Executive Director - Jesse Tree

Husband - Riley Hickox

Committees: Local Government &
Taxation; Transportation



Soñia R. Galaviz (D) - House Seat A

1st Term

Address: PO Box 7096, Boise 83707

Phone: (o) 332-1083 (Session Only)
(h) 332-1083

E-mail: SGalaviz@house.idaho.gov

Educator

Committees: Education; Local
Government; Resources & Conservation



Colin Nash (D) - House Seat B

2nd Term

Address: 6833 W Russett St,
Boise 83704

Phone: (o) 332-1075 (Session Only)
(h) 546-9004

E-mail: CNash@house.idaho.gov

Attorney

Wife - Hailey

Committees: Agricultural Affairs;
Appropriations; Judiciary, Rules &
Administration

**DISTRICT 17
ADA COUNTY**

(All area codes are 208 unless otherwise noted)



Carrie Semmelroth (D) - Senate

2nd Term

Address: 4224 W Fairmont Street,
Boise 83706

Phone: (o) 332-1352 (Session Only)
(h) 332-1352

E-mail: CSemmelroth@senate.idaho.gov
Higher Education / Consulting
Partner - Graham Wright

Committees: Agricultural Affairs;
Education; Resources & Environment



John Gannon (D) - House Seat A

6th Term

(Served 1 term, House 1990-1992)

Address: 1104 S Johnson St, Boise 83705

Phone: (o) 332-1082 (Session Only)
(h) 343-1608 (b) 433-0629

E-mail: JGannon@house.idaho.gov
Attorney

Wife - Bev

Committees: Ethics and House Policy;
Judiciary, Rules & Administration; State
Affairs; Transportation & Defense



Sue Chew (D) - House Seat B

9th Term

Address: 3604 W. Kootenai St.,
Boise 83705

Phone: (o) 332-1049 (Session Only)
(h) 332-1049

E-mail: SChew@house.idaho.gov
Licensed Pharmacist

Committees: Commerce & Human
Resources; Environment, Energy &
Technology; Ethics and House Policy;
Health & Welfare

**DISTRICT 18
ADA COUNTY**

(All area codes are 208 unless otherwise noted)



Janie Ward-Engelking (D) - Senate

6th Term

(Served 1 term, House 2012-2013)

Minority Caucus Chair

Address: 3578 S Crosspoint Ave,
Boise 83706

Phone: (o) 332-1425 (Session Only)
(h) 861-6434

E-mail:

JWardEngelking@senate.idaho.gov

Teacher (Retired)

Husband - Kay Frank

Committees: Commerce & Human
Resources; Education; Finance



Ilana Rubel (D) - House Seat A

6th Term

Minority Leader

Address: 2750 Migratory Dr, Boise 83706

Phone: (o) 332-1034 (Session Only)
(h) 866-4776

E-mail: IRubel@house.idaho.gov

Attorney

Committees: Business; Environment,
Energy & Technology; Health & Welfare;
Ways & Means



Brooke Green (D) - House Seat B

3rd Term

Address: 4936 E Woodcutter Drive,
Boise 83706

Phone: (o) 332-1080 (Session Only)
(h) 332-1080

E-mail: BGreen@house.idaho.gov

Senior Transportation Planner

Husband - Jeremy Byington

Committees: Business; Ethics and House
Policy; Local Government; State Affairs

**DISTRICT 19
ADA COUNTY**

(All area codes are 208 unless otherwise noted)



Melissa Wintrow (D) - Senate

2nd Term

(Served 3 terms, House 2014-2020)

Minority Leader

Address: PO Box 83720,
Boise 83720-0081

Phone: (o) 332-1339 (Session Only)
(h) 332-1339

E-mail: MWintrow@senate.idaho.gov
Education

Committees: Health & Welfare; Judiciary &
Rules; State Affairs



Lauren Necochea (D) - House Seat A

3rd Term

Assistant Minority Leader

Address: PO Box 1634, Boise 83701

Phone: (o) 332-1078 (Session Only)
(h) 332-1078

E-mail: LNecochea@house.idaho.gov

Committees: Environment, Energy &
Technology; Resources & Conservation;
Revenue & Taxation; Ways & Means



Chris Mathias (D) - House Seat B

2nd Term

Address: PO Box 8753, Boise 83707

Phone: (o) 332-1076 (Session Only)
(h) 332-1076

E-mail: CMathias@house.idaho.gov
Self-employed

Wife - Katie

Committees: Agricultural Affairs;
Education; Ethics and House Policy;
Judiciary, Rules & Administration

**DISTRICT 20
ADA COUNTY**

(All area codes are 208 unless otherwise noted)



Chuck Winder (R) - Senate

8th Term

President Pro Tempore

Address: 5528 N Ebbetts Ave,
Boise 83713

Phone: (o) 332-1354 (Session Only)
(h) 332-1301

E-mail: CWinder@senate.idaho.gov
Businessman

Wife - Dianne

Committees: State Affairs; Transportation



Joe A. Palmer (R) - House Seat A

8th Term

Address: 1524 N Meridian Rd,
Meridian 83642

Phone: (o) 332-1062 (Session Only)
(h) 332-1062

E-mail: JPalmer@house.idaho.gov
Self-employed

Wife - Leslie

Committees: CHAIR-Transportation &
Defense; Business; State Affairs



James Holtzclaw (R) - House Seat B

6th Term

Address: 3720 N Heritage View Ave,
Meridian 83646

Phone: (o) 332-1041 (Session Only)
(h) 284-9542

E-mail: JHoltzclaw@house.idaho.gov
Real Estate Broker/Small Business Owner
Wife - Luisa Uribe

Committees: CHAIR-Commerce & Human
Resources; State Affairs; Transportation &
Defense

**DISTRICT 21
ADA COUNTY**

(All area codes are 208 unless otherwise noted)



Treg A. Bernt (R) - Senate

1st Term

Address: 531 S Tiburon Ave,
Meridian 83642

Phone: (o) 332-1331 (Session Only)
(h) 917-2883

E-mail: TBernt@senate.idaho.gov
Small Business Owner

Wife - Tiffanie Bernt

Committees: VICE CHAIR-State Affairs;
Local Government & Taxation



James Petzke (R) - House Seat A

1st Term

Address: 2628 S Afleet Ave,
Meridian 83642

Phone: (o) 332-1043 (Session Only)
(h) 450-5615

E-mail: JPetzke@house.idaho.gov
Business Owner

Committees: Appropriations; Business;
Transportation & Defense



Jeff Ehlers (R) - House Seat B

1st Term

Address: 3313 W Cherry Lane #1024 ,
Meridian 83642

Phone: (o) 332-1072 (Session Only)
(h) 278-2818

E-mail: JEhlers@house.idaho.gov
CFO/CPA/Small Business Owner

Wife - Karla

Committees: VICE CHAIR-Business;
Agricultural Affairs; Revenue & Taxation

**DISTRICT 22
ADA COUNTY**

(All area codes are 208 unless otherwise noted)



Lori Den Hartog (R) - Senate

5th Term

Address: PO Box 267, Meridian 83680

Phone: (o) 332-1340 (Session Only)
(h) 779-2022

E-mail: LDenHartog@senate.idaho.gov

Homemaker

Husband - Scott

Committees: VICE CHAIR-Transportation;
Education; Resources & Environment



John Vander Woude (R) - House Seat A

7th Term

(Served 1 term, House 2006-2008)

Address: 5311 Ridgewood Rd,
Nampa 83687

Phone: (o) 332-1037 (Session Only)
(h) 888-4210

E-mail: JVanderWoude@house.idaho.gov

Farmer

Wife - Judy

Committees: CHAIR-Health & Welfare;
Environment, Energy & Technology;
Resources & Conservation



Jason A. Monks (R) - House Seat B

6th Term

Address: 3865 S Black Cat Rd,
Meridian 83687

Phone: (o) 332-1036 (Session Only)
(h) 884-8684

E-mail: JMonks@house.idaho.gov

Small Business Owner

Wife - Shelley

Committees: CHAIR-Revenue & Taxation;
Transportation & Defense

DISTRICT 23

(All area codes are 208 unless otherwise noted)

OWYHEE, CANYON, ADA COUNTIES



Todd M. Lakey (R) - Senate

6th Term

Address: 12905 Venezia Ct,
Nampa 83651

Phone: (o) 332-1328 (Session Only)
(h) 908-4415 (b) 908-4415

E-mail: TLakey@senate.idaho.gov
Attorney

Wife - Jan

Committees: CHAIR-Judiciary & Rules;
Commerce & Human Resources



Melissa Durrant (R) - House Seat A

1st Term

Address: 4000 W Hubbard Road,
Kuna 83634

Phone: (o) 332-1055 (Session Only)
(h) 941-1963

E-mail: MDurrant@house.idaho.gov
Homemaker

Husband - Neil

Committees: Resources & Conservation;
Revenue & Taxation



Tina Lambert (R) - House Seat B

1st Term

Address: PO Box 1324, Caldwell 83606

Phone: (o) 332-1047 (Session Only)
(h) 504-8647

E-mail: TLambert@house.idaho.gov
Home Educator (Retired)

Husband - David Lambert

Committees: Appropriations; Environment,
Energy & Technology; Judiciary, Rules &
Administration

DISTRICT 24

(All area codes are 208 unless otherwise noted)

CAMAS, GOODING, TWIN FALLS COUNTIES



Glenneda Zuiderveld (R) - Senate

1st Term

Address: PO Box 3123,
Twin Falls 83303

Phone: (o) 332-1347 (Session Only)
(h) 280-0716

E-mail: GZuiderveld@senate.idaho.gov

Self-employed

Husband - Tom

Committees: VICE CHAIR-Health &
Welfare; Agricultural Affairs



Chenele Dixon (R) - House Seat A

1st Term

Address: 3430 Harvest Moon Drive,
Kimberly 83341

Phone: (o) 332-1024 (Session Only)
(h) 332-1024

E-mail: CDixon@house.idaho.gov

Educator and Realtor

Husband - Michael Dixon

Committees: Health & Welfare; Judiciary,
Rules & Administration; Local Government



Steve Miller (R) - House Seat B

1st Term

(Served 3 terms, House 2012-2018)

Address: 1208 E 200 N, Fairfield 83327

Phone: (o) 332-1061 (Session Only)
(h) 332-1061

E-mail: SMiller@house.idaho.gov

Farmer/Rancher

Wife - Cheryl

Committees: VICE CHAIR-Appropriations;
Commerce & Human Resources;
Transportation & Defense

TWIN FALLS COUNTY



Linda Wright Hartgen (R) - Senate

1st Term

(Served 2 terms, House 2018-2022)

Address: 1681 Wildflower Ln,
Twin Falls 83301

Phone: (o) 332-1318 (Session Only)
(h) 332-1318

E-mail: LHartgen@senate.idaho.gov
Trial Court Administrator (Retired)

Husband - Stephen

Committees: CHAIR-Agricultural Affairs;
Commerce & Human Resources; Judiciary
& Rules



Lance W. Clow (R) - House Seat A

6th Term

Address: 2170 Bitterroot Dr,
Twin Falls 83301

Phone: (o) 332-1188 (Session Only)
(h) 733-5767

E-mail: LClow@house.idaho.gov
Personal Financial Advisor (Retired)

Wife - DeeDee

Committees: CHAIR-Business; Education;
Local Government



Greg L. Lanting (R) - House Seat B

1st Term

Address: 355 Elm St N, Twin Falls 83301

Phone: (o) 332-1182 (Session Only)
(h) 490-3511

E-mail: GLanting@house.idaho.gov
School Administrator (Retired)

Significant Other - Dana DeHaan

Committees: Business; Education;
Transportation & Defense

DISTRICT 26

(All area codes are 208 unless otherwise noted)

BLAINE, LINCOLN, JEROME COUNTIES



Ron C. Taylor (D) - Senate

1st Term

Address: 419 South 2nd Ave,
Hailey 83333

Phone: (o) 332-1353 (Session Only)
(h) 831-1726

E-mail: RTaylor@senate.idaho.gov

Retired

Wife - Alex

Committees: Agricultural Affairs; Health &
Welfare; Resources & Environment



Ned Burns (D) - House Seat A

2nd Term

Minority Caucus Chair

Address: PO Box 693, Bellevue 83313

Phone: (o) 332-1174 (Session Only)
(h) 332-1174

E-mail: NBurns@house.idaho.gov

Realtor

Wife - Sara

Committees: Resources & Conservation;
Revenue & Taxation; Transportation &
Defense; Ways & Means



Jack Nelsen (R) - House Seat B

1st Term

Address: 253 E 650 N, Jerome 83338

Phone: (o) 332-1032 (Session Only)
(h) 320-1921

E-mail: JNelsen@house.idaho.gov

Retired

Wife - Emily

Committees: Agricultural Affairs;
Education; Resources & Conservation

DISTRICT 27

(All area codes are 208 unless otherwise noted)

CASSIA, MINIDOKA, ONEIDA COUNTIES



Kelly Arthur Anthon (R) - Senate

5th Term

Majority Leader

Address: 725 E 300 S, Burley 83318

Phone: (o) 332-1327 (Session Only)
(h) 654-4099

E-mail: KAnthon@senate.idaho.gov
Attorney/City Administrator

Wife - Joelle

Committees: Judiciary & Rules; State
Affairs



Douglas T. Pickett (R) - House Seat A

1st Term

Address: 625 W 1700 S, Oakley 83346

Phone: (o) 332-1123 (Session Only)
(h) 862-3387

E-mail: DPickett@house.idaho.gov
Rancher

Wife - Brady

Committees: Agricultural Affairs;
Resources & Conservation; Revenue &
Taxation



Clay Handy (R) - House Seat B

1st Term

Address: 29 S 150 E, Burley 83318

Phone: (o) 332-1074 (Session Only)
(h) 332-1074

E-mail: CHandy@house.idaho.gov
Wife - Kristine Hansen

Committees: Appropriations; Judiciary,
Rules & Administration; Transportation &
Defense

DISTRICT 28

(All area codes are 208 unless otherwise noted)

BANNOCK, FRANKLIN, POWER COUNTIES

Jim Guthrie (R) - Senate



6th Term

(Served 1 term, House 2010-2012)

Address: 320 S Marsh Creek Rd,
McCammon 83250

Phone: (o) 332-1348 (Session Only)
(h) 251-9303

E-mail: JGuthrie@senate.idaho.gov
Rancher/Business Owner

Committees: CHAIR-State Affairs;
Commerce & Human Resources;
Resources & Environment

**Richard W. "Rick" Cheatum (R) - House
Seat A**



1st Term

Address: 2475 Ada Street,
Pocatello 83201

Phone: (o) 332-1046 (Session Only)
(h) 339-2629

E-mail: RCheatum@house.idaho.gov
Retired

Wife - Debra L. Cheatum

Committees: Commerce & Human
Resources; Local Government; Revenue &
Taxation

Dan Garner (R) - House Seat B



1st Term

Address: PO Box 43, Clifton 83228

Phone: (o) 332-1081 (Session Only)
(h) 244-0999

E-mail: DGarner@house.idaho.gov
Farmer/Rancher

Wife - Sherri-Jo Garner

Committees: Agricultural Affairs;
Education; Judiciary, Rules &
Administration

DISTRICT 29
BANNOCK COUNTY

(All area codes are 208 unless otherwise noted)



James D. Ruchti (D) - Senate

1st Term

(Served 2 terms, House 2006-2010

Served 1 term, House 2020-2022)

Assistant Minority Leader

Address: 1490 Windsong Lane,
Pocatello 83201

E-mail: JRuchti@senate.idaho.gov

Attorney

Wife - Wendy

Committees: Commerce & Human
Resources; Judiciary & Rules; State Affairs



Dustin Manwaring (R) - House Seat A

2nd Term

(Served 1 term, House 2016-2018)

Majority Caucus Chair

Address: 1469 W Quinn Road,
Pocatello 83202

Phone: (o) 332-1079 (Session Only)
(h) 252-5295

E-mail: DManwaring@house.idaho.gov

Attorney

Wife - Whitney

Committees: Resources & Conservation;
Revenue & Taxation; Transportation &
Defense; Ways & Means



Nate Roberts (D) - House Seat B

1st Term

Address: PO Box 2173, Pocatello 83206

Phone: (o) 332-1031 (Session Only)
(h) 269-1230

E-mail: NRoberts@house.idaho.gov

Electrician

Wife - Kirsten

Committees: Agricultural Affairs;
Commerce & Human Resources; Health &
Welfare

DISTRICT 30

(All area codes are 208 unless otherwise noted)

BINGHAM & BUTTE COUNTIES**Julie VanOrden (R) - Senate**2nd Term

(Served 3 terms, House 2012-2018)

Address: 425 S 1100 W, Pingree 83262**Phone:** (o) 332-1346 (Session Only)

(h) 684-4052

E-mail: JVanOrden@senate.idaho.gov

Agribusiness Co-owner/Homemaker

Husband - Garth

Committees: CHAIR-Health & Welfare;
Finance**David M. Cannon (R) - House Seat A**2nd Term**Address:** 75 E Judicial St,

Blackfoot 83221

Phone: (o) 332-1086 (Session Only)

(h) 332-1086

E-mail: DCannon@house.idaho.gov

Attorney

Wife - Lisa

Committees: VICE CHAIR-Revenue &
Taxation; Agricultural Affairs; Judiciary,
Rules & Administration**Julianne Young (R) - House Seat B**3rd Term**Address:** 275 N 400 West,

Blackfoot 83221

Phone: (o) 332-1038 (Session Only)

(h) 201-1898

E-mail: JYoung@house.idaho.gov

Homemaker/Mother

Husband - Kevin

Committees: VICE CHAIR-State Affairs;
Environment, Energy & Technology; Ethics
and House Policy; Judiciary, Rules &
Administration

DISTRICT 31

(All area codes are 208 unless otherwise noted)

CLARK, FREMONT, JEFFERSON, LEMHI COUNTIES

Van T. Burtenshaw (R) - Senate

3rd Term

(Served 2 terms, House 2014-2018)

Address: PO Box 130, Terreton 83450

Phone: (o) 332-1342 (Session Only)

(h) 663-4607

E-mail: VBurtenshaw@senate.idaho.gov

Farmer/Rancher

Wife - Joan "Joni" Marie

Committees: CHAIR-Resources & Environment; Finance



Jerald Raymond (R) - House Seat A

1st Term

(Served 1 term, House 2018-2020)

Address: 3352 E 750 North, Menan 83434

Phone: (o) 332-1183 (Session Only)

(h) 317-8777

E-mail: JRaymond@house.idaho.gov

Rancher/Livestock Consultant

Wife - Cheri

Committees: VICE CHAIR-Agricultural Affairs; Resources & Conservation; Revenue & Taxation



Rod Furniss (R) - House Seat B

3rd Term

Address: 346 N 4456 East, Rigby 83442

Phone: (o) 332-1056 (Session Only)

(h) 589-1100

E-mail: RFurniss@house.idaho.gov

Insurance Sales/Land Developer

Wife - Jan

Committees: VICE CHAIR-Environment, Energy & Technology; Appropriations; Business



DISTRICT 32
BONNEVILLE COUNTY

(All area codes are 208 unless otherwise noted)



Kevin Cook (R) - Senate

2nd Term

Address: 1184 E Lazy Lane,
Idaho Falls 83404

Phone: (o) 332-1358 (Session Only)
(h) 521-6776

E-mail: KCook@senate.idaho.gov
Software Engineer

Wife - Cheri

Committees: CHAIR-Commerce & Human Resources; Finance; Local Government & Taxation



Stephanie Jo Mickelsen (R) - House Seat A

1st Term

Address: 9088 N River Rd,
Idaho Falls 83402

Phone: (o) 332-1042 (Session Only)
(h) 524-1295

E-mail: SMickelsen@house.idaho.gov
CFO Mickelsen Farms, LLC

Husband - Mark Mickelsen

Committees: Environment, Energy & Technology; Resources & Conservation; Revenue & Taxation



Wendy Horman (R) - House Seat B

6th Term

Address: 1860 Heather Circle,
Idaho Falls 83406

Phone: (o) 332-1071 (Session Only)
(h) 522-4387

E-mail: WendyHorman@house.idaho.gov
Small Business Owner

Husband - Briggs

Committees: CHAIR-Appropriations; Commerce & Human Resources; Environment, Energy & Technology

DISTRICT 33
BONNEVILLE COUNTY

(All area codes are 208 unless otherwise noted)



Dave Lent (R) - Senate

3rd Term

Address: 1186 Caysie Cir,
Idaho Falls 83402

Phone: (o) 332-1313 (Session Only)
(h) 521-0716

E-mail: DLent@senate.idaho.gov
Nuclear Facility Training Manager (Retired)
Wife - Terri

Committees: CHAIR-Education; Finance



Barbara Ehardt (R) - House Seat A

4th Term

Address: 961 J St, Idaho Falls 83402

Phone: (o) 332-1189 (Session Only)
(h) 332-1189

E-mail: BEhardt@house.idaho.gov
Manager - Athletic Club

Committees: CHAIR-Local Government;
Education; Judiciary, Rules &
Administration



Marco Adam Erickson (R) - House Seat B

2nd Term

Address: 646 Crestview Ave,
Idaho Falls 83402

Phone: (o) 332-1073 (Session Only)
(h) 241-5665

E-mail: MErickson@house.idaho.gov
Coalition Program Director
Wife - Emily

Committees: VICE CHAIR-Health &
Welfare; Judiciary, Rules & Administration;
Local Government

DISTRICT 34
MADISON COUNTY

(All area codes are 208 unless otherwise noted)



Doug Ricks (R) - Senate

2nd Term

(Served 1 term, House 2018-2020)

Address: 140 S 3rd East, Rexburg 83440

Phone: (o) 332-1301 (Session Only)
(h) 557-9665

E-mail: DRicks@senate.idaho.gov

Self-employed

Wife - Melissa

Committees: CHAIR-Local Government & Taxation; Commerce & Human Resources; Judiciary & Rules



Jon O. Weber (R) - House Seat A

2nd Term

Address: 64 E Main St, Rexburg 83440

Phone: (o) 332-1053 (Session Only)
(h) 390-6128

E-mail: JWeber@house.idaho.gov

Small Business Owner

Wife - Heather

Committees: CHAIR-Ways & Means; Commerce & Human Resources; Local Government; Revenue & Taxation



Britt Raybould (R) - House Seat B

1st Term

(Served 1 term, House 2018-2020)

Address: PO Box 653, Rexburg 83440

Phone: (o) 332-1173 (Session Only)
(h) 419-0768 (b) 419-0768

E-mail: BRaybould@house.idaho.gov

Farmer/CFO/Business Strats

Committees: Appropriations; Environment, Energy & Technology; Ethics and House Policy; Resources & Conservation

DISTRICT 35

(All area codes are 208 unless otherwise noted)

**BANNOCK, BEAR LAKE, BONNEVILLE, CARIBOU,
TETON COUNTIES**



Mark Harris (R) - Senate

5th Term

Majority Caucus Chair

Address: 1619 8- Mile Creek Rd,
Soda Springs 83276

Phone: (o) 332-1429 (Session Only)
(h) 547-3360

E-mail: MHarris@senate.idaho.gov
Rancher

Wife - Cheryl

Committees: Health & Welfare; Resources
& Environment; State Affairs



Kevin Andrus (R) - House Seat A

3rd Term

Address: 6948 E Old Oregon Trail Rd,
Lava Hot Springs 83246

Phone: (o) 332-1045 (Session Only)
(h) 240-0201

E-mail: KAndrus@house.idaho.gov
Rancher/Horse Trainer

Wife - Shelby

Committees: CHAIR-Agricultural Affairs;
Business; State Affairs



Josh Wheeler (R) - House Seat B

1st Term

Address: 1849 S Foothill Rd,
Ammon 83401

Phone: (o) 332-1179 (Session Only)
(h) 360-3926

E-mail: JoshWheeler@house.idaho.gov
Contractor

Wife - Laramie Linning Wheeler

Committees: Commerce & Human
Resources; Environment, Energy &
Technology; Health & Welfare

CENTRAL GARDEN LEVEL

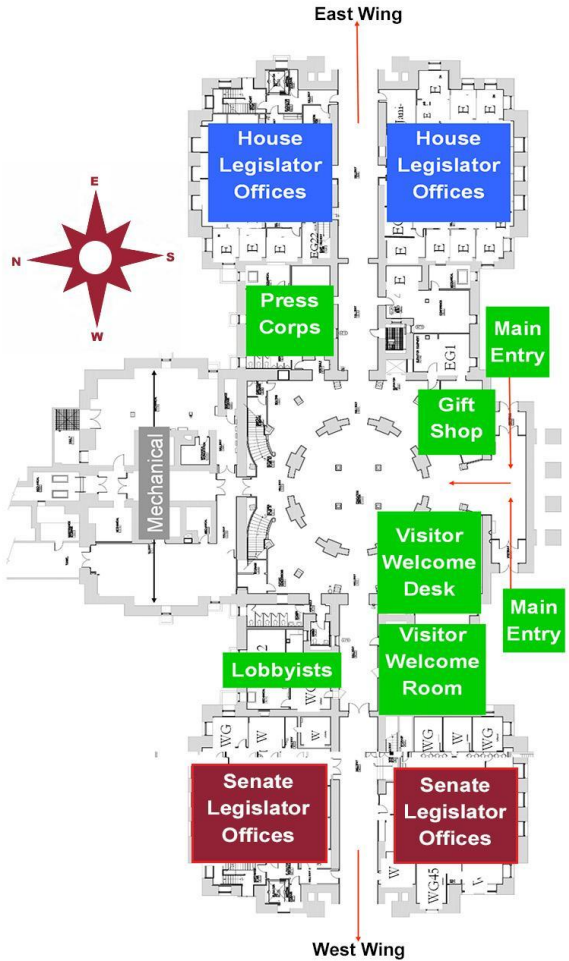

SENATE WEST WING

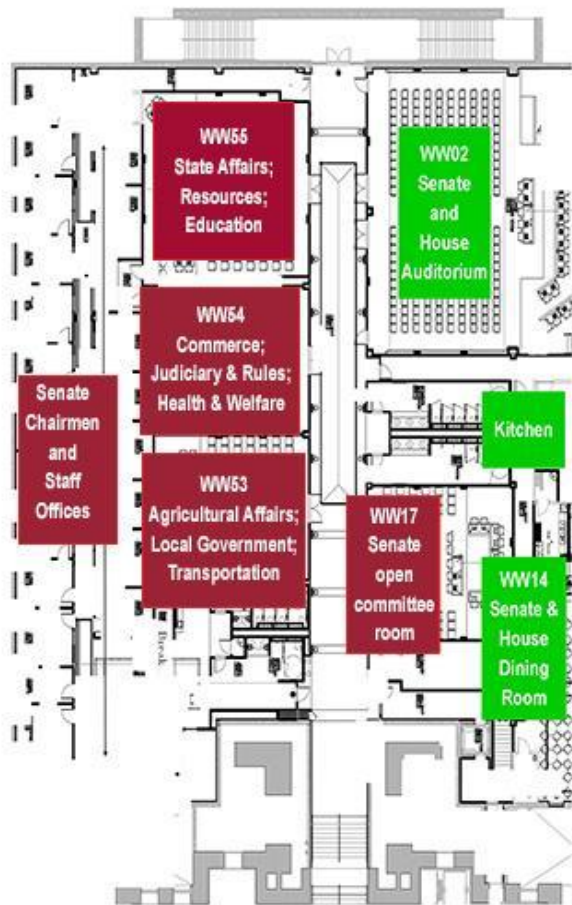

HOUSE EAST WING

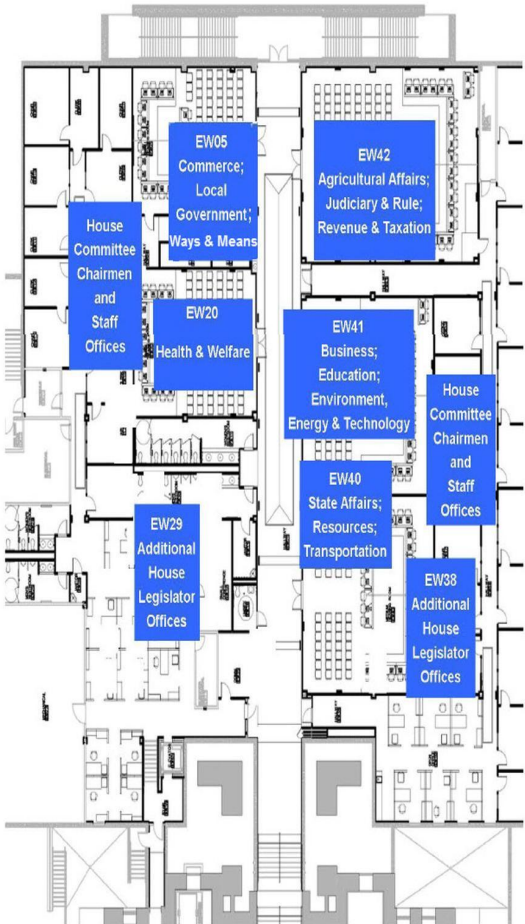

FIRST FLOOR

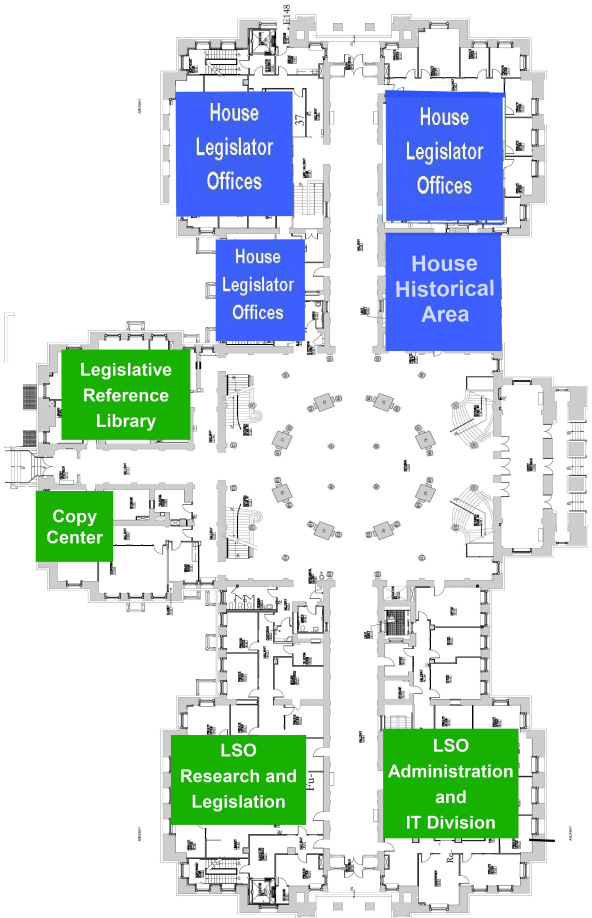

SECOND FLOOR

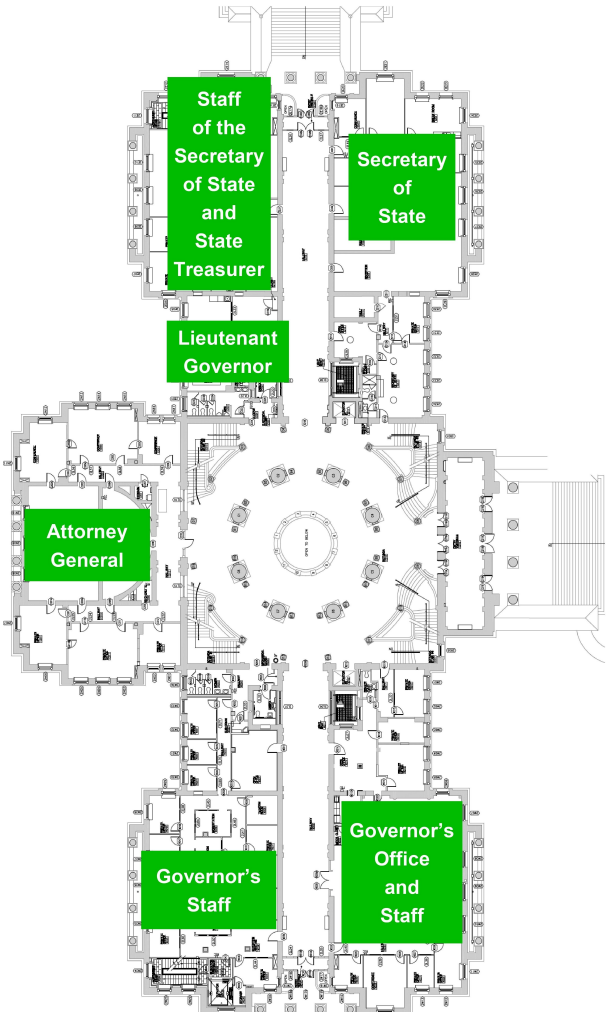

FOURTH FLOOR

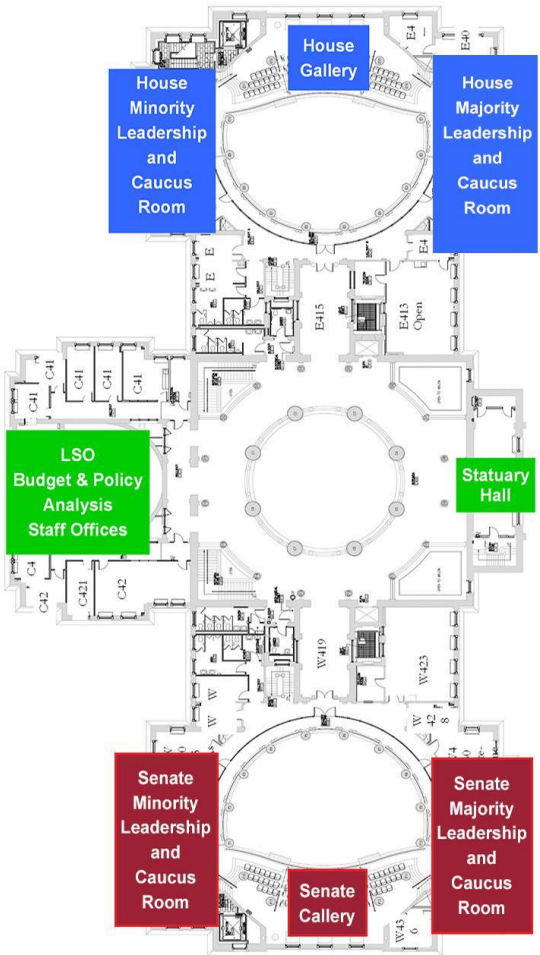

(All area codes are 208 unless otherwise noted)

SENATE COMMITTEES	Meeting Room - Day - Time
Agricultural Affairs Secretary: Melissa Price, Ph: 332-1330	Rm WW53 - T, Th - 8:00 am
Commerce & Human Resources Secretary: Linda Kambeitz, Ph: 332-1333	Rm WW54 - T, Th - 1:30 pm
Education Secretary: Linette Grantham, Ph: 332-1321	Rm WW55 - M, T, W, Th - 3:00 pm
Finance Secretary: Erin Miller, Ph: 334-4735	Rm C310 - Daily - 8:00 am
Health & Welfare Secretary: Michelle Tierney, Ph: 332-1319	Rm WW54 - M, T, W, Th - 3:00 pm
Judiciary & Rules Secretary: Sharon Pennington, Ph: 332-1317	Rm WW54 - M, W, F - 1:30 pm
Local Government & Taxation Secretary: Meg Lawless, Ph: 332-1315	Rm WW53 - T, W, Th - 3:00 pm
Resources & Environment Secretary: Shelly Johnson, Ph: 332-1323	Rm WW55 - M, W, F - 1:30 pm
State Affairs Secretary: Joyce Brewer, Ph: 332-1326	Rm WW55 - M, W, F - 8:00 am
Transportation Secretary: Lena Amoah, Ph: 332-1332	Rm WW53 - T, Th - 1:30 pm
HOUSE COMMITTEES	Meeting Room - Day - Time
Agricultural Affairs Secretary: Jayne Feik, Ph: 332-1137	Rm EW42 - Even Days - 1:30 pm
Appropriations Secretary: Alyson Jackson, Ph: 334-4736	Rm C310 - Daily - am
Business Secretary: Michelle Anderson, Ph: 332-1139	Rm EW41 - Odd Days - 1:30 pm
Commerce & Human Resources Secretary: Jeremy Collier, Ph: 332-1149	Rm EW05 - Odd Days - 1:30 pm
Education Secretary: Amy Bengtzen, Ph: 332-1148	Rm EW41 - Daily - 9:00 am
Environment, Energy & Technology Secretary: Jeremy Collier, Ph: 332-1128	Rm EW41 - Even Days - 1:30 pm
Health & Welfare Secretary: Irene Moore, Ph: 332-1138	Rm EW20 - Daily - 9:00 am
Judiciary, Rules & Administration Secretary: Nancy Conrad, Ph: 332-1127	Rm EW42 - Odd Days - 1:30 pm
Local Government Secretary: Elijah Phipps, Ph: 332-1147	Rm EW05 - Even Days - 1:30 pm
Resources & Conservation Secretary: Cameron Douglas, Ph: 332-1136	Rm EW40 - Odd Days - 1:30 pm
Revenue & Taxation Secretary: Jocelyn Lamb, Ph: 332-1125	Rm EW42 - Daily - 9:00 am
State Affairs Secretary: Lisa Hendricks, Ph: 332-1145	Rm EW40 - Daily - 9:00 am
Transportation & Defense Secretary: Tracey McDonnell, Ph: 332-1146	Rm EW40 - Even Days - 1:30 pm
Ways & Means Secretary: Wendy Carver-Herbert, Ph: 332-1159	Rm EW05 - On Call - pm

(All area codes are 208 unless otherwise noted)

SENATE COMMITTEES

AGRICULTURAL AFFAIRS Meeting Room WW53
(9) T, Th 8:00 am
sagri@senate.idaho.gov Capitol Mall Cable Ch. 5.2

LINDA HARTGEN, Chairman

TAMMY NICHOLS, Vice Chairman

Daniel Foreman

Carrie Semmelroth

Phil Hart

Ron Taylor

Geoff Schroeder

Cindy Carlson

Glenneda Zuiderveld

Secretary: Melissa Price

Rm WW31, Ph: 332-1330

COMMERCE & HUMAN Meeting Room WW54
RESOURCES (9) T, Th 1:30 pm
scom@senate.idaho.gov Capitol Mall Cable Ch. 5.3

KEVIN COOK, Chairman

BRIAN LENNEY, Vice Chairman

Todd Lakey

Janie Ward-Engelking

Jim Guthrie

James Ruchti

Doug Ricks

Daniel Foreman

Linda Hartgen

Secretary: Linda Kambeitz

Rm WW46, Ph: 332-1333

EDUCATION (9) Meeting Room WW55
M, T, W, Th 3:00 pm
sedu@senate.idaho.gov Capitol Mall Cable Ch. 6.1

DAVE LENT, Chairman

BEN TOEWS, Vice Chairman

Lori Den Hartog

Janie Ward-Engelking

Tammy Nichols

Carrie Semmelroth

Cindy Carlson

Scott Herndon

Brian Lenney

Secretary: Linette Grantham

Rm WW39, Ph: 332-1321

FINANCE (10)

Meeting Room C310

Daily 8:00 am

sfin@senate.idaho.gov

Capitol Mall Cable Ch. 3.3

C. SCOTT GROW, Chairman

CARL BJERKE, Vice Chairman

Van Burtenshaw

Janie Ward-Engelking

Dave Lent

Rick Just

Kevin Cook

Julie VanOrden

Ben Adams

Scott Herndon

Secretary: Erin Miller

Rm C305, Ph: 334-4735

HEALTH & WELFARE (7)

Meeting Room WW54

M, T, W, Th 3:00 pm

shel@senate.idaho.gov

Capitol Mall Cable Ch. 5.3

JULIE VANORDEN, Chairman

GLENNEDA ZUIDERVELD, Vice Chairman

Abby Lee

Melissa Wintrow

Mark Harris

Ron Taylor

Carl Bjerke

Secretary: Michelle Tierney

Rm WW35, Ph: 332-1319

JUDICIARY & RULES (9)

Meeting Room WW54

M, W, F 1:30 pm

sjud@senate.idaho.gov

Capitol Mall Cable Ch. 5.3

TODD LAKEY, Chairman

DANIEL FOREMAN, Vice Chairman

Abby Lee

Melissa Wintrow

Kelly Anthon

James Ruchti

Doug Ricks

Phil Hart

Linda Hartgen

Secretary: Sharon Pennington

Rm WW48, Ph: 332-1317

LOCAL GOVERNMENT & TAXATION (9) Meeting Room WW53
T, W, Th 3:00 pm
sloc@senate.idaho.gov Capitol Mall Cable Ch. 5.2

DOUG RICKS, Chairman

GEOFF SCHROEDER, Vice Chairman

C. Scott Grow Ali Rabe
Kevin Cook Rick Just
Ben Adams
Treg Bernt
Chris Trakel
Secretary: Meg Lawless Rm WW50, Ph: 332-1315

RESOURCES & ENVIRONMENT (9) Meeting Room WW55
M, W, F 1:30 pm
sres@senate.idaho.gov Capitol Mall Cable Ch. 6.1

VAN BURTENSHAW, Chairman

BEN ADAMS, Vice Chairman

Jim Guthrie Carrie Semmelroth
Lori Den Hartog Ron Taylor
Mark Harris
Doug Okuniewicz
Geoff Schroeder
Secretary: Shelly Johnson Rm WW37, Ph: 332-1323

STATE AFFAIRS (9) Meeting Room WW55
M, W, F 8:00 am
sstaf@senate.idaho.gov Capitol Mall Cable Ch. 6.1

JIM GUTHRIE, Chairman

TREG BERNT, Vice Chairman

Chuck Winder Melissa Wintrow
Kelly Anthon James Ruchti
Mark Harris
Abby Lee
Ben Toews
Secretary: Joyce Brewer Rm WW42, Ph: 332-1326

(All area codes are 208 unless otherwise noted)

TRANSPORTATION (9)

Meeting Room WW53

T, Th 1:30 pm

stran@senate.idaho.gov

Capitol Mall Cable Ch. 5.2

DOUG OKUNIEWICZ, Chairman

LORI DEN HARTOG, Vice Chairman

Chuck Winder

Ali Rabe

Phil Hart

Rick Just

Cindy Carlson

Ben Toews

Chris Trakel

Secretary: Lena Amoah

Rm WW33, Ph: 332-1332

(All area codes are 208 unless otherwise noted)

HOUSE COMMITTEES

AGRICULTURAL AFFAIRS (14) Meeting Room EW42
Even Days 1:30 pm
hagri@house.idaho.gov Capitol Mall Cable Ch. 4.2

KEVIN ANDRUS, Chairman

JERALD RAYMOND, Vice Chairman

Judy Boyle

Chris Mathias

David Cannon

Colin Nash

Lori McCann

Nate Roberts

Jeff Ehlers

Jacyn Gallagher

Dan Garner

Jack Nelsen

Douglas Pickett

Mark Sauter

Secretary: Jayne Feik

Rm EW11, Ph: 332-1137

APPROPRIATIONS (10) Meeting Room C310
Daily am
happ@house.idaho.gov Capitol Mall Cable Ch. 3.3

WENDY HORMAN, Chairman

STEVE MILLER, Vice Chairman

Matt Bundy

Colin Nash

Britt Raybould

Rod Furniss

Clay Handy

Tina Lambert

James Petzke

Josh Tanner

Secretary: Alyson Jackson

Rm C316, Ph: 334-4736

BUSINESS (17)

Meeting Room EW41

Odd Days 1:30 pm

hbus@house.idaho.gov Capitol Mall Cable Ch. 96.2

LANCE CLOW, Chairman

JEFF EHLERS, Vice Chairman

Brent Crane

Steve Berch

Joe Palmer

Brooke Green

Vito Barbieri

Ilana Rubel

Sage Dixon

Kevin Andrus

Rod Furniss

Brandon Mitchell

Jeff Cornilles

Jaron Crane

Greg Lanting

James Petzke

Jordan Redman

Secretary: Michelle Anderson

Rm EW49, Ph: 332-1139

**COMMERCE & HUMAN
RESOURCES (15)**

Meeting Room EW05

Odd Days 1:30 pm

hcom@house.idaho.gov Capitol Mall Cable Ch. 6.2

JAMES HOLTZCLAW, Chairman

MATT BUNDY, Vice Chairman

Mike Kingsley

Sue Chew

Tony Wisniewski

Nate Roberts

Wendy Horman

Jon Weber

Lori McCann

Rick Cheatum

Dale Hawkins

Dori Healey

Steve Miller

Elaine Price

Josh Wheeler

Secretary: Jeremy Collier

Rm EW08, Ph: 332-1149

EDUCATION (17)

Meeting Room EW41

Daily 9:00 am

hedu@house.idaho.gov Capitol Mall Cable Ch. 96.2

JULIE YAMAMOTO, Chairman

LORI MCCANN, Vice Chairman

Judy Boyle

Steve Berch

Lance Clow

Sofia Galaviz

Ron Mendive

Chris Mathias

Barbara Ehardt

Tony Wisniewski

Dan Garner

Dale Hawkins

Ted Hill

Greg Lanting

Jack Nelsen

Elaine Price

Mark Sauter

Secretary: Amy Bengtzen

Rm EW58, Ph: 332-1148

**ENVIRONMENT, ENERGY &
TECHNOLOGY (17)**

Meeting Room EW41

Even Days 1:30 pm

henv@house.idaho.gov Capitol Mall Cable Ch. 96.2

VITO BARBIERI, Chairman

ROD FURNISS, Vice Chairman

John Vander Woude

Sue Chew

Wendy Horman

Lauren Necochea

Heather Scott

Ilana Rubel

Julianne Young

Tony Wisniewski

Britt Raybould

Chris Allgood

Matt Bundy

Tina Lambert

Stephanie Mickelsen

Jordan Redman

Josh Wheeler

Secretary: Jeremy Collier

Rm EW08, Ph: 332-1128

HEALTH & WELFARE (13) Meeting Room EW20
Daily 9:00 am
hhel@house.idaho.gov Capitol Mall Cable Ch. 6.3

JOHN VANDER WOUDE, Chairman

MARCO ERICKSON, Vice Chairman

Megan Blanksma

Sue Chew

Mike Kingsley

Ilana Rubel

Brandon Mitchell

Nate Roberts

Chenele Dixon

Jacyn Gallagher

Dori Healey

Jordan Redman

Josh Wheeler

Secretary: Irene Moore

Rm EW14, Ph: 332-1138

JUDICIARY, RULES & ADMINISTRATION (18) Meeting Room EW42
Odd Days 1:30 pm
hjud@house.idaho.gov Capitol Mall Cable Ch. 4.2

BRUCE SKAUG, Chairman

HEATHER SCOTT, Vice Chairman

Barbara Ehardt

John Gannon

Julianne Young

Colin Nash

David Cannon

Chris Mathias

Marco Erickson

Joe Alfieri

Chris Allgood

Chenele Dixon

Jacyn Gallagher

Dan Garner

Clay Handy

Tina Lambert

Mark Sauter

Kenny Wroten

Secretary: Nancy Conrad

Rm EW56, Ph: 332-1127

LOCAL GOVERNMENT (17) Meeting Room EW05
Even Days 1:30 pm
hloc@house.idaho.gov Capitol Mall Cable Ch. 6.2

BARBARA EHARDT, Chairman

MIKE KINGSLEY, Vice Chairman

Lance Clow

Steve Berch

Marco Erickson

Brooke Green

Bruce Skaug

Sofia Galaviz

Jon Weber

Joe Alfieri

Rick Cheatum

Jeff Cornilles

Chenele Dixon

Dale Hawkins

Dori Healey

Elaine Price

Kenny Wroten

Secretary: Elijah Phipps

Rm EW16, Ph: 332-1147

**RESOURCES &
CONSERVATION (18)** Meeting Room EW40
Odd Days 1:30 pm
hres@house.idaho.gov Capitol Mall Cable Ch. 96.1

RON MENDIVE, Chairman

CHARLIE SHEPHERD, Vice Chairman

Judy Boyle

Ned Burns

John Vander Woude

Lauren Necochea

Megan Blanksma

Sofia Galaviz

Dustin Manwaring

Julie Yamamoto

Britt Raybould

Melissa Durrant

Ted Hill

Stephanie Mickelsen

Jack Nelsen

Douglas Pickett

Jerald Raymond

Josh Tanner

Secretary: Cameron Douglas

Rm EW62, Ph: 332-1136

REVENUE & TAXATION (16) Meeting Room EW42
Daily 9:00 am
hrev@house.idaho.gov Capitol Mall Cable Ch. 4.2

JASON MONKS, Chairman

DAVID CANNON, Vice Chairman

Sage Dixon
Dustin Manwaring
Jon Weber
Charlie Shepherd
Rick Cheatum
Jeff Cornilles
Melissa Durrant
Jeff Ehlers
Stephanie Mickelsen
Douglas Pickett
Jerald Raymond
Kenny Wroten
Secretary: Jocelyn Lamb

Lauren Necochea
Ned Burns

Rm EW54, Ph: 332-1125

STATE AFFAIRS (13) Meeting Room EW40
Daily 9:00 am
hstaf@house.idaho.gov Capitol Mall Cable Ch. 96.1

BRENT CRANE, Chairman

JULIANNE YOUNG, Vice Chairman

Joe Palmer
Vito Barbieri
James Holtzclaw
Heather Scott
Kevin Andrus
Bruce Skaug
Joe Alfieri
Chris Allgood
Jaron Crane
Secretary: Lisa Hendricks

John Gannon
Brooke Green

Rm EW46, Ph: 332-1145

(All area codes are 208 unless otherwise noted)

**TRANSPORTATION &
DEFENSE (17)**

htran@house.idaho.gov

Meeting Room EW40

Even Days 1:30 pm

Capitol Mall Cable Ch. 96.1

JOE PALMER, Chairman

BRANDON MITCHELL, Vice Chairman

Sage Dixon

John Gannon

James Holtzclaw

Ned Burns

Jason Monks

Megan Blanksma

Dustin Manwaring

Charlie Shepherd

Jaron Crane

Clay Handy

Ted Hill

Greg Lanting

Steve Miller

James Petzke

Julie Yamamoto

Secretary: Tracey McDonnell

Rm EW60, Ph: 332-1146

WAYS & MEANS (7)

hway@house.idaho.gov

Meeting Room EW05

On Call pm

Capitol Mall Cable Ch. 6.2

JON WEBER, Chairman

Megan Blanksma

Ilana Rubel

Sage Dixon

Lauren Necochea

Dustin Manwaring

Ned Burns

Secretary: Wendy Carver-Herbert

Rm EW12, Ph: 332-1159

LEGISLATIVE ATTACHÉS & SUPPORT STAFF

(All area codes are 208 unless otherwise noted)

- A -

Admin Asst to Pro Tem (W331).....	332-1302
Aggers, Patrick (700 W. State St.).....	334-4865
Agricultural Affairs - House.....	332-1137
Agricultural Affairs - Senate.....	332-1330
Ahrens, Trevor (W131).....	334-4821
Alexis, Jazz (E110).....	332-1068
Allen, Tyler (WG48C).....	332-1335
Alles, Hope (E138).....	332-1051
Amoah, Lena (WW33).....	332-1332
Anderson, Michelle (EW49).....	332-1139
Aninon, Angela (WG10A).....	332-1414
Application Development (W118).....	334-4849
Appropriations - House.....	334-4736
Asst Chief Clerk (E306).....	332-1143
Audits (700 W. State St., Ste 100).....	334-4875

- B -

Bailey, Lauren (954 W. Jefferson).....	332-1469
Bartlett, Amanda (954 W. Jefferson).....	332-1473
Bengtzen, Amy (EW58).....	332-1148
Bennett, Gaye (W435).....	332-1341
Bergey, Kellie (700 W. State St.).....	334-4831
Blackburn, Kim (E311).....	332-1151
Bloom, Benjamin (700 W. State St.).....	334-4872
Bowden, J.E. (700 W. State St.).....	334-4827
Bowen, Elizabeth (W141).....	334-4851
Boyer, Sean (W128).....	332-1291
Brewer, Joyce (WW42).....	332-1326
Briggs, Anna (EG06).....	334-4733
Brown, Amy (700 W. State St.).....	334-4866
Budget, Policy & Analysis (C305).....	334-3531
Bush, Ryan (W140).....	334-4857
Business - House.....	332-1139
Bybee, Keith (C305).....	334-4739

- C -

Carver-Herbert, Wendy (EW12).....	332-1159
Castano, Lindsay (700 W. State St.).....	334-4846
Central Administration (W114).....	334-2475
Chaplain - House.....	332-1111
Chaplain - Senate.....	332-1302

LEGISLATIVE ATTACHÉS & SUPPORT STAFF

(All area codes are 208 unless otherwise noted)

Chelson, Brigham (WW24).....	332-1337
Chief Clerk - House (E304).....	332-1141
Chief Fiscal Officer - House (E333).....	332-1112
Chief of Staff to Speaker (E303).....	332-1111
Christensen, Elbia (EW49).....	332-1139
Clark, Norma (W118).....	334-4849
Collier, Jeremy (EW08).....	332-1149
Combo, Jim (700 W. State St.).....	334-4840
Commerce & Human Resources - House.....	332-1149
Commerce & Human Resources - Senate.....	332-1333
Conrad, Nancy (EW56).....	332-1127
Coutts, Nic (EG29).....	332-1131
Cruces, Natalia (W407).....	332-1416
Crumley, Jolene (700 W. State St.).....	334-4847
Csutoras, Jerry (WW26).....	332-1401

- D -

Demer, Liz (954 W. Jefferson).....	332-1468
Disney, Lara (W143).....	334-4852
Douglas, Cameron (EW62).....	332-1136
Drake, Matt (W142).....	334-4825

- E -

Education - House.....	332-1148
Education - Senate.....	332-1321
Environment, Energy & Technology - House.....	332-1128
Ethics and House Policy - House.....	

- F -

Farina, Matt (C419).....	334-4743
Farris, Trevor (EG29).....	332-1134
Feik, Jayne (EW11).....	332-1137
Finance - Senate.....	334-4735
Ford, Kristin (W144).....	334-4859
Franks-Smith, Terri (E333).....	332-1112

- G -

Gerrity, Katharine (W139).....	334-4867
Gipson, Shanna (W113).....	334-4879
Glover, Eric (C113).....	334-4863
Grantham, Linette (WW39).....	332-1321

- H -

Harris, Glenn (W120).....	334-4835
---------------------------	----------

LEGISLATIVE ATTACHÉS & SUPPORT STAFF

(All area codes are 208 unless otherwise noted)

Haug, Angela (C308).....	334-3537
Headlee, Paul (W124).....	334-4746
Health & Welfare - House.....	332-1138
Health & Welfare - Senate.....	332-1319
Hendon, Lori (700 W. State St.).....	334-4868
Hendricks, Lisa (EW46).....	332-1145
Hiatt, Greg (700 W. State St.).....	334-4841
Hibbard, Tim (C420).....	334-4858
Hickey, Jim (W326A).....	332-1311
Hill, Ian (W116).....	334-4878

- I -

Ivie, Crystal (WG108).....	332-1408
----------------------------	----------

- J -

Jackson, Alyson (C316).....	334-4736
Jacobsen, Soren (W121).....	334-4848
Jessup, Janet (C416).....	334-4730
Johnson, Olivia (W132).....	334-4843
Johnson, Shelly (WW37).....	332-1323
Jones, Justin (700 W. State St.).....	334-4861
Journal Clerk - House (E306).....	332-1142
Judiciary & Rules - Senate.....	332-1317
Judiciary, Rules & Administration - House.....	332-1127

- K -

Kaae, Hayley (W114).....	334-4855
Kambeitz, Linda (WW46).....	332-1333
King, Grace (C114).....	334-4737
Kish, Jennifer (W149).....	334-4854
Klotthor, Ben (700 W. State St.).....	334-4839
Kondeff, Terri (W125).....	334-4828

- L -

Lamb, Jocelyn (EW54).....	332-1125
Langrill, Ryan (954 W. Jefferson).....	332-1475
Lawless, Meg (WW50).....	332-1315
Legislative Advisors' Lounge (WG21).....	343-6444
Legislative Information Center (Grdn Rotunda).....	332-1000
Legislative Research Library (1 st Floor C114).....	334-4822
Legislative Services Office (W114).....	334-4828
Leonova, Anastasia (700 W. State St.).....	334-4873
Lippitt, Frances (C417).....	334-4745

LEGISLATIVE ATTACHÉS & SUPPORT STAFF

(All area codes are 208 unless otherwise noted)

Lobbyists (WG21).....	343-6444
Local Government & Taxation - Senate.....	332-1315
Local Government - House.....	332-1147

- M -

Malevich, Kirill (W116).....	334-4734
Manser, Alex (700 W. State St.).....	334-4833
Maurin, Kay (W428).....	332-1307
McDonald, Sarah Jane (W307).....	332-1400
McDonnell, Tracey (EW60).....	332-1146
McFarland, Jeff (W122).....	334-4870
McGinnis, Erica (E304).....	332-1141
Melton, Twyla (W326).....	332-1310
Miller, Erin (C305).....	334-4735
Mohan, Rakesh (954 W. Jefferson - 2 nd flr).....	332-1480
Molitor, MaryLou (E303).....	332-1111
Montgomery, Dalton (W134).....	334-4853
Montgomery, Jim.....	332-1403
Moore, Baylie (W133).....	334-4845
Moore, Irene (EW14).....	332-1138
Moore, Nicholas (700 W. State St.).....	334-4824
Moss, Mackenzie (954 W. Jefferson).....	332-1476
Moyer, Peggy (W330).....	332-1303

- N -

Nelson, James (WG48A).....	332-1417
Network Administration (W121).....	334-4747
Novak, Jennifer (W327).....	332-1309

- O -

O'Brien, Michelle (W135).....	334-4850
O'Connell, Sasha (954 W. Jefferson).....	332-1472
OPE - Performance Eval (954 W. Jefferson-2 nd flr)....	332-1480
Osborne, Nathan (C418).....	334-4741
Otto, Christine (C421).....	334-4732

- P -

Pages - House (EW63).....	332-1156
Pages - House (E311).....	332-1153
Pages - Senate (WW26).....	332-1357
Pages - Senate (W306).....	332-1359
Pantera, Heidi (W304).....	332-1351
Pennington, Sharon (WW48).....	332-1317

LEGISLATIVE ATTACHÉS & SUPPORT STAFF

(All area codes are 208 unless otherwise noted)

Petti, Casey (954 W. Jefferson).....	332-1474
Phelan, Michael (700 W. State St.).....	334-4836
Phipps, Elijah (EW16).....	332-1128
Phipps, Erin (W129).....	334-4856
President of the Senate (E219).....	334-2200
Price, Melissa (WW31).....	332-1330

- R -

Racolta, George (700 W. State St.).....	332-1295
Randolph, Jill (C415).....	334-4749
Reddish, Kolby (W123).....	332-1293
Reister, Kelly (W117).....	334-4744
Renfro, April (700 W. State St.).....	334-4826
Research & Legislation (W133).....	334-4834
Resources & Conservation - House.....	332-1136
Resources & Environment - Senate.....	332-1323
Revenue & Taxation - House.....	332-1125
Rickard, Amanda (C114).....	334-4822

- S -

Sec to Sec of Senate (W326).....	332-1310
Secretary, Pool (EG07).....	332-1051
Secretary of the Senate (W327).....	332-1309
Security, Main.....	334-2222
Sergeant at Arms - House (E311).....	332-1150
Sergeant at Arms - Senate (W307).....	332-1400
Sherfick, Chad (W128).....	334-4877
Smith, Dianne (Gift Shop).....	332-1013
Smith, Morgan (700 W. State St.).....	334-4837
Sprague, Kieran (WG10).....	332-1418
Staff, Minority (EG29).....	332-1191
State Affairs - House.....	332-1145
State Affairs - Senate.....	332-1326

- T -

Tatro, Jared (C318).....	334-4740
Thomas, Joy (E331).....	332-1132
Tierney, Michelle (WW35).....	332-1319
Titus, Ashley (700 W. State St.).....	334-4838
Transportation & Defense - House.....	332-1146
Transportation - Senate.....	332-1332
Tucker, Kyle (700 W. State St.).....	334-4869

- U -

LEGISLATIVE ATTACHÉS & SUPPORT STAFF

(All area codes are 208 unless otherwise noted)

Uriarte , Maria (700 W. State St.)..... 334-4829

- V -

Vore, Cyrus (E306)..... 332-1143

- W -

Wall, Jeff (E311)..... 332-1150

Watkins, Jacob (W326A)..... 332-1312

Ways & Means - House..... 332-1159

Werlinger, Susan (EW45)..... 332-1161

Wheeler, Janni (W147)..... 334-4842

Williamson, Alex (C319)..... 334-4742

Winslow, Shane (C317)..... 334-4738

Wisdom, Rellie (W331)..... 332-1302

Wise, Christina (700 W. State St.)..... 334-4830

Wonacott, Michelle (E306)..... 332-1142

Woods, Shelley (700 W. State St.)..... 334-4832

Woodward, Benjamin (700 W. State St.)..... 334-4864

- Y -

Yanak, Ann (WG48B)..... 332-1343

Young, Kayla (700 W. State St.)..... 334-4844

STATE GOVERNMENT

(All area codes 208 unless otherwise noted)

- A -

Administration, Department of	
Keith Reynolds, Director.....	332-1812
Steve Bailey, Deputy Director.....	332-1825
Pat Donaldson, Public Works.....	332-1912
Valerie Bollinger, Administrator, Purchasing.....	332-1631
Faith Cox, Administrator, Risk Mgt/Grp Ins.....	332-1871
Steve Walker, Manager, Security Operations.....	332-1960
Aging, Commission on	
Judy B. Taylor, Director.....	334-3833
Agriculture, Department of	
Celia Gould, Director.....	332-8500
Appellate Public Defender, State	
Eric Fredericksen.....	334-2712
Arts, Commission on the	
Michael Faison, Executive Director.....	334-2119
Attorney General's Office	
Raúl Labrador, Attorney General.....	334-2400

- B -

Blind and Visually Impaired, Commission for the	
Beth Cunningham, Administrator.....	639-8373
Boise State University	
Dr. Marlene Tromp, President.....	426-1491
Andrew Mitzel, Director, Government Affairs.....	695-5440
Brand Inspector	
Cody Burlile, Brand Inspector.....	884-7070
Building Authority, Idaho State	
Wayne Meuleman, Executive Director.....	345-6057

- C -

Capitol Commission	
Andrew Erstad, Chairman.....	331-9031
Career & Technical Education	
Clay Long, Administrator.....	429-5501
Catastrophic Health Care	
Greg Johnson, Board Chairman.....	529-1360
Kelli Brassfield, Program Director.....	514-0369
Child Support	
Rob Rinard, Bureau Chief.....	334-0620
College of Agricultural and Life Sciences, UI	
Michael P. Parrella, Ph.D., Dean.....	885-6681

STATE GOVERNMENT

(All area codes 208 unless otherwise noted)

College of Eastern Idaho	
Rick Aman, Ph.D., President.....	535-5366
Lori Barber, MA, VP, Academic & Student Affairs..	535-5419
Byron Miles, MBA, VP, Finance & Admin.....	535-5387
College of Southern Idaho	
Dr. L. Dean Fisher, President.....	732-6201
Jeff Harmon, VP Finance and Administration.....	732-6210
Dr. Jonathan Lord, VP Student Services.....	732-6863
Dr. Todd Schwarz, Provost.....	732-6325
College of Western Idaho	
Gordon Jones, President.....	562-3200
Ashley Smith, Government Relations.....	562-3106
William Reuter, Vice President, Finance.....	562-3299
Craig Brown, Exec. Vice President, Operations.....	562-3412
Commerce, Department of	
Tom Kealey, Director.....	334-2470
Cody Allred, Public Information Specialist.....	780-5152
Controller's Office	
Brandon D Woolf, State Controller.....	334-3100
Joshua C. Whitworth, Chief Deputy.....	334-3100
Correction, Board of	
Dr. David McClusky, Chairman.....	658-2000
Correction, Department of	
Josh Tewalt, Director.....	658-2140
Bree Derrick, Deputy Director.....	658-2036
Correctional Industries	
Todd Plimpton, General Manager.....	863-2244
- D -	
Deaf and the Blind, Idaho Educational Services for the	
Brian Darcy, Superintendent.....	934-4457
Bonnie Marshall, Director of Finance.....	934-4457
Dental Education Program, ISU	
J. Jeffrey Ybarguen DDS, Director.....	282-3289
Developmental Disabilities, Council on	
Christine Pisani, Executive Director.....	334-2178
Disability Determinations Service	
William Hernandez, Bureau Chief.....	327-7333
Jon Speiser, Program Manager.....	327-7333
Domestic Violence and Victim Assist., Council on	
Heather Cunningham, Executive Director.....	332-1542

STATE GOVERNMENT

(All area codes 208 unless otherwise noted)

Drug Policy, Office of
Marianne King, Director..... 854-3043

- E -

ECHO Idaho, UI
(Extension for Community Health Outcomes)
Eric Studebaker, Director.....364-4698

Education, Department of
Debbie Critchfield, Superintendent of Public Inst... 332-6815

Education, State Board of
Matt Freeman, Executive Director..... 332-1570
Kurt Liebich, President.....332-1571
Dr. Linda Clark, Vice President.....332-1571

Emergency Management, Idaho Office of
Brad Richy, Director.....258-6501

Endowment Fund Investment Board
Chris Anton, Manager of Investments..... 334-3312

Energy and Mineral Resources, Idaho Governor's Office of
Richard Stover, Administrator..... 332-1660

Environmental Quality, Department of
Jess Byrne, Director.....373-0240
Kristin Ryan, Deputy Director..... 373-0240
Tiffany Floyd, Administrator, Air Quality Division....373-0440
Jeri Henry, Administrator, Drinking Water Div..... 373-0471
Mary Anne Nelson, Surf & Wastewatr Div..... 373-0595
Michael McCurdy, Waste & Remed. Div.....373-0523

- F -

Family Medicine Residency, ISU
Brandon Mickelsen, D.O., Director..... 282-4508

Finance, Department of
Patricia Perkins, Director..... 332-8010
Anthony Polidori, Deputy Director.....332-8060

Financial Management, Div of
Alex Adams, Administrator.....334-3900
Brad Hunt, Coordinator, Administrative Rules..... 854-3096

Fish and Game Commission
Tim Murphy, Chairman..... 850-0055

Fish and Game, Department of
Ed Schriever, Director.....334-5159
Jim Fredericks, Deputy Director.....334-3771
Amber Worthington, Deputy Director.....334-3771

STATE GOVERNMENT

(All area codes 208 unless otherwise noted)

Michael Pearson, Chief, Administration.....	287-2800
Clint Worthington, Chief, Engineering.....	334-3730
Lance Hebdon, Chief, Fisheries.....	334-3791
Greg Wooten, Chief, Law Enforcement.....	334-3736
Jon Rachael, Chief, Wildlife.....	334-2920
Full Circle Health	
Ted Epperly, M.D., President and CEO.....	954-8745

- G -

Governor's Office

Brad Little, Governor.....	334-2100
Zach Hauge, Chief of Staff.....	334-2100

- H -

Health and Welfare, Board of

Tim Rarick, Chairman.....	496-4034
---------------------------	----------

Health and Welfare, Department of

Dave Jeppesen, Director.....	334-5500
Lisa Hettinger, Deputy Director.....	334-5801
Jennifer Palagi, Deputy Director.....	334-0679
Miren Unsworth, Deputy Director.....	334-5506
Ross Edmunds, Behavioral Health Administrator...	334-6587
Juliet Charron, Medicaid Administrator.....	364-1831
Cameron Gilliland, Family/Child Administrator.....	334-5680
Laura Stute, License & Certification Administrator.	354-1971
Elke Shaw-Tulloch, Public Health Administrator....	334-6996
Shane Leach, Welfare Administrator.....	332-7258
Staci Phelan, Management Services.....	334-0632

Hispanic Affairs, Commission on

Margie Gonzalez, Executive Director.....	334-3776
--	----------

Historical Society, Idaho State

Janet L. Gallimore, Executive Director.....	334-2682
---	----------

Human Resources, Division of

Lori Wolff, Administrator.....	982-6805
--------------------------------	----------

Human Rights Commission

Benjamin J. Earwicker, Ph.D., Administrator.....	334-2873
--	----------

- I -

Idaho Housing and Finance Association

Gerald M. Hunter, President.....	331-4732
----------------------------------	----------

Idaho Potato Commission

Jamey Higham, President/CEO.....	334-2350
----------------------------------	----------

STATE GOVERNMENT

(All area codes 208 unless otherwise noted)

Idaho Public Television	
Jeff Tucker, General Manager.....	373-7220
Idaho State Police	
Colonel Kedrick Wills, Director.....	884-7003
Lt. Colonel Bill Gardiner, Deputy Director.....	884-7004
Lt. Colonel Sheldon Kelley, Deputy Director.....	884-7002
Brad Johnson, Div Admin, POST Academy.....	884-7251
Idaho State University	
Kevin Satterlee, President.....	282-2566
Industrial Commission	
George Gutierrez, Director.....	334-6000
Information Technology Services, Office of	
Alberto Gonzalez, Administrator.....	605-4067
Brian Smith, Deputy Administrator.....	605-4051
Insurance Fund, State	
Rick Ferguson, CEO.....	332-2100
Insurance, Department of	
Dean Cameron, Director.....	334-4250
- J -	
Judicial Branch, Supreme Court	
Sara B. Omundson, Admin. Dir. of the Courts.....	334-2246
Jason Slade Spillman, Legal Counsel.....	334-2246
Juvenile Corrections, Department of	
Monty Prow, Director.....	334-5100
- L -	
Labor, Department of	
Jani Revier, Director.....	332-3570
Darlene Carnopis, Policy Coordinator.....	332-3570
Lands, Department of	
Dustin Miller, Director.....	334-0242
Bill Haagenon, Deputy Director.....	334-0242
Scott Phillips, Policy and Communications Chief...	334-0294
Lava Hot Springs Foundation	
Tyson Koester, Executive Director.....	776-5221
Legislative Services Office	
Terri Kondeff, Director.....	334-4828
Lewis-Clark State College	
Cynthia Pemberton, Ed.D., President.....	792-2216
Logan Fowler, Government Relations.....	792-2200

STATE GOVERNMENT

(All area codes 208 unless otherwise noted)

Libraries, Idaho Commission for	
Stephanie Bailey-White, State Librarian.....	639-4145
Lieutenant Governor's Office	
Scott Bedke, Lieutenant Governor.....	334-2200
Liquor Division	
Jeffrey R. Anderson, Director.....	947-9402
Lottery Commission	
Jeffrey R. Anderson, Director.....	780-2500

- M -

Military Division	
Maj Gen Michael Garshak, Adjutant General.....	801-4200
Museum of Natural History, Idaho	
Dr. Leif Tapanila, Director.....	282-5417

- N -

North Idaho College	
Nick Swayne, PhD, President.....	769-3303
Sarah Garcia, VP for Finance & Business Affairs...	769-3340
Laura Rumpler, Chief Comm/Gov Rel Officer.....	769-3404
Northwest Power and Conservation Council	
Jeffery Allen, Idaho Member.....	947-4084
James A. Yost, Idaho Member.....	947-4083

- O -

Occupational and Professional Licenses, Division of	
Russell Barron, Division Administrator.....	577-2482
Tim Frost, Deputy Administrator.....	735-6251
Nicole Gallaher, Exec Mgmt Assistant.....	577-2500
Nicki Chopski, Bureau Chief, Health Professions...	803-5982
Anne Lawler, Bureau Chief, Occup Licenses.....	331-2341
Amy Lorenzo, Bureau Chief, Bldg, Const & RI Est	332-7150

- P -

Pardons and Parole, Commission of	
Ashley Dowell, Executive Director.....	334-2520
Parks and Recreation Board	
Brian Beckley, Chairman.....	334-4199
Parks and Recreation, Department of	
Susan Buxton, Director.....	514-2251
Public Defense Commission	
Kathleen Elliott, Executive Director.....	332-1736
Jennifer Cichocki, Management Assistant.....	332-1735
Tammy Zokan, Compliance & Policy.....	332-1735

STATE GOVERNMENT

(All area codes 208 unless otherwise noted)

Public Employee Retirement System (PERSI)	
Don Drum, Executive Director.....	287-9506
Jeff Cilek, Chairman.....	287-9230
Public Health Districts	
D5, Twin Falls, Melody Bowyer, Director.....	737-5900
D4, Boise, Russell Duke, Director.....	375-5211
D6, Pocatello, Maggie Mann, Director.....	233-9080
D2, Lewiston, Carol Moehrle, Director.....	799-0344
D7, Idaho Falls, Geri Rackow, Director.....	522-0310
D1, Hayden, Lora Whalen, Director.....	415-5100
D3, Caldwell, Nikole Zogg, Director.....	455-5300
Public Television, Idaho	
Jeff Tucker, General Manager.....	373-7220
Public Utilities Commission	
Maria Barratt-Riley, Executive Administrator.....	334-0337
- R -	
Racing Commission	
Ardie Noyes, Business Operations Manager.....	884-7080
- S -	
Secretary of State, Office of the	
Phil McGrane, Secretary of State.....	334-2300
Soil and Water Conservation Commission	
Delwyne Trefz, Administrator.....	332-1790
Species Conservation, Office of	
Mike Edmondson, Administrator.....	332-1551
- T -	
Tax Appeals, Board of	
Leland "Lee" Heinrich, Chairman.....	334-3354
Cindy Pollock, Director & Clerk.....	334-3354
Tax Commission	
Jeff McCray, Chairman.....	334-7500
Tom Katsilometes, Commissioner.....	334-7503
Janet Moyle, Commissioner.....	334-7500
Jared Zwygart, Commissioner.....	334-7500
Alan Dornfest, Property Tax Policy Bureau Chief...	334-7742
Kathlynn Ireland, Property Tax Policy Specialist....	334-6624
Tom Shaner, Tax Policy Manager.....	334-7518
Transportation Board, Idaho	
Bill Moad, Chairman.....	250-0113
Julie DeLorenzo, D3, Member.....	703-4348

STATE GOVERNMENT

(All area codes 208 unless otherwise noted)

Bob Hoff, D6, Member.....	521-2092
Jim Kempton, D4, Member.....	673-6261
Gary Osborn, D2, Member.....	509-336-3958
Jim Thompson, D1, Member.....	597-4335
Transportation Department, Idaho	
L. Scott Stokes, Director.....	334-8807
Dan McElhinney, Chief Operations Officer.....	334-8811
Dave Tollman, Chief Admin. Officer.....	334-8876
Sharon Snell, H.R. Officer.....	334-8010
Jeff Marker, Administrator, Aeronautics.....	334-8788
Lisa McClellan, Administrator, Motor Vehicles.....	334-8234
Mollie McCarty, Chief External Affairs Officer.....	334-8804
Treasurer, Office of the State	
Julie A. Ellsworth, State Treasurer.....	334-3200
- U -	
University of Idaho	
C. Scott Green, President.....	885-6365
Caroline Nilsson Troy, Governmental Relations.....	334-2315
- V -	
Veterans Services, Division of	
Mark Tschampl, Chief Administrator.....	780-1300
Vocational Rehabilitation, Division of	
Jane Donnellan, Administrator.....	334-3390
- W -	
WIMU Veterinary Degree Program (Washington-Idaho-Montana-Utah)	
Michael P. Parrella, Ph.D., Dean.....	885-6681
WWAMI Medical Education, UI (Washington, Wyoming, Alaska, Montana, Idaho)	
Jeff Seegmiller, Ed.D., ATC, Regional Dean.....	885-6696
Water Resource Board	
Jeff Raybould, Chairman.....	287-4800
Water Resources, Department of	
Gary Spackman, Director.....	287-4800
Mat Weaver, Deputy Director.....	287-4914
Brian Patton, Planning and Projects Bureau.....	287-4837
Shelley Keen, Water Allocations Bureau.....	287-4947
Tim Luke, Water Compliance Bureau.....	287-4959
Western Interstate Commission for Higher Education (WICHE)	
Dr. Demarée Michelau, President.....	303-541-0201

ELECTED OFFICIALS

(All area codes are 208 unless otherwise noted)

Congressional

Senator Mike Crapo (R)

Dirksen Senate Office Building

Room 239

Washington, DC 20510 202-224-6142

251 E. Front St., Ste. 205, Boise 83702 208-334-1776

Senator James E. Risch (R)

Russell Senate Office Building

Room 483

Washington, DC 20510 202-224-2752

350 N. 9th St., Ste. 302, Boise 83702 208-342-7985

Congressman Russ Fulcher (R)

Longworth House Office Building

Room 1520

Washington, DC 20515 202-225-6611

33 E. Broadway Ave., Ste. 251, Meridian 83620 208-888-3188

Congressman Mike Simpson (R)

Rayburn House Office Building

Room 2084

Washington, DC 20515 202-225-5531

802 W. Bannock, Ste. 600, Boise 83702 208-334-1953

State

Governor Brad Little (R) 334-2100

Capitol Building, Room W223

700 W. Jefferson St., P.O. Box 83720, Boise 83720-0034

Lieutenant Governor Scott Bedke (R) 334-2200

Capitol Building, Room E219

700 W. Jefferson St., P.O. Box 83720, Boise 83720-0057

Secretary of State Phil McGrane (R) 334-2300

Capitol Building, Room E205

700 W. Jefferson St., P.O. Box 83720, Boise 83720-0080

ELECTED OFFICIALS

(All area codes are 208 unless otherwise noted)

State

- State Controller Brandon D Woolf (R) 334-3100
J.R. Williams Building, 5th Floor
700 W. State St., P.O. Box 83720, Boise 83720-0011
- State Treasurer Julie A. Ellsworth (R) 334-3200
Borah Building, Room 403
304 N. 8th St., P.O. Box 83720, Boise 83720-0091
- Attorney General Raúl Labrador (R) 334-2400
Capitol Building, Room C210
700 W. Jefferson St., P.O. Box 83720, Boise 83720-0010
- Supt Public Instruct Debbie Critchfield (R) 332-6815
Len B. Jordan Building, 2nd Floor
650 W. State St., P.O. Box 83720, Boise 83720-0027

Judicial Branch

- Administration 334-2246
451 W. State St., P.O. Box 83720, Boise 83720-0101

Supreme Court:

Chief Justice G. Richard Bevan
Justices: Robyn Brody, John R. Stegner,
Gregory W. Moeller, Colleen Zahn

Court of Appeals:

Chief Judge Jessica M. Lorello
Judges: Amanda K. Brailsford, David W.
Gratton, Molly J. Huskey

CAPITOL CORRESPONDENTS

(All area codes are 208 unless otherwise noted)

- Associated Press 343-1894
Rebecca Boone, rboone@ap.org
- Boise Weekly 344-2055
Jeanne Huff, jhuff@boiseweekly.com . . x3015
- Capital Press Ag Weekly, Boise 914-8264
Brad Carlson, bcarlson@capitalpress.com 891-2406
- Idaho Business Review 995-3408
Alx Stevens, news@idahobusinessreview.com
- Idaho Capital Sun
Clark Corbin, ccorbin@idahocapitalsun.com
Audrey Dutton, adutton@idahocapitalsun.com
Christina Lords, clords@idahocapitalsun.com
Kelcie Moseley-Morris, kmoseley@idahocapitalsun.com
info@idahocapitalsun.com
- Idaho Education News
Jennifer Swindell 473-8811
jswindell@idahoednews.org
Kevin Richert, krichert@idahoednews.org 867-1403
Sadie Dittenber, sadie@idahoednews.org 249-4941
- Idaho Falls Post Register 522-1800
Johnathan Hogan, jhogan@postregister.com
news@postregister.com
- Idaho Press, Nampa 465-8124
Laura Guido, lguido@idahopress.com . . (509) 339-5783
Carolyn Komatsoulis (301) 312-4441
ckomatsoulis@idahopress.com
Erin Banks Rusby (206) 334-3751
erusby@idahopress.com
newsroom@idahopress.com
- Idaho Statesman, Boise 377-6400
Ryan Suppe, rsuppe@idahostatesman.com
Hayat Norimine, hnorimine@idahostatesman.com
Scott McIntosh 377-6202
smcintosh@idahostatesman.com
newsroom@idahostatesman.com

CAPITOL CORRESPONDENTS

(All area codes are 208 unless otherwise noted)

- Lewiston Tribune 743-9411
city@lmtribune.com
- Idaho Public Television 373-7220
Idaho Reports
Melissa Davlin, Melissa.Davlin@idahoptv.org
Logan Finney, Logan.Finney@idahoptv.org
Ruth Brown, Ruth.Brown@idahoptv.org
- Dialogue
Marcia Franklin, Marcia.Franklin@idahoptv.org
- Science Trek
Joan Cartan-Hansen, JCH@idahoptv.org
- KBOI-TV 2, "CBS2," Boise 472-2207
Marcos Guadarrama, mguadarrama@sbgvtv.com
Angela Kerndl, amkerndl@sbgvtv.com
news@kboi2.com
- KIFI-TV 8 "Local News 8," Idaho Falls 525-2520
KIDK-TV 3; KXPI- Fox
Todd Kunz, todd.kunz@kidk.com 206-4413
newsdesk@localnews8.com
- KIVI-TV 6 "6 On Your Side," Nampa 381-6660
KNIN-TV 9 "Fox 9"
Nicole Camarda, nicole.camarda@kivityv.com
news@kivityv.com
- KPVI-TV 6 "News 6," Pocatello 232-6666
Heatherann Wagner, heatherannwnews@gmail.com
Misty Inglet, minglet@kpvi.com
newsroom@kpvi.com
- KTVB-TV 7, Boise 321-5614
Joe Parris, jparris@ktvb.com
ktvbnews@ktvb.com
- KBSX 91.5, BSU Public Radio 426-3663
James Dawson, jdawson@boisestate.edu 426-3627
Samantha Wright, swright@boisestate.edu 426-3613
Troy Oppie, troyoppie@boisestate.edu . . (206) 235-3989
kbsxnewsroom@BoiseState.edu

* Capitol Correspondents are members of the media who are officially credentialed to work in the Capitol Building during the legislative session.

ORDERS OF BUSINESS

SENATE

1. Roll Call
2. Prayer and Pledge of Allegiance
3. Reading and correction of Journal
4. Reading of communications
5. Presentation of petitions, resolutions and memorials
6. Reports of standing committees
7. Reports of special committees
8. Consideration of messages from the Governor
9. Consideration of messages from the House of Representatives
10. Motions and consideration of petitions, resolutions and memorials
11. Introduction, first reading and reference of bills
12. Second reading of bills
13. Third reading of bills
14. Consideration of general calendar
15. Miscellaneous business

HOUSE

1. Roll Call
2. Prayer and Pledge of Allegiance
3. Approval of Journal
4. Consideration of messages from the Governor and the Senate
5. Report of standing committees
6. Report of select committees
7. Motions, memorials and resolutions
8. Introduction, first reading and reference of bills and joint resolutions
9. First reading of engrossed bills
10. Second reading of bills and joint resolutions
11. Third reading of bills and joint resolutions
12. Consideration of general orders
13. Miscellaneous and unfinished business
14. Presentation of petitions and communications
15. Announcements
16. Adjournment