

2025 Legislative Directory Errata Sheet (December 17, 2024)



As of December 17, 2024, the following errata to the Legislative Directory are shown in italics and corrected in bold.

p.2	Asst to Maj Cauc Chr, <i>Pending Asst</i> > Peggy Moyer
p.2	Ast to Maj Ldr, Alicia Fowler-Rynearson (<i>WW330</i>) > W330
p.3	Majority Caucus Chair, Jaron Crane (<i>E407</i>) > E401
p.3	Majority Staff Assistant, <i>Pending Hire (E401)</i> > Ciley Born (E407)
p.3	Pool Secretary II, <i>Pending Hire</i> > Michele Coburn
p.7	Grow, C. Scott Rm: <i>C308</i> > C305
p.9	Crane, Jaron Rm: <i>E407</i> > E401
p.55	Secretary: <i>Agricultural Affairs</i> , > Rachel Verrette
p.55	Secretary: <i>Tasheica Lenardo</i> > Kathryn Wells
p.56	Secretary: <i>Agricultural Affairs</i> , > Rachel Verrette
p.58	Secretary: <i>Tasheica Lenardo</i> > Kathryn Wells
p.67	Removed > <i>>Affairs, Agricultural (WW31).....332-1330</i>
p.67	Removed > <i>Asst, Pending (W435)....332-1341</i>



p.67	Added > Born, Ciley (E407).....332-1120
p.68	Added > Coburn, Michele (E110).....332-1068
p.69	Fowler-Rynearson, Alicia (WW330) > (W330)
p.69	Removed > <i>Hire, Pending (E110).....332-1068</i>
p.69	Removed > <i>Hire, Pending (E401).....332-1020</i>
p.70	Removed > <i>Lenardo, Tasheica (WW42)....332-1326</i>
p.70	Lobbyists (WG21)....343-6444 > 332-1980
p.70	Added > Moyer, Peggy (W435).....332-1341
p.72	Added > Wells Kathryn (WW42).....332-1326

2025 Legislative Directory



**1st Regular Session
68th Idaho Legislature**

LEGEND

	1st Congressional District
	2nd Congressional District
	State Legislative District Boundary

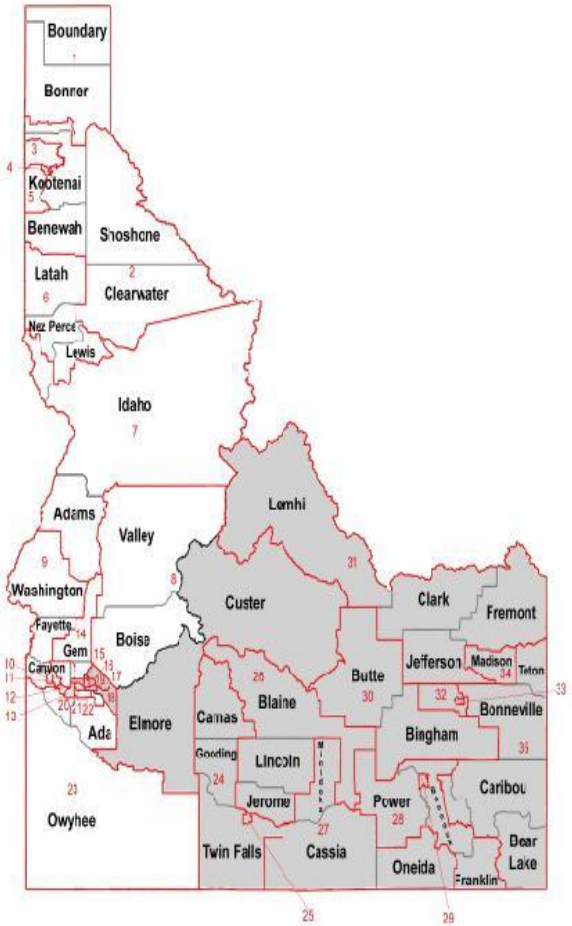

Cover Art by: John Carver & Shanna Gipson

CONTENTS

Senate Leadership and Administration	2
House Leadership and Administration	3
Legislative Staff Offices	4
Important Session Dates	6
Senators, Alphabetical	7
Representatives, Alphabetical	9
Legislators by District	13
Floor Maps	48
Senate Committees	56
House Committees	60
Legislative Attachés & Support Staff	67
State Government	73
Elected Officials	81
Capitol Correspondents	83
Orders of Business	85

All area codes in this Legislative Directory are 208 unless otherwise noted

How to Contact Legislators

Website	legislature.idaho.gov
Legislative Information Center	(208) 332-1000
Toll Free & TDD	800-626-0471
E-mail	idleginfo@lso.idaho.gov
Regular Mail	P.O. Box 83720, Boise, ID 83720-0038 (House) 83720-0081 (Senate)
Street Address	State Capitol, 700 W. Jefferson Boise, ID 83720

IDAHO IN SESSION

In-Capitol Cable TV:

Senate, Ch. 3.2; House, Ch. 3.1; JFAC, Ch. 3.3

Auditorium WW02, Ch. 4.1; Senate WW17, Ch. 97.1

Idaho Public Television Statewide Broadcast Channels:

Senate, World - 4.4; House, Plus Channel - 4.2

Audio/video streaming on:

www.idahoptv.org/shows/idahoinsession/Legislature/

**Current Legislative Directory information available at:
www.legislature.idaho.gov**

SENATE

(All area codes are 208 unless otherwise noted)

Leadership

President Pro Tem, Kelly Arthur Anthon (W331).....	332-1300
Admin Asst to Pro Tem, Rellie Wisdom (W331).....	332-1302
Majority Leader, Lori Den Hartog (W330).....	332-1305
Ast to Maj Ldr, Alicia Fowler-Ryneerson (W330).....	332-1303
Assistant Majority Leader, Mark Harris (W428).....	332-1308
Asst to Asst Maj Ldr, Gaye Bennett (W428).....	332-1307
Majority Caucus Chair, Ben Toews (W435).....	332-1304
Asst to Maj Cauc Chr, Peggy Moyer (W435).....	332-1341
Minority Leader, Melissa Wintrow (W303).....	332-1410
Minority Chief of Staff, Erin Miller (W304).....	332-1351
Assistant Minority Leader, James Ruchti (W406).....	332-1411
Min Caucus Chr, Janie Ward-Engelking (W405).....	332-1412

Presiding Officer

President of the Senate, Scott Bedke (E219).....	334-2200
--	----------

Administration

Secretary of the Senate, Jennifer Novak (W327).....	332-1309
Sec to Sec Sen, Claudia Simplot Nally (W326).....	332-1310
Journal Clerk, Sawyer Crenshaw (W326A).....	332-1312
Assistant Clerk, Nikki Root (W326A).....	332-1311
Sergeant at Arms, Sarah Jane McDonald (W307).....	332-1400
Asst Sergeant at Arms, Jerry Csutoras (WW26).....	332-1401
Chaplain, Doug Armstrong.....	332-1302
Doorkeeper, Pending Doorkeeper.....	332-1403

Security

Main Number.....	334-2222
3rd Floor.....	332-1403
4th Floor.....	332-1402
West Wing.....	332-1404

HOUSE OF REPRESENTATIVES

(All area codes are 208 unless otherwise noted)

Leadership

Speaker of the House, Mike Moyle (E303).....	332-1111
Chief of Staff to Speaker, Jason Hancock (E303)...	332-1111
Majority Leader, Jason Monks (E307).....	332-1120
Assistant Majority Leader, Josh Tanner (E406).....	332-1120
Majority Caucus Chair, Jaron Crane (E401).....	332-1120
Majority Staff Assistant, Ciley Born (E407).....	332-1120
Minority Leader, Ilana Rubel (E329).....	332-1132
Minority Chief of Staff, Joy Thomas (E331).....	332-1132
Assistant Minority Leader, Steve Berch (E423).....	332-1132
Minority Caucus Chair, Todd Achilles (E424).....	332-1132

Administration

Chief Fiscal Officer, Terri Franks-Smith (E333).....	332-1112
Chief Clerk of the House, Erica McGinnis (E304).....	332-1141
Assistant Chief Clerk, Cyrus Vore (E306).....	332-1143
Journal Clerk, Michelle Wonacott (E306).....	332-1142
Secretarial Supervisor, Susan Werlinger (EW45).....	332-1161
Pool Secretary I, Jacobi Van Amburg (E138).....	332-1051
Pool Secretary II, Michele Coburn (E110).....	332-1068
Pool Secretary III, Sarah Hancock (EG56).....	332-1191
Legislative Aide I, Ingrid Andrulis (EG29).....	332-1131
Legislative Aide II, Laura Miller (EG29).....	332-1134
Sergeant at Arms, Jeff Wall (E311).....	332-1150
Asst Sergeant at Arms, Kim Blackburn (E311).....	332-1151
Doorkeeper, Brad Earl.....	332-1154
Chaplain, Tom Dougherty.....	332-1111

Security

Main Number.....	334-2222
3rd Floor.....	332-1154
4th Floor.....	332-1155
East Wing.....	332-1157

LEGISLATIVE STAFF OFFICES

(All area codes are 208 unless otherwise noted)

Legislative Services Office

Capitol Building - W114

Terri Kondeff, Director (W125)..... 334-4828
Paul Headlee, Dep Director (W124)..... 334-4746

Central Administration - W114.....334-2475

Hayley Kaae-Domgaard, Admin. Asst. (W114).... 334-4855
Michelle O'Brien, Sp. Proj. Coordinator (W135).. 334-4850
Elizabeth Bowen, Legal Counsel (W123)..... 334-4851
Casey Hartwig, Prin. Research Analyst (C104)... 332-1280
Alex Hatfield, IT Prin. Research Analyst (C104).. 332-1282
Alex Penny, Prin. Research Analyst (C104)..... 332-1281

Budget and Policy Analysis - C305.....334-3531

Keith Bybee, Division Manager (C305)..... 334-4739
Jared Tatro, Deputy Div. Manager (C318)..... 334-4740
Tamara Figueiredo, Office Coordinator (C305).... 334-3537
Janet Jessup, Principal Analyst (C416)..... 334-4730
Kevin Campbell, Senior Analyst (C417)..... 334-4741
Brooke Dupree, Analyst (C419)..... 334-4743
Christopher Lehosit, Analyst (C319)..... 332-1285
Frances Lippitt, Analyst (C415)..... 334-4745
Kellen McGurkin, Analyst (C420)..... 332-1284
Noah Peterson, Analyst (C418).....334-4749
Alex Williamson, Analyst (C421)..... 334-4742
Shane Winslow, Data Systems Coord. (C317).... 334-4738

Information Technology - W114.....334-4747

Norma Clark, Division Manager (W118)..... 334-4849
Jeff McFarland, Deputy Div. Manager (W120).... 334-4870
Soren Jacobsen, Sr. IT Specialist (W121)..... 334-4848
Help Desk (W114)..... 334-4747

LEGISLATIVE STAFF OFFICES

(All area codes are 208 unless otherwise noted)

Legislative Audits - 700 W. State St., Ste 100.....334-4875

April Renfro, Division Manager.....	334-4826
Shelley Woods, Sr. Admin. Assistant.....	334-4832
Patrick Aggers, Managing Auditor.....	334-4865
Amy Brown, Managing Auditor.....	334-4866
Jim Combo, Managing Auditor.....	334-4840

Research and Legislation - W133.....334-4834

Matt Drake, Division Manager (W142).....	334-4825
Linda Jensen, Admin. Assistant (W133).....	334-4845
Ryan Bush, Prin Drafting Atty (W140).....	334-4857
Peter Cook, Sr. Drafting Atty (W141).....	334-4859
Monica Harrington, Leg Drafting Atty (W132).....	334-4835
Alli Olson, Leg Drafting Atty (W139).....	334-4867
Kyle Slominski, Legislative Drafter (W131).....	334-4821
Lara Disney, Senior Editor (W143).....	334-4852
Olivia Johnson, Senior Editor (W144).....	334-4843
Jennifer Kish, Information Liaison (W149).....	334-4854

Legislative Research Library - 1st Floor C114.....334-4822

Layce Silvey, Legislative Librarian (C113).....	334-4863
---	----------

Copy Center - EG13.....334-4823

Legislative Information Center - Grdn Rotunda...332-1000

Gift Shop - CG24.....332-1013

Dianne Smith, Manager (Gift Shop).....	332-1013
--	----------

Office of Performance Evaluations

954 W. Jefferson-2nd flr

Ryan Langrill, Director.....	332-1475
------------------------------	----------

IMPORTANT SESSION DATES

January 6	Legislature Convenes
January 17	Senate Personal Bill Deadline
February 3	Legislative Services Office RS Deadline to meet 36th Day Bill and Joint Resolution Introduction Deadline
February 10	36th Day Bill and Joint Resolution/Constitutional Amendment Introduction Deadline, with exceptions for privileged committees: Senate Finance, Judiciary and Rules, and State Affairs Committees; and House Appropriations, Education, Health and Welfare, Revenue and Taxation, State Affairs, and Ways and Means Committees
February 28	Committee Target to Report on Rules Review
March 3	Transmittal Date for Joint Resolutions/Constitutional Amendments Target for Transmittal of All Legislation Between Houses
March 6	JFAC Target to Complete Budget Hearings
March 12	JFAC Target to Complete Budget Setting
March 21	Sine Die Target

SENATORS

29 Republicans / 6 Democrats

(All area codes are 208 unless otherwise noted)

	District	Page
Adams, Ben (R), Nampa.....	12	24
332-1336 Rm: WW27		
Anthon, Kelly Arthur (R), Rupert.....	27	39
332-1300 Rm: W331		
Bernt, Treg A. (R), Meridian.....	21	33
332-1331 Rm: WG45		
Bjerke, Carl J. (R), Coeur d'Alene.....	5	17
332-1421 Rm: WG44		
Blaylock, Camille (R), Caldwell.....	11	23
332-1320 Rm: WG11		
Burtenshaw, Van T. (R), Terreton.....	31	43
332-1342 Rm: WW37		
Carlson, Cindy J. (R), Riggins.....	7	19
332-1355 Rm: WG33		
Cook, Kevin (R), Idaho Falls.....	32	44
332-1358 Rm: WW28		
Den Hartog, Lori (R), Meridian.....	22	34
332-1305 Rm: W330		
Foreman, Daniel D. (R), Moscow.....	6	18
332-1405 Rm: WW46		
Galloway, Codi (R), Boise.....	15	27
332-1407 Rm: WG36		
Grow, C. Scott (R), Eagle.....	14	26
332-1334 Rm: C305		
Guthrie, Jim (R), McCammon.....	28	40
332-1348 Rm: WW42		
Harris, Mark (R), Soda Springs.....	35	47
332-1308 Rm: W428		
Hart, Phil (R), Kellogg.....	2	14
332-1345 Rm: WG37		
Keyser, Josh (R), Meridian.....	20	32
332-1354 Rm: WG54		
Kohl, Joshua (R), Twin Falls.....	25	37
332-1318 Rm: WG55		
Lakey, Todd M. (R), Nampa.....	23	35
332-1328 Rm: WW48		

SENATORS

(All area codes are 208 unless otherwise noted)

	District	Page
Lenney, Brian (R), Nampa.....	13	25
332-1329 Rm: WG34		
Lent, Dave (R), Idaho Falls.....	33	45
332-1313 Rm: WW39		
Nichols, Tammy (R), Middleton.....	10	22
332-1423 Rm: WW31		
Okuniewicz, Doug (R), Hayden.....	3	15
332-1338 Rm: WW33		
Rabe, Alison "Ali" (D), Boise.....	16	28
332-1409 Rm: WG03		
Ricks, Doug (R), Rexburg.....	34	46
332-1301 Rm: WW50		
Ruchti, James D. (D), Pocatello.....	29	41
332-1411 Rm: W406		
Semmelroth, Carrie (D), Boise.....	17	29
332-1352 Rm: WG02		
Shippy, Brandon (R), New Plymouth.....	9	21
332-1325 Rm: WG35		
Taylor, Ron C. (D), Hailey.....	26	38
332-1353 Rm: WG12		
Toews, Ben (R), Coeur d'Alene.....	4	16
332-1304 Rm: W435		
VanOrden, Julie (R), Pingree.....	30	42
332-1346 Rm: WW35		
Ward-Engelking, Janie (D), Boise.....	18	30
332-1412 Rm: W405		
Wintrow, Melissa (D), Boise.....	19	31
332-1410 Rm: W303		
Woodward, James W. "Jim" (R), Sagle.....	1	13
332-1349 Rm: WW30		
Zito, Christy (R), Mountain Home.....	8	20
332-1344 Rm: WG04		
Zuiderveld, Glenneda (R), Twin Falls.....	24	36
332-1347 Rm: WG06		

REPRESENTATIVES

61 Republicans / 9 Democrats

(All area codes are 208 unless otherwise noted)

	District	Page
Achilles, Theodore B. "Todd" (D), Boise.....	16	28
332-1075 Rm: E424		
Alfieri, Joe (R), Coeur d'Alene.....	4	16
332-1065 Rm: E140		
Andrus, Kevin (R), Lava Hot Springs.....	35	47
332-1045 Rm: EW11		
Barbieri, Vito (R), Dalton Gardens.....	3	15
332-1177 Rm: EW08		
Beiswenger, Robert "Rob" (R), Horseshoe Bend.....	8	20
332-1181 Rm: E112A		
Berch, Steve (D), Boise.....	15	27
332-1039 Rm: E423		
Boyle, Judy (R), Midvale.....	9	21
332-1064 Rm: E133		
Bruce, Chris (R), Kuna.....	23	35
332-1055 Rm: E137		
Burgoyne, Tanya (R), Pocatello.....	29	41
332-1031 Rm: E139		
Cannon, David M. (R), Blackfoot.....	30	42
332-1086 Rm: EW54		
Cayler, Lucas B. (R), Caldwell.....	11	23
332-1044 Rm: E150A		
Cheatum, Richard W. "Rick" (R), Pocatello.....	28	40
332-1046 Rm: E111B		
Church, Monica C. (D), Boise.....	19	31
332-1078 Rm: EG24		
Clow, Lance W. (R), Twin Falls.....	25	37
332-1188 Rm: EW49		
Cornilles, Jeff J. (R), Nampa.....	12	24
332-1033 Rm: EG67		
Crane, Brent (R), Nampa.....	13	25
332-1058 Rm: EW46		
Crane, Jaron (R), Nampa.....	12	24
332-1059 Rm: E401		
Dygert, Shawn (R), Melba.....	23	35
332-1047 Rm: EG54		

REPRESENTATIVES

(All area codes are 208 unless otherwise noted)

	District	Page
Egbert, Megan (D), Boise.....	17	29
332-1049 Rm: EG47		
Ehardt, Barbara (R), Idaho Falls.....	33	45
332-1189 Rm: EW16		
Ehlers, Jeff (R), Meridian.....	21	33
332-1072 Rm: EW12		
Erickson, Marco Adam (R), Idaho Falls.....	33	45
332-1073 Rm: E115		
Fuhriman, Ben G. (R), Shelley.....	30	42
332-1038 Rm: EG60		
Furniss, Rod (R), Rigby.....	31	43
332-1056 Rm: E105		
Galaviz, Sofía R. (D), Boise.....	16	28
332-1083 Rm: EG32		
Gannon, John (D), Boise.....	17	29
332-1082 Rm: EG38		
Garner, Dan (R), Clifton.....	28	40
332-1081 Rm: EG62		
Green, Brooke (D), Boise.....	18	30
332-1080 Rm: EG36		
Handy, Clay (R), Burley.....	27	39
332-1074 Rm: EG63		
Harris, Kyle (R), Lewiston.....	7	19
332-1133 Rm: EG51		
Hawkins, Dale R. (R), Fernwood.....	2	14
332-1070 Rm: EG65		
Healey, Dori (R), Boise.....	15	27
332-1176 Rm: E147		
Hill, Edward H. "Ted" (R), Eagle.....	14	26
332-1124 Rm: E158		
Holtzclaw, James (R), Meridian.....	20	32
332-1041 Rm: EW08		
Horman, Wendy (R), Idaho Falls.....	32	44
332-1071 Rm: C316		
Hostetler, Clint (R), Twin Falls.....	24	36
332-1024 Rm: E159		

REPRESENTATIVES

(All area codes are 208 unless otherwise noted)

	District	Page
Leavitt, David J. (R), Twin Falls.....	25	37
332-1182 Rm: E150		
Manwaring, Dustin (R), Pocatello.....	29	41
332-1079 Rm: E101		
Marmon, Kent (R), Caldwell.....	11	23
332-1052 Rm: EG57		
Mathias, Chris (D), Boise.....	19	31
332-1076 Rm: EG37		
McCann, Lori (R), Lewiston.....	6	18
332-1184 Rm: E104		
Mendive, Ron (R), Coeur d'Alene.....	5	17
332-1040 Rm: EW62		
Mickelsen, Stephanie Jo (R), Idaho Falls.....	32	44
332-1042 Rm: EG61		
Miller, Steve (R), Fairfield.....	24	36
332-1061 Rm: E141		
Mitchell, Brandon (R), Moscow.....	6	18
332-1175 Rm: E102		
Monks, Jason A. (R), Meridian.....	22	34
332-1036 Rm: E307		
Moyle, Mike (R), Star.....	10	22
332-1122 Rm: E303		
Nelsen, Jack (R), Jerome.....	26	38
332-1032 Rm: EG64		
Palmer, Joe A. (R), Meridian.....	20	32
332-1062 Rm: EW60		
Petzke, James (R), Meridian.....	21	33
332-1043 Rm: EG02		
Pickett, Douglas T. (R), Oakley.....	27	39
332-1123 Rm: EW58		
Pohanka, Mike J. (R), Jerome.....	26	38
332-1174 Rm: EG53		
Price, Elaine (R), Coeur d'Alene.....	4	16
332-1048 Rm: EG50		
Rasor, Cornel (R), Sagle.....	1	13
332-1185 Rm: EG52		

REPRESENTATIVES

(All area codes are 208 unless otherwise noted)

	District	Page
Raybould, Britt (R), Rexburg.....	34	46
332-1173 Rm: E109		
Raymond, Jerald (R), Menan.....	31	43
332-1183 Rm: E110A		
Redman, Jordan (R), Coeur d'Alene.....	3	15
332-1180 Rm: E135A		
Rubel, Ilana (D), Boise.....	18	30
332-1034 Rm: E329		
Sauter, Mark (R), Sandpoint.....	1	13
332-1035 Rm: E157		
Scott, Heather (R), Blanchard.....	2	14
332-1190 Rm: E134		
Shepherd, Charlie (R), Pollock.....	7	19
332-1067 Rm: E113		
Shirts, John (R), Weiser.....	9	21
332-1166 Rm: EG55		
Skaug, Bruce D. (R), Nampa.....	10	22
332-1178 Rm: EW56		
Tanner, Josh (R), Eagle.....	14	26
332-1057 Rm: E406		
Tanner, Steve C. (R), Nampa.....	13	25
332-1063 Rm: E138B		
Thompson, Faye (R), McCall.....	8	20
332-1054 Rm: EG58		
Vander Woude, John (R), Nampa.....	22	34
332-1037 Rm: EW14		
Weber, Jon O. (R), Rexburg.....	34	46
332-1053 Rm: E103		
Wheeler, Josh (R), Ammon.....	35	47
332-1179 Rm: E111A		
Wisniewski, Tony (R), Post Falls.....	5	17
332-1060 Rm: E142		

DISTRICT 1

(All area codes are 208 unless otherwise noted)

BONNER & BOUNDARY COUNTIES



James W. "Jim" Woodward (R) - Senate

1st Term

(Served 2 terms, Senate 2018-2022)

Address: PO Box 151, Sagle 83860

Phone: (o) 332-1349 (Session Only)
(h) 946-7963

E-mail: JWoodward@senate.idaho.gov
Business Owner

Wife - Brenda

Committees: VICE CHAIR-Finance;
Education



Mark Sauter (R) - House Seat A

2nd Term

Address: PO Box 1031, Sandpoint 83864

Phone: (o) 332-1035 (Session Only)
(h) 254-1184

E-mail: MSauter@house.idaho.gov
Fire Service (Retired)

Wife - Jane

Committees: Agricultural Affairs;
Education; Resources & Conservation



Cornel Razor (R) - House Seat B

2nd Term

Address: 170 Preston Parker Lane,
Sagle 83860

Phone: (o) 332-1185 (Session Only)
(h) 290-7403

E-mail: CRazor@house.idaho.gov
Business Owner

Wife - Kim

Committees: Business; Health & Welfare;
Local Government

DISTRICT 2

(All area codes are 208 unless otherwise noted)

BENEWAH, CLEARWATER, KOOTENAI, SHOSHONE, BONNER COUNTIES

Phil Hart (R) - Senate

2nd Term

(Served 4 terms, House 2004-2012)

Address: PO Box 540, Kellogg 83837

Phone: (o) 332-1345 (Session Only)

(h) 772-2522 (b) 772-2522

(f) 772-1881

E-mail: Phil.Hart@senate.idaho.gov

Structural Engineer

Committees: VICE CHAIR-Resources &
Environment; Finance; Transportation



Heather Scott (R) - House Seat A

6th Term

Address: PO Box 134, Blanchard 83804

Phone: (o) 332-1190 (Session Only)

(h) 332-1190

E-mail: HScott@house.idaho.gov

Aquatic Biologist

Husband - Andrew

Committees: VICE CHAIR-State Affairs;
Environment, Energy & Technology;
Judiciary, Rules & Administration



Dale R. Hawkins (R) - House Seat B

2nd Term

Address: PO Box 245, Fernwood 83830

Phone: (o) 332-1070 (Session Only)

(h) 568-1275

E-mail: DHawkins@house.idaho.gov

Small Business Owner/Retired

Wife - Debra

Committees: VICE CHAIR-Education;
Judiciary, Rules & Administration; Local
Government



DISTRICT 3
KOOTENAI COUNTY

(All area codes are 208 unless otherwise noted)



Doug Okuniewicz (R) - Senate

2nd Term

(Served 1 term, House 2020-2022)

Address: PO Box 810, Hayden 83835

Phone: (o) 332-1338 (Session Only)
(h) 918-1495

E-mail: DougO@senate.idaho.gov
IP Management/Small Business Owner
Wife - Lori

Committees: CHAIR-Transportation;
Resources & Environment



Vito Barbieri (R) - House Seat A

8th Term

Address: 564 E Prairie Ave,
Dalton Gardens 83815

Phone: (o) 332-1177 (Session Only)
(h) 620-0873

E-mail: VBar@house.idaho.gov
Attorney (Retired)
Wife - Joy

Committees: CHAIR-Environment, Energy
& Technology; Business; Ethics and House
Policy; State Affairs



Jordan Redman (R) - House Seat B

2nd Term

Address: 1410 Lincoln Way,
Coeur d'Alene 83814

Phone: (o) 332-1180 (Session Only)
(h) 252-5070

E-mail: JRedman@house.idaho.gov
Business Owner
Wife - Amy

Committees: VICE CHAIR-Business;
Environment, Energy & Technology; Health
& Welfare

DISTRICT 4

(All area codes are 208 unless otherwise noted)

KOOTENAI COUNTY



Ben Toews (R) - Senate

2nd Term

Majority Caucus Chair

Address: 911 N 5th St,

Coeur d'Alene 83814

Phone: (o) 332-1322 (Session Only)

(h) 209-7791

E-mail: BToews@senate.idaho.gov

Entrepreneur

Wife - Elisha

Committees: Local Government &
Taxation; State Affairs



Joe Alfieri (R) - House Seat A

2nd Term

Address: PO Box78,

Coeur d'Alene 83816

Phone: (o) 332-1065 (Session Only)

(h) 699-0021

E-mail: JAlfieri@house.idaho.gov

Wife - Caroline

Committees: VICE CHAIR-Judiciary, Rules
& Administration; Local Government; State
Affairs



Elaine Price (R) - House Seat B

2nd Term

Address: 1107 E Sherman Ave,

Coeur d'Alene 83814

Phone: (o) 332-1048 (Session Only)

(h) 654-3228

E-mail: EPrice@house.idaho.gov

Small Business Owner

Husband - Richard

Committees: Appropriations; Local
Government

DISTRICT 5
KOOTENAI COUNTY

(All area codes are 208 unless otherwise noted)



Carl J. Bjerke (R) - Senate

2nd Term

Address: 212 W Ironwood Dr,
Coeur d'Alene 83814

Phone: (o) 332-1421 (Session Only)
(h) 704-0925 (b) 704-0925

E-mail: CBjerke@senate.idaho.gov
Deputy Chief SMFD (Retired)

Wife - Lesli

Committees: VICE CHAIR-Health &
Welfare; Finance

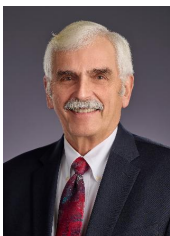

Ron Mendive (R) - House Seat A

7th Term

Address: 3732 S Dusty Ln,
Coeur d'Alene 83814

Phone: (o) 332-1040 (Session Only)
(h) 667-9330

E-mail: RMendive@house.idaho.gov
Self-employed, Construction and Land
Services (Semi-retired)

Wife - Sherlene

Committees: CHAIR-Resources &
Conservation; Agricultural Affairs;
Education



Tony Wisniewski (R) - House Seat B

4th Term

Address: PO Box 2483, Post Falls 83854

Phone: (o) 332-1060 (Session Only)
(h) 889-3437

E-mail: TWisniewski@house.idaho.gov
Engineer (Retired)/Small Business Owner
Wife - Melody

Committees: VICE CHAIR-Commerce &
Human Resources; Education;
Environment, Energy & Technology

DISTRICT 6

(All area codes are 208 unless otherwise noted)

LATAH, LEWIS, NEZ PERCE COUNTIES

Daniel D. Foreman (R) - Senate

2nd Term

(Served 1 term, Senate 2016-2018)

Address: PO Box 8254, Moscow 83843

Phone: (o) 332-1405 (Session Only)

(h) 332-1405

E-mail: DForeman@senate.idaho.gov

USAF Colonel/Idaho Law Enforcement
(Retired)

Wife - Maria

Committees: CHAIR-Commerce & Human
Resources; Judiciary & Rules



Lori McCann (R) - House Seat A

3rd Term

Address: 1027 Bryden Avenue,
Lewiston 83501

Phone: (o) 332-1184 (Session Only)

(h) 743-5517 (b) 743-5517

E-mail: LMcCann@house.idaho.gov

Bus. Owner, Cattle Rancher, Real Estate,
and Ret LCSC Professor

Husband - William

Committees: Agricultural Affairs;
Commerce & Human Resources; Health &
Welfare



Brandon Mitchell (R) - House Seat B

3rd Term

Address: PO Box 8897, Moscow 83843

Phone: (o) 332-1175 (Session Only)

(h) 596-5001

E-mail: BMitchell@house.idaho.gov

Small Business Owner

Wife - Marcie

Committees: VICE CHAIR-Transportation
& Defense; Appropriations



DISTRICT 7

(All area codes are 208 unless otherwise noted)

ADAMS, IDAHO, NEZ PERCE COUNTIES



Cindy J. Carlson (R) - Senate

2nd Term

Address: 1525 Big Salmon Rd,
Riggins 83549

Phone: (o) 332-1355 (Session Only)
(h) 494-2633

E-mail: CCarlson@senate.idaho.gov
Business Owner

Husband - Guy

Committees: Education; Finance



Kyle Harris (R) - House Seat A

1st Term

Address: 2308 12th Avenue,
Lewiston 83501

Phone: (o) 332-1133 (Session Only)

E-mail: KHarris@house.idaho.gov

Electrical Contractor

Wife - Kristina

Committees: Business; Education;
Transportation & Defense



Charlie Shepherd (R) - House Seat B

3rd Term

Address: PO Box 293, Pollock 83547

Phone: (o) 332-1067 (Session Only)
(h) 859-0023

E-mail: CShepherd@house.idaho.gov

SRJSD243 Maintenance Supervisor

Wife - Susan

Committees: VICE CHAIR-Resources &
Conservation; Revenue & Taxation;
Transportation & Defense

DISTRICT 8

(All area codes are 208 unless otherwise noted)

BOISE, VALLEY, ELMORE, CUSTER COUNTIES**Christy Zito (R) - Senate**1st Term

(Served 2 terms, House 2016-2020)

(Served 1 term, Senate 2020-2022)

Address: 1065 N 15th East,
Mountain Home 83647**Phone:** (o) 332-1344 (Session Only)
(h) 590-4633**E-mail:** CZito@senate.idaho.gov

Retired

Committees: VICE CHAIR-Agricultural
Affairs; Commerce & Human Resources;
Education**Robert "Rob" Beiswenger (R) - House
Seat A**1st Term**Address:** PO Box 293,
Horseshoe Bend 83629**Phone:** (o) 332-1181 (Session Only)**E-mail:** RBeiswenger@house.idaho.gov

Money Metals Specialist

Wife - Crystal

Committees: Agricultural Affairs;
Commerce & Human Resources; Health &
Welfare**Faye Thompson (R) - House Seat B**1st Term**Address:** 13828 Shadow Ridge,
McCall 83638**Phone:** (o) 332-1054 (Session Only)
(h) 634-6569**E-mail:** FThompson@house.idaho.gov

Retired

Husband - Neal

Committees: Business; Environment,
Energy & Technology; Health & Welfare

DISTRICT 9

(All area codes are 208 unless otherwise noted)

PAYETTE, WASHINGTON, CANYON COUNTIES



Brandon Shippy (R) - Senate

2nd Term

Address: 4095 Highway 30 W,
New Plymouth 83655

Phone: (o) 332-1325 (Session Only)
(h) 332-1325

E-mail: BShippy@senate.idaho.gov
Small Business Owner

Wife - Rakel

Committees: VICE CHAIR-Judiciary &
Rules; Health & Welfare; State Affairs



John Shirts (R) - House Seat A

1st Term

Address: PO Box 509, Weiser 83672

Phone: (o) 332-1166 (Session Only)
(b) 550-3190

E-mail: JShirts@house.idaho.gov
Attorney/U.S. Air Force Reserve JAG
Officer

Wife - Mercedes

Committees: Agricultural Affairs; Judiciary,
Rules & Administration; Revenue &
Taxation



Judy Boyle (R) - House Seat B

9th Term

Address: PO Box 57, Midvale 83645

Phone: (o) 332-1064 (Session Only)
(h) 355-3225 (b) 355-3225

E-mail: JBoyle@house.idaho.gov
Agriculture and Writer

Committees: Resources & Conservation;
State Affairs; Transportation & Defense

DISTRICT 10

(All area codes are 208 unless otherwise noted)

ADA & CANYON COUNTIES

Tammy Nichols (R) - Senate

2nd Term

(Served 2 terms, House 2018-2022)

Address: PO Box 651, Middleton 83644

Phone: (o) 332-1423 (Session Only)

(h) 917-2409

E-mail: TNichols@senate.idaho.gov

Small Business Owner

Committees: CHAIR-Agricultural Affairs;
Commerce & Human Resources; Education



Mike Moyle (R) - House Seat A

14th Term

Speaker of the House

Address: 480 N Plummer Rd, Star 83669

Phone: (o) 332-1122 (Session Only)

(b) 286-7842

E-mail: MMoyle@house.idaho.gov

Agribusiness

Wife - Janet



Bruce D. Skaug (R) - House Seat B

3rd Term

Address: 1226 E Karcher Rd,

Nampa 83687

Phone: (o) 332-1178 (Session Only)

(h) 466-0030

E-mail: BSkaug@house.idaho.gov

Attorney (Retired)

Wife - Debra

Committees: CHAIR-Judiciary, Rules &
Administration; Local Government; State
Affairs



**DISTRICT 11
CANYON COUNTY**

(All area codes are 208 unless otherwise noted)



Camille Blaylock (R) - Senate

1st Term

Address: 2317 Terrace Drive,
Caldwell 83605

Phone: (o) 332-1320 (Session Only)

E-mail: CBlaylock@senate.idaho.gov

Husband - Jacob

Committees: Agricultural Affairs; Health &
Welfare



Kent Marmon (R) - House Seat A

1st Term

Address: 1924 Fillmore Street,
Caldwell 83605

Phone: (o) 332-1052 (Session Only)

(h) 841-3850

E-mail: KMarmon@house.idaho.gov

Retired

Wife - Sylvia

Committees: Business; Education



Lucas B. Cayler (R) - House Seat B

1st Term

Address: 1924 Brock Avenue,
Caldwell 83605

Phone: (o) 332-1044 (Session Only)

E-mail: LCayler@house.idaho.gov

Service Technician

Committees: Commerce & Human
Resources; Health & Welfare; Local
Government

**DISTRICT 12
CANYON COUNTY**

(All area codes are 208 unless otherwise noted)



Ben Adams (R) - Senate

2nd Term

(Served 1 term, House 2020-2022)

Address: 1921 Hoover Street,
Nampa 83686

Phone: (o) 332-1336 (Session Only)
(h) 546-9393

E-mail: BAdams@senate.idaho.gov
Public Speaker

Wife - Rebecca

Committees: VICE CHAIR-Local
Government & Taxation; State Affairs;
Transportation



Jeff J. Cornilles (R) - House Seat A

2nd Term

Address: 1313 W Raelin Drive,
Nampa 83686

Phone: (o) 332-1033 (Session Only)
(h) 880-3562 (b) 880-3562

E-mail: JCornilles@house.idaho.gov
Life and Employee Benefits Sales

Wife - Keriann

Committees: VICE CHAIR-Local
Government; Business; Revenue &
Taxation



Jaron Crane (R) - House Seat B

2nd Term

Majority Caucus Chair

Address: PO Box 1804, Nampa 83653

Phone: (o) 332-1059 (Session Only)
(h) 812-2059

E-mail: JCrane@house.idaho.gov
Business Owner

Wife - Clarissa

Committees: Business; State Affairs;
Transportation & Defense; Ways & Means

**DISTRICT 13
CANYON COUNTY**

(All area codes are 208 unless otherwise noted)



Brian Lenney (R) - Senate

2nd Term

Address: PO Box 3753,
Nampa 83653-3753

Phone: (o) 332-1329 (Session Only)
(h) 614-1289

E-mail: BLenney@senate.idaho.gov

Committees: VICE CHAIR-Commerce &
Human Resources; Health & Welfare;
Judiciary & Rules



Brent Crane (R) - House Seat A

10th Term

Address: PO Box 86, Nampa 83653

Phone: (o) 332-1058 (Session Only)
(b) 466-0613

E-mail: BCrane@house.idaho.gov

Co Owner - Crane Alarm Service
Wife - Rochenda

Committees: CHAIR-Ethics and House
Policy; CHAIR-State Affairs; Business



Steve C. Tanner (R) - House Seat B

1st Term

Address: 3800 E Man O'War Drive,
Nampa 83686

Phone: (o) 332-1063 (Session Only)

E-mail: STanner@house.idaho.gov
Database Programmer/Analyst (Retired)

Wife - Kathleen

Committees: Commerce & Human
Resources; Education; Environment,
Energy & Technology

GEM & ADA COUNTIES

C. Scott Grow (R) - Senate

5th Term

Address: 4250 W Sugarberry Ct,
Eagle 83616

Phone: (o) 332-1334 (Session Only)
(h) 870-4000

E-mail: SGrow@senate.idaho.gov
Retired CPA/Business Owner

Wife - Rhonda

Committees: CHAIR-Finance; Local
Government & Taxation



Edward H. "Ted" Hill (R) - House Seat A

2nd Term

Address: 2488 E Windrose Street,
Eagle 83616

Phone: (o) 332-1124 (Session Only)
(h) 332-1124

E-mail: THill@house.idaho.gov

Airline Pilot

Wife - Heidi

Committees: Judiciary, Rules &
Administration; Revenue & Taxation;
Transportation & Defense



Josh Tanner (R) - House Seat B

2nd Term

Assistant Majority Leader

Address: PO BOX 125, Eagle 83616

Phone: (o) 332-1057 (Session Only)
(h) 781-5211

E-mail: JTanner@house.idaho.gov

Business Owner

Wife - Dominique

Committees: Appropriations; Resources &
Conservation; Ways & Means



**DISTRICT 15
ADA COUNTY**

(All area codes are 208 unless otherwise noted)



Codi Galloway (R) - Senate

1st Term

(Served 1 term, House 2020-2022)

Address: 13579 W Annabrook Dr,
Boise 83713

Phone: (o) 332-1407 (Session Only)
(h) 614-2634

E-mail: CGalloway@senate.idaho.gov
Business Owner

Husband - Scott

Committees: Finance; Transportation



Steve Berch (D) - House Seat A

4th Term

Assistant Minority Leader

Address: PO Box 4903, Boise 83711

Phone: (o) 332-1039 (Session Only)
(h) 890-9339

E-mail: SBerch@house.idaho.gov
Businessman

Committees: Business; Local Government;
Revenue & Taxation; Ways & Means



Dori Healey (R) - House Seat B

2nd Term

Address: 8059 W Preece Dr, Suite 1106,
Boise 83704

Phone: (o) 332-1176 (Session Only)
(h) 718-0464

E-mail: DHealey@house.idaho.gov
Clinical Nurse Specialist and Business
Owner

Husband - Patrick

Committees: Commerce & Human
Resources; Health & Welfare; Local
Government

**DISTRICT 16
ADA COUNTY**

(All area codes are 208 unless otherwise noted)



Alison "Ali" Rabe (D) - Senate

2nd Term

(Served 1 term, Senate 2020-2021)

Address: PO Box 190405, Boise 83719

Phone: (o) 332-1409 (Session Only)
(h) 332-1409

E-mail: ARabe@senate.idaho.gov
Executive Director - Jesse Tree
Husband - Riley Hickox

Committees: Local Government &
Taxation; Transportation



Soñia R. Galaviz (D) - House Seat A

2nd Term

Address: PO Box 7096, Boise 83707

Phone: (o) 332-1083 (Session Only)
(h) 332-1083

E-mail: SGalaviz@house.idaho.gov
Educator

Committees: Appropriations; Environment,
Energy & Technology; Resources &
Conservation



**Theodore B. "Todd" Achilles (D) - House
Seat B**

2nd Term

Minority Caucus Chair

Address: PO Box 8912, Boise 83707

Phone: (o) 332-1075 (Session Only)
(h) 332-1075 (b) 254-0002

E-mail: TAchilles@house.idaho.gov
University Educator

Wife - Robyn

Committees: Agricultural Affairs;
Commerce & Human Resources; State
Affairs; Ways & Means

**DISTRICT 17
ADA COUNTY**

(All area codes are 208 unless otherwise noted)



Carrie Semmelroth (D) - Senate

3rd Term

Address: 4224 W Fairmont Street,
Boise 83706

Phone: (o) 332-1352 (Session Only)
(h) 332-1352

E-mail: CSemmelroth@senate.idaho.gov
Higher Education

Partner - Graham Wright

Committees: Agricultural Affairs;
Education; Transportation



John Gannon (D) - House Seat A

7th Term

(Served 1 term, House 1990-1992)

Address: 1104 S Johnson St, Boise 83705

Phone: (o) 332-1082 (Session Only)
(h) 343-1608 (b) 433-0629

E-mail: JGannon@house.idaho.gov
Attorney

Wife - Bev

Committees: Ethics and House Policy;
Judiciary, Rules & Administration; Revenue
& Taxation; Transportation & Defense



Megan Egbert (D) - House Seat B

2nd Term

Address: 1630 S. Rand St., Boise 83709

Phone: (o) 332-1049 (Session Only)

E-mail: MEgbert@house.idaho.gov
Law Student

Husband - Mike Stefancic

Committees: Commerce & Human
Resources; Environment, Energy &
Technology; Health & Welfare

**DISTRICT 18
ADA COUNTY**

(All area codes are 208 unless otherwise noted)



Janie Ward-Engelking (D) - Senate

7th Term

(Served 1 term, House 2012-2013)

Minority Caucus Chair

Address: 3578 S Crosspoint Ave,
Boise 83706

Phone: (o) 332-1425 (Session Only)
(h) 861-6434

E-mail:

JWardEngelking@senate.idaho.gov

Teacher (Retired)

Husband - Kay Frank Engelking

Committees: Commerce & Human
Resources; Education; Finance



Ilana Rubel (D) - House Seat A

7th Term

Minority Leader

Address: 2750 Migratory Dr, Boise 83706

Phone: (o) 332-1034 (Session Only)
(h) 866-4776

E-mail: IRubel@house.idaho.gov

Attorney

Committees: Environment, Energy &
Technology; Health & Welfare; Judiciary,
Rules & Administration; Ways & Means



Brooke Green (D) - House Seat B

4th Term

Address: 3727 E Shady Glen Drive,
Boise 83706

Phone: (o) 332-1080 (Session Only)
(h) 332-1080

E-mail: BGreen@house.idaho.gov

Associate Transportation Planner

Husband - Jeremy Byington

Committees: Business; Ethics and House
Policy; State Affairs; Transportation &
Defense

**DISTRICT 19
ADA COUNTY**

(All area codes are 208 unless otherwise noted)



Melissa Wintrow (D) - Senate

3rd Term

(Served 3 terms, House 2014-2020)

Minority Leader

Address: PO Box 83720,
Boise 83720-0081

Phone: (o) 332-1339 (Session Only)
(h) 332-1339

E-mail: MWintrow@senate.idaho.gov
Education

Committees: Finance; Health & Welfare;
Judiciary & Rules



Monica C. Church (D) - House Seat A

1st Term

Address: PO Box 8843, Boise 83707

Phone: (o) 332-1078 (Session Only)
(h) 340-2605

E-mail: MChurch@house.idaho.gov
Public School Educator

Husband - Chad

Committees: Education; Local
Government; Resources & Conservation



Chris Mathias (D) - House Seat B

3rd Term

Address: PO Box 8753, Boise 83707

Phone: (o) 332-1076 (Session Only)
(h) 332-1076

E-mail: CMathias@house.idaho.gov
Self-employed

Wife - Katie

Committees: Agricultural Affairs;
Education; Ethics and House Policy;
Judiciary, Rules & Administration

**DISTRICT 20
ADA COUNTY**

(All area codes are 208 unless otherwise noted)



Josh Keyser (R) - Senate

1st Term

Address: PO Box 1602, Meridian 83680

Phone: (o) 332-1354 (Session Only)

(h) 332-1354

E-mail: JKeyser@senate.idaho.gov

Businessman

Committees: VICE CHAIR-Transportation;
Health & Welfare; Judiciary & Rules



Joe A. Palmer (R) - House Seat A

9th Term

Address: 1524 N Meridian Rd,

Meridian 83642

Phone: (o) 332-1062 (Session Only)

(h) 332-1062

E-mail: JPalmer@house.idaho.gov

Self-employed

Wife - Leslie

Committees: CHAIR-Transportation &
Defense; Business; State Affairs



James Holtzclaw (R) - House Seat B

7th Term

Address: 1740 E Fairview Avenue,

Meridian 83642

Phone: (o) 332-1041 (Session Only)

(h) 284-9542

E-mail: JHoltzclaw@house.idaho.gov

Real Estate Broker/Small Business Owner

Wife - Luisa

Committees: CHAIR-Commerce & Human
Resources; State Affairs; Transportation &
Defense

**DISTRICT 21
ADA COUNTY**

(All area codes are 208 unless otherwise noted)



Treg A. Bernt (R) - Senate

2nd Term

Address: 531 S Tiburon Ave,
Meridian 83642

Phone: (o) 332-1331 (Session Only)
(h) 917-2883

E-mail: TBernt@senate.idaho.gov
Small Business Owner

Wife - Tiffanie

Committees: VICE CHAIR-State Affairs;
Commerce & Human Resources; Local
Government & Taxation



James Petzke (R) - House Seat A

2nd Term

Address: 2628 S Afleet Ave,
Meridian 83642

Phone: (o) 332-1043 (Session Only)
(h) 450-5615

E-mail: JPetzke@house.idaho.gov
Business Owner

Fiancée - Haley

Committees: Appropriations; Resources &
Conservation; Transportation & Defense



Jeff Ehlers (R) - House Seat B

2nd Term

Address: 3313 W Cherry Lane #1024,
Meridian 83642

Phone: (o) 332-1072 (Session Only)
(h) 278-2818

E-mail: JEhlers@house.idaho.gov
CFO/CPA/Small Business Owner

Wife - Karla

Committees: CHAIR-Ways & Means;
Agricultural Affairs; Business; Revenue &
Taxation

**DISTRICT 22
ADA COUNTY**

(All area codes are 208 unless otherwise noted)



Lori Den Hartog (R) - Senate

6th Term

Majority Leader

Address: PO Box 267, Meridian 83680

Phone: (o) 332-1340 (Session Only)
(h) 779-2022

E-mail: LDenHartog@senate.idaho.gov
Homemaker

Husband - Scott

Committees: Local Government &
Taxation; State Affairs



John Vander Woude (R) - House Seat A

8th Term

(Served 1 term, House 2006-2008)

Address: 5311 Ridgewood Rd,
Nampa 83687

Phone: (o) 332-1037 (Session Only)
(h) 888-4210

E-mail: JVanderWoude@house.idaho.gov
Farmer

Wife - Judy

Committees: CHAIR-Health & Welfare;
Environment, Energy & Technology;
Resources & Conservation



Jason A. Monks (R) - House Seat B

7th Term

Majority Leader

Address: 3865 S Black Cat Rd,
Meridian 83687

Phone: (o) 332-1036 (Session Only)
(h) 884-8684

E-mail: JMonks@house.idaho.gov
Small Business Owner

Wife - Shelley

Committees: Business; Revenue &
Taxation; Transportation & Defense; Ways
& Means

DISTRICT 23

(All area codes are 208 unless otherwise noted)

OWYHEE, CANYON, ADA COUNTIES



Todd M. Lakey (R) - Senate

7th Term

Address: 12905 Venezia Ct,
Nampa 83651

Phone: (o) 332-1328 (Session Only)
(h) 908-4415 (b) 908-4415

E-mail: TLakey@senate.idaho.gov
Attorney

Wife - Jan

Committees: CHAIR-Judiciary & Rules;
Agricultural Affairs; Commerce & Human
Resources



Chris Bruce (R) - House Seat A

1st Term

Address: 742 N Kerogen Place,
Kuna 83634

Phone: (o) 332-1055 (Session Only)

E-mail: CBruce@house.idaho.gov
Mortgage Loan Officer

Wife - Kyrsti

Committees: Commerce & Human
Resources; Environment, Energy &
Technology; Revenue & Taxation



Shawn Dygert (R) - House Seat B

1st Term

Address: 17404 Highway 78,
Melba 83641

Phone: (o) 332-1047 (Session Only)

E-mail: SDygert@house.idaho.gov
Retired Agri-Educ Teacher/FFA Advisor

Wife - Annette

Committees: Agricultural Affairs;
Resources & Conservation; State Affairs

DISTRICT 24

(All area codes are 208 unless otherwise noted)

CAMAS, GOODING, TWIN FALLS COUNTIES



Glenneda Zuiderveld (R) - Senate

2nd Term

Address: PO Box 3123,
Twin Falls 83303

Phone: (o) 332-1347 (Session Only)
(h) 280-0716

E-mail: GZuiderveld@senate.idaho.gov

Self-employed
Husband - Tom

Committees: Finance; Health & Welfare



Clint Hostetler (R) - House Seat A

1st Term

Address: PO Box 2192, Twin Falls 83303

Phone: (o) 332-1024 (Session Only)

E-mail: CHostetler@house.idaho.gov

Small Business Owner

Wife - Dannielle

Committees: Judiciary, Rules &
Administration; State Affairs



Steve Miller (R) - House Seat B

2nd Term

(Served 3 terms, House 2012-2018)

Address: 1208 E 200 N, Fairfield 83327

Phone: (o) 332-1061 (Session Only)
(h) 332-1061

E-mail: SMiller@house.idaho.gov

Farmer/Rancher

Wife - Cheryl

Committees: VICE CHAIR-Appropriations;
Agricultural Affairs; Resources &
Conservation

DISTRICT 25
TWIN FALLS COUNTY

(All area codes are 208 unless otherwise noted)



Joshua Kohl (R) - Senate

1st Term

Address: 255 Blue Lakes Blvd N #559,
Twin Falls 83301

Phone: (o) 332-1318 (Session Only)

E-mail: JKohl@senate.idaho.gov

Engineer

Committees: Agricultural Affairs;
Resources & Environment; Transportation



Lance W. Clow (R) - House Seat A

7th Term

Address: 2170 Bitterroot Dr,
Twin Falls 83301

Phone: (o) 332-1188 (Session Only)
(h) 733-5767

E-mail: LClow@house.idaho.gov

Personal Financial Advisor (Retired)

Wife - DeeDee

Committees: CHAIR-Business; Education;
Transportation & Defense



David J. Leavitt (R) - House Seat B

1st Term

Address: 1213 Park Meadows Drive,
Twin Falls 83301

Phone: (o) 332-1182 (Session Only)

E-mail: DLeavitt@house.idaho.gov

Retired Military

Committees: Agricultural Affairs;
Commerce & Human Resources; Health &
Welfare

DISTRICT 26

(All area codes are 208 unless otherwise noted)

BLAINE, LINCOLN, JEROME COUNTIES**Ron C. Taylor (D) - Senate**2nd Term**Address:** 419 South 2nd Ave,
Hailey 83333**Phone:** (o) 332-1353 (Session Only)
(h) 831-1726**E-mail:** RTaylor@senate.idaho.gov

Retired

Wife - Alex

Committees: Agricultural Affairs; Local
Government & Taxation; Resources &
Environment**Mike J. Pohanka (R) - House Seat A**1st Term**Address:** 489 Sunridge Drive,
Jerome 83338**Phone:** (o) 332-1174 (Session Only)**E-mail:** MPohanka@house.idaho.gov

Wife - Susan

Committees: Judiciary, Rules &
Administration; State Affairs; Transportation
& Defense**Jack Nelsen (R) - House Seat B**2nd Term**Address:** 253 E 650 N, Jerome 83338**Phone:** (o) 332-1032 (Session Only)
(h) 320-1921**E-mail:** JNelsen@house.idaho.gov

Retired

Wife - Emily

Committees: Agricultural Affairs;
Education; Resources & Conservation

DISTRICT 27

(All area codes are 208 unless otherwise noted)

CASSIA, MINIDOKA, ONEIDA COUNTIES



Kelly Arthur Anthon (R) - Senate

6th Term

President Pro Tempore

Address: PO Box 76, Rupert 83350

Phone: (o) 332-1327 (Session Only)
(h) 654-4099

E-mail: KAnthon@senate.idaho.gov
Attorney/City Administrator

Wife - Joelle

Committees: Local Government &
Taxation; State Affairs



Douglas T. Pickett (R) - House Seat A

2nd Term

Address: 625 W 1700 S, Oakley 83346

Phone: (o) 332-1123 (Session Only)
(h) 862-3387

E-mail: DPickett@house.idaho.gov
Rancher

Wife - Brady

Committees: CHAIR-Education;
Agricultural Affairs; Resources &
Conservation



Clay Handy (R) - House Seat B

2nd Term

Address: 29 S 150 E, Burley 83318

Phone: (o) 332-1074 (Session Only)
(h) 332-1074

E-mail: CHandy@house.idaho.gov
Wife - Kristine Hansen

Committees: Appropriations; Judiciary,
Rules & Administration; Transportation &
Defense

DISTRICT 28

(All area codes are 208 unless otherwise noted)

BANNOCK, FRANKLIN, POWER COUNTIES

Jim Guthrie (R) - Senate

7th Term

(Served 1 term, House 2010-2012)

Address: 320 S Marsh Creek Rd,
McCammon 83250

Phone: (o) 332-1348 (Session Only)
(h) 251-9303

E-mail: JGuthrie@senate.idaho.gov
Rancher/Business Owner

Committees: CHAIR-State Affairs;
Commerce & Human Resources;
Resources & Environment



Richard W. "Rick" Cheatum (R) - House Seat A

2nd Term

Address: 2475 Ada Street,
Pocatello 83201

Phone: (o) 332-1046 (Session Only)
(h) 339-2629

E-mail: RCheatum@house.idaho.gov
Retired

Wife - Debra

Committees: Commerce & Human
Resources; Local Government; Revenue &
Taxation



Dan Garner (R) - House Seat B

2nd Term

Address: PO Box 43, Clifton 83228

Phone: (o) 332-1081 (Session Only)
(h) 244-0999

E-mail: DGarner@house.idaho.gov
Farmer/Rancher

Wife - Sherri-Jo

Committees: Agricultural Affairs;
Education; Judiciary, Rules &
Administration



DISTRICT 29
BANNOCK COUNTY

(All area codes are 208 unless otherwise noted)



James D. Ruchti (D) - Senate

2nd Term

(Served 2 terms, House 2006-2010

Served 1 term, House 2020-2022)

Assistant Minority Leader

Address: PO Box 6046, Pocatello 83205

Phone: (o) 332-1406 (Session Only)

(h) 251-4104

E-mail: JRuchti@senate.idaho.gov

Attorney

Wife - Wendy

Committees: Commerce & Human Resources; Judiciary & Rules; State Affairs



Dustin Manwaring (R) - House Seat A

3rd Term

(Served 1 term, House 2016-2018)

Address: 1469 W Quinn Road,

Pocatello 83202

Phone: (o) 332-1079 (Session Only)

(h) 252-5295

E-mail: DManwaring@house.idaho.gov

Attorney

Wife - Whitney

Committees: Appropriations; Resources & Conservation



Tanya Burgoyne (R) - House Seat B

1st Term

Address: 1400 E Cedar Street,

Pocatello 83201

Phone: (o) 332-1031 (Session Only)

(h) 252-5502

E-mail: TBurgoyne@house.idaho.gov

Wife/Mother/Homemaker

Committees: Commerce & Human Resources; Environment, Energy & Technology; Health & Welfare

DISTRICT 30

(All area codes are 208 unless otherwise noted)

BINGHAM & BUTTE COUNTIES**Julie VanOrden (R) - Senate**3rd Term

(Served 3 terms, House 2012-2018)

Address: 425 S 1100 W, Pingree 83262**Phone:** (o) 332-1346 (Session Only)

(h) 684-4052

E-mail: JVanOrden@senate.idaho.gov

Agribusiness Co-owner/Homemaker

Husband - Garth

Committees: CHAIR-Health & Welfare;

Agricultural Affairs; Resources &

Environment

**David M. Cannon (R) - House Seat A**3rd Term**Address:** 75 E Judicial St,

Blackfoot 83221

Phone: (o) 332-1086 (Session Only)

(h) 332-1086

E-mail: DCannon@house.idaho.gov

Criminal Defense Attorney

Wife - Lisa

Committees: CHAIR-Revenue & Taxation;

Agricultural Affairs; Business

**Ben G. Fuhriman (R) - House Seat B**1st Term**Address:** PO Box 478, Shelley 83274**Phone:** (o) 332-1038 (Session Only)

(h) 821-7227 (f) (888) 424-7608

E-mail: BFuhriman@house.idaho.gov

Business Owner/Financial Advisor

Wife - Holli

Committees: Commerce & Human

Resources; Environment, Energy &

Technology; Health & Welfare



DISTRICT 31

(All area codes are 208 unless otherwise noted)

CLARK, FREMONT, JEFFERSON, LEMHI COUNTIES**Van T. Burtenshaw (R) - Senate**4th Term

(Served 2 terms, House 2014-2018)

Address: PO Box 130, Terreton 83450**Phone:** (o) 332-1342 (Session Only)

(h) 663-4607

E-mail: VBurtenshaw@senate.idaho.gov

Farmer/Rancher

Wife - Joan "Joni" Marie

Committees: CHAIR-Resources & Environment; Education; Transportation**Jerald Raymond (R) - House Seat A**2nd Term

(Served 1 term, House 2018-2020)

Address: 3352 E 750 North, Menan 83434**Phone:** (o) 332-1183 (Session Only)

(h) 497-2745

E-mail: JRaymond@house.idaho.gov

Rancher/Livestock Consultant

Wife - Cheri

Committees: VICE CHAIR-Agricultural Affairs; Resources & Conservation; Revenue & Taxation**Rod Furniss (R) - House Seat B**4th Term**Address:** 346 North 4456 East,
Rigby 83442**Phone:** (o) 332-1056 (Session Only)

(h) 589-1100

E-mail: RFurniss@house.idaho.gov

Insurance Sales/Land Developer

Wife - Jan

Committees: VICE CHAIR-Environment, Energy & Technology; Appropriations

DISTRICT 32
BONNEVILLE COUNTY

(All area codes are 208 unless otherwise noted)



Kevin Cook (R) - Senate

3rd Term

Address: 1184 E Lazy Lane,
Idaho Falls 83404

Phone: (o) 332-1358 (Session Only)
(h) 521-6776

E-mail: KCook@senate.idaho.gov
Software Engineer

Wife - Cheri

Committees: VICE CHAIR-Education;
Finance; Resources & Environment



Stephanie Jo Mickelsen (R) - House Seat A

2nd Term

Address: 9088 N River Rd,
Idaho Falls 83402

Phone: (o) 332-1042 (Session Only)
(h) 715-7770

E-mail: SMickelsen@house.idaho.gov
CFO Mickelsen Farms, LLC

Husband - Mark

Committees: Resources & Conservation;
State Affairs; Transportation & Defense



Wendy Horman (R) - House Seat B

7th Term

Address: 1860 Heather Circle,
Idaho Falls 83406

Phone: (o) 332-1071 (Session Only)
(h) 522-4387

E-mail: WendyHorman@house.idaho.gov
Small Business Owner

Husband - Briggs

Committees: CHAIR-Appropriations;
Environment, Energy & Technology

DISTRICT 33
BONNEVILLE COUNTY

(All area codes are 208 unless otherwise noted)



Dave Lent (R) - Senate

4th Term

Address: 1186 Caysie Circle,
Idaho Falls 83402

Phone: (o) 332-1313 (Session Only)
(h) 521-0716

E-mail: DLent@senate.idaho.gov
Nuclear Facility Training Manager (Retired)
Wife - Terri

Committees: CHAIR-Education;
Agricultural Affairs; Judiciary & Rules



Barbara Ehardt (R) - House Seat A

5th Term

Address: 961 J St, Idaho Falls 83402

Phone: (o) 332-1189 (Session Only)
(h) 332-1189

E-mail: BEhardt@house.idaho.gov
Manager - Athletic Club

Committees: CHAIR-Local Government;
Education; Judiciary, Rules &
Administration



Marco Adam Erickson (R) - House Seat B

3rd Term

Address: 646 Crestview Ave,
Idaho Falls 83402

Phone: (o) 332-1073 (Session Only)
(h) 241-5665

E-mail: MErickson@house.idaho.gov
Coalition Program Director

Wife - Emily
Committees: VICE CHAIR-Health &
Welfare; Judiciary, Rules & Administration;
Local Government

DISTRICT 34
MADISON COUNTY

(All area codes are 208 unless otherwise noted)



Doug Ricks (R) - Senate

3rd Term

(Served 1 term, House 2018-2020)

Address: 140 S 3rd East, Rexburg 83440

Phone: (o) 332-1301 (Session Only)

(h) 557-9665

E-mail: DRicks@senate.idaho.gov

Self-employed

Wife - Melissa

Committees: CHAIR-Local Government & Taxation; Judiciary & Rules



Jon O. Weber (R) - House Seat A

3rd Term

Address: 64 E Main St, Rexburg 83440

Phone: (o) 332-1053 (Session Only)

(h) 390-6128

E-mail: JWeber@house.idaho.gov

Small Business Owner

Wife - Heather

Committees: VICE CHAIR-Revenue & Taxation; Commerce & Human Resources; Local Government



Britt Raybould (R) - House Seat B

2nd Term

(Served 1 term, House 2018-2020)

Address: PO Box 653, Rexburg 83440

Phone: (o) 332-1173 (Session Only)

(h) 419-0768 (b) 419-0768

E-mail: BRaybould@house.idaho.gov

Farmer/CFO/Business Strategy

Committees: Environment, Energy & Technology; Ethics and House Policy; Resources & Conservation; Revenue & Taxation

DISTRICT 35

(All area codes are 208 unless otherwise noted)

**BANNOCK, BEAR LAKE, BONNEVILLE, CARIBOU,
TETON COUNTIES****Mark Harris (R) - Senate**6th Term**Assistant Majority Leader****Address:** 1619 Eight Mile Creek Rd,
Soda Springs 83276**Phone:** (o) 332-1429 (Session Only)
(h) 547-3360**E-mail:** MHarris@senate.idaho.gov
Rancher

Wife - Cheryl

Committees: Health & Welfare; Resources
& Environment; State Affairs**Kevin Andrus (R) - House Seat A**4th Term**Address:** 6948 E Old Oregon Trail Rd,
Lava Hot Springs 83246**Phone:** (o) 332-1045 (Session Only)
(h) 240-0201**E-mail:** KAndrus@house.idaho.gov
Rancher/Horse Trainer

Wife - Shelby

Committees: CHAIR-Agricultural Affairs;
Resources & Conservation; Revenue &
Taxation**Josh Wheeler (R) - House Seat B**2nd Term**Address:** 1849 S Foothill Rd,
Ammon 83401**Phone:** (o) 332-1179 (Session Only)
(h) 360-3926**E-mail:** JoshWheeler@house.idaho.gov
Contractor

Wife - Laramie Linning Wheeler

Committees: Business; Health & Welfare;
Local Government

CENTRAL GARDEN LEVEL

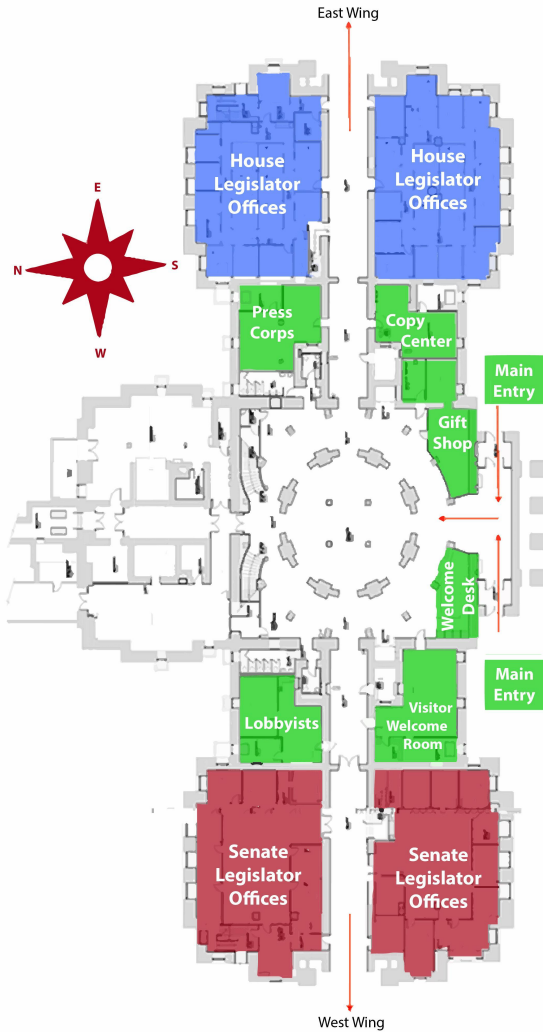

SENATE WEST WING

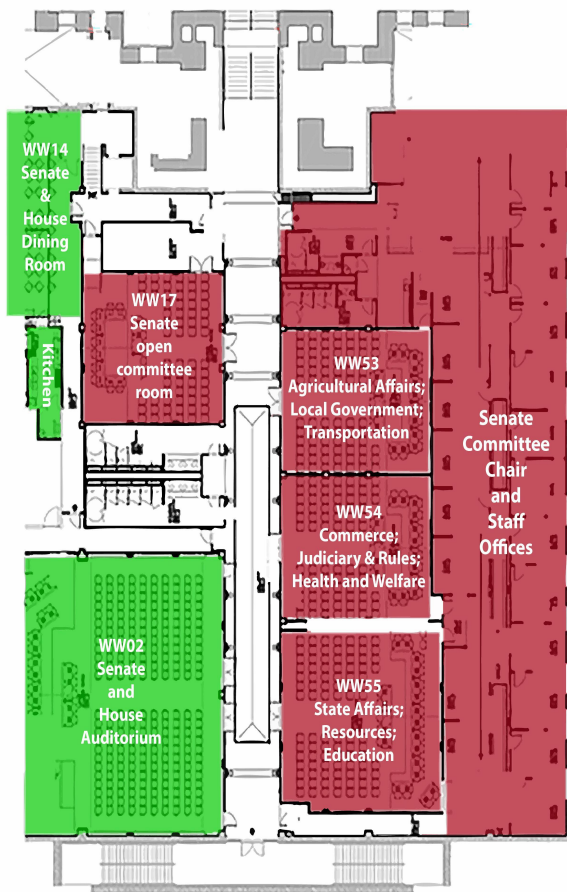

HOUSE EAST WING

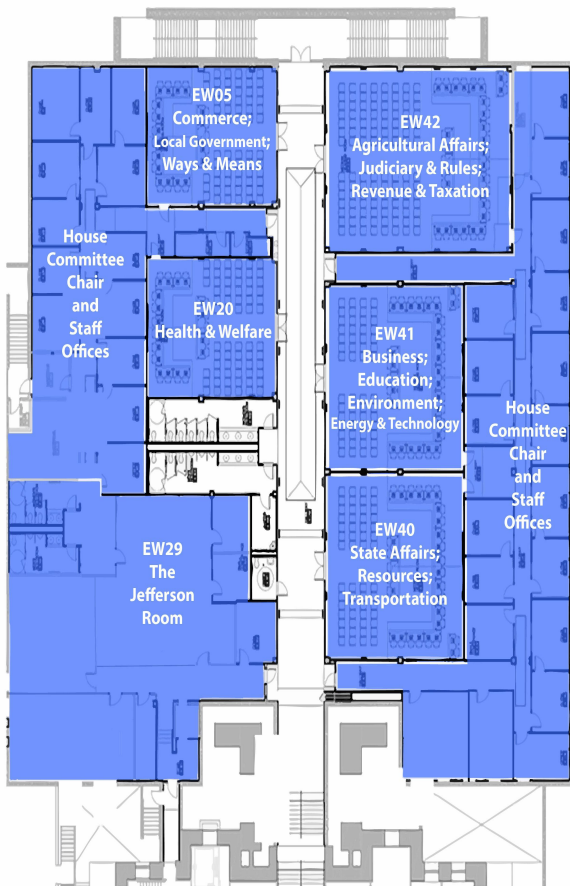

FIRST FLOOR

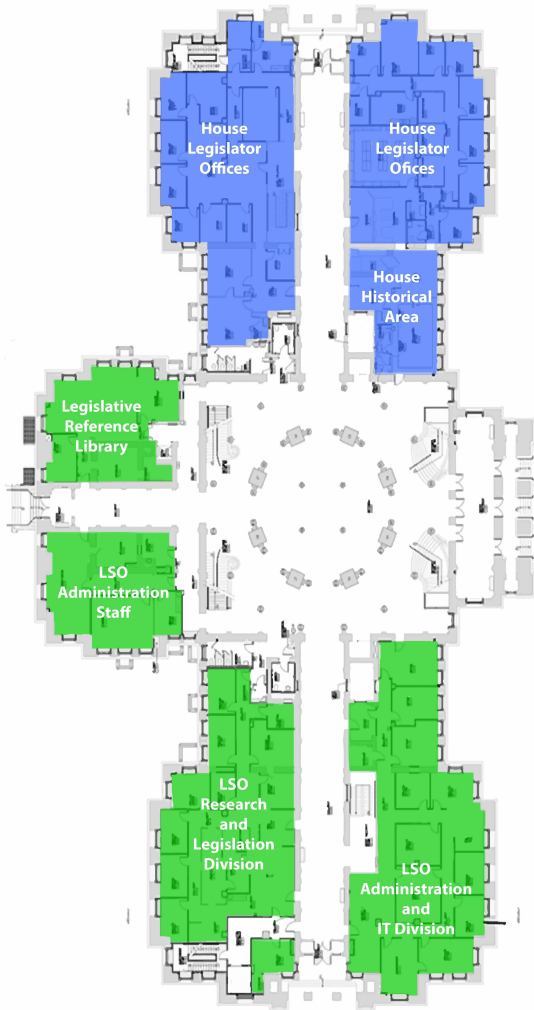

SECOND FLOOR

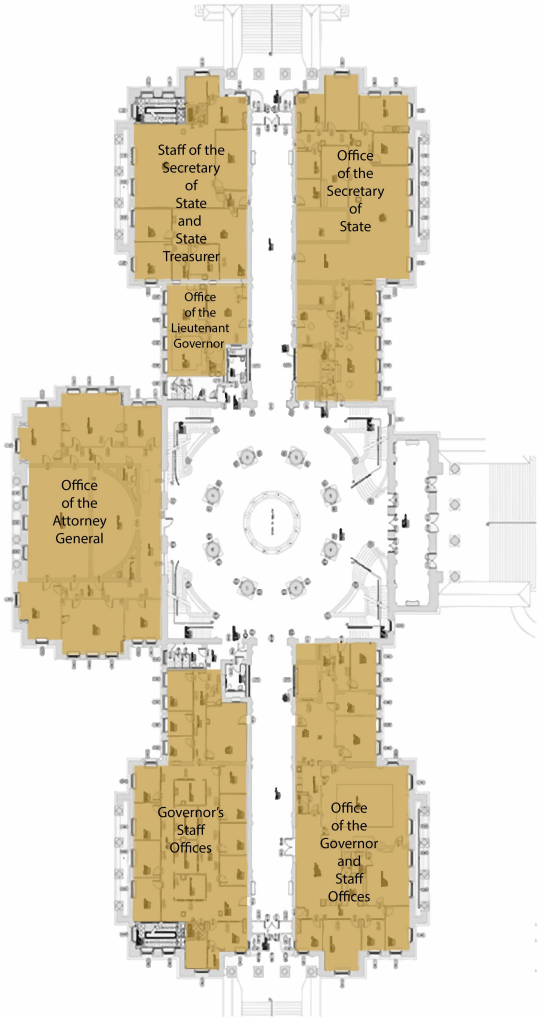

THIRD FLOOR

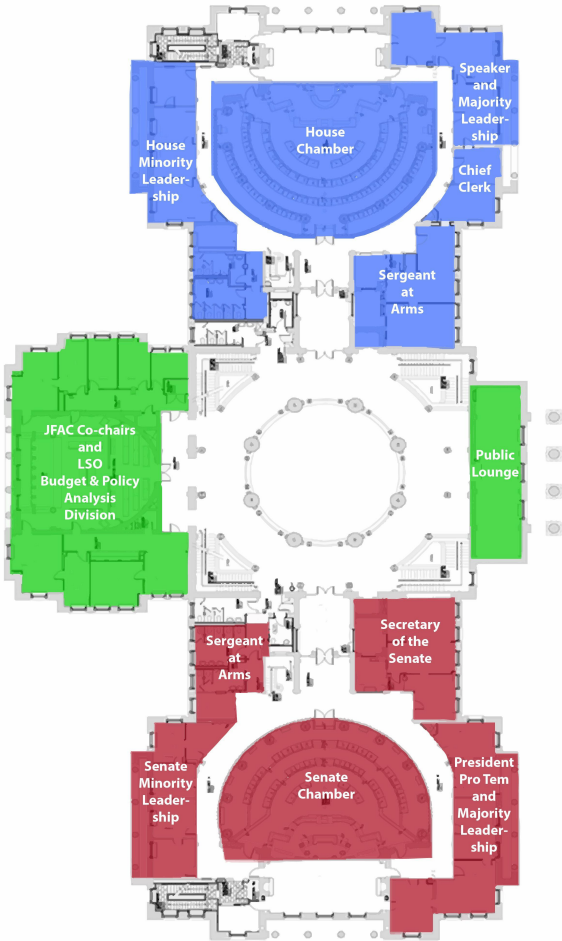

FOURTH FLOOR

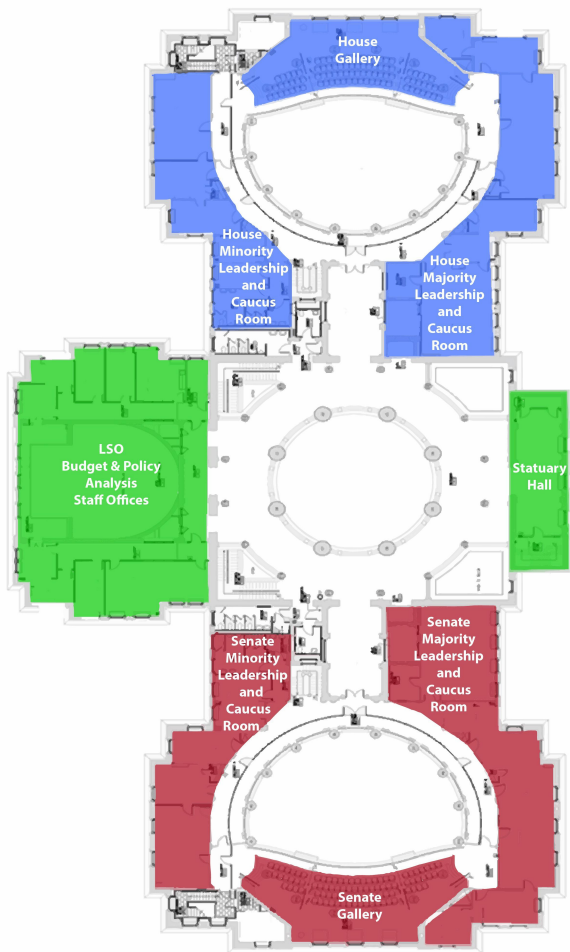

(All area codes are 208 unless otherwise noted)

SENATE COMMITTEES	Meeting Room - Day - Time
Agricultural Affairs Secretary: Rachel Verrette, Ph: 332-1330	Rm WW53 - T, Th - 8:00 am
Commerce & Human Resources Secretary: Linda Kambeitz, Ph: 332-1333	Rm WW54 - T, Th - 1:30 pm
Education Secretary: Savahanna Phelan, Ph: 332-1321	Rm WW55 - M, T, W, Th - 3:00 pm
Finance Secretary: Linsy Heiner, Ph: 334-4735	Rm C310 - Daily - 8:00 am
Health & Welfare Secretary: Rebecca Kozlowski, Ph: 332-1319	Rm WW54 - M, T, W, Th - 3:00 pm
Judiciary & Rules Secretary: Sharon Pennington, Ph: 332-1317	Rm WW54 - M, W, F - 1:30 pm
Local Government & Taxation Secretary: Meg Lawless, Ph: 332-1315	Rm WW53 - T, W, Th - 3:00 pm
Resources & Environment Secretary: Shelly Johnson, Ph: 332-1323	Rm WW55 - M, W, F - 1:30 pm
State Affairs Secretary: Kathryn Wells, Ph: 332-1326	Rm WW55 - M, W, F - 8:00 am
Transportation Secretary: Melissa Price, Ph: 332-1332	Rm WW53 - T, Th - 1:30 pm
HOUSE COMMITTEES	Meeting Room - Day - Time
Agricultural Affairs Secretary: Jayne Feik, Ph: 332-1137	Rm EW42 - Even Days - 1:30 pm
Appropriations Secretary: Alyson Jackson, Ph: 334-4736	Rm C310 - Daily - am
Business Secretary: Michelle Anderson, Ph: 332-1139	Rm EW41 - Odd Days - 1:30 pm
Commerce & Human Resources Secretary: Wendy Carver-Herbert, Ph: 332-1149	Rm EW05 - Odd Days - 1:30 pm
Education Secretary: Amy Bengtzen, Ph: 332-1148	Rm EW41 - Daily - 9:00 am
Environment, Energy & Technology Secretary: Wendy Carver-Herbert, Ph: 332-1128	Rm EW41 - Even Days - 1:30 pm
Health & Welfare Secretary: Irene Moore, Ph: 332-1138	Rm EW20 - Daily - 9:00 am
Judiciary, Rules & Administration Secretary: Nancy Conrad, Ph: 332-1127	Rm EW42 - Odd Days - 1:30 pm
Local Government Secretary: Elijah Phipps, Ph: 332-1147	Rm EW05 - Even Days - 1:30 pm
Resources & Conservation Secretary: Andrea Blades, Ph: 332-1136	Rm EW40 - Odd Days - 1:30 pm
Revenue & Taxation Secretary: Cameron Douglas, Ph: 332-1125	Rm EW42 - Daily - 9:00 am
State Affairs Secretary: Liaza Richardson, Ph: 332-1145	Rm EW40 - Daily - 9:00 am
Transportation & Defense Secretary: Tracey McDonnell, Ph: 332-1146	Rm EW40 - Even Days - 1:30 pm
Ways & Means Secretary: Kyra Swearingen, Ph: 332-1159	Rm EW05 - On Call - pm

(All area codes are 208 unless otherwise noted)

SENATE COMMITTEES

AGRICULTURAL AFFAIRS Meeting Room WW53
(9) T, Th 8:00 am
sagri@senate.idaho.gov Capitol Mall Cable Ch. 5.2

TAMMY NICHOLS, Chairman
CHRISTY ZITO, Vice Chairman

Todd Lakey Carrie Semmelroth
Dave Lent Ron Taylor
Julie VanOrden
Camille Blaylock
Joshua Kohl
Secretary: Rachel Verrette Rm WW31, Ph: 332-1330

COMMERCE & HUMAN Meeting Room WW54
RESOURCES (9) T, Th 1:30 pm
scom@senate.idaho.gov Capitol Mall Cable Ch. 5.3

DANIEL FOREMAN, Chairman
BRIAN LENNEY, Vice Chairman

Todd Lakey Janie Ward-Engelking
Jim Guthrie James Ruchti
Tammy Nichols
Treg Bernt
Christy Zito
Secretary: Linda Kambeitz Rm WW46, Ph: 332-1333

EDUCATION (9) Meeting Room WW55
M, T, W, Th 3:00 pm
sedu@senate.idaho.gov Capitol Mall Cable Ch. 6.1

DAVE LENT, Chairman
KEVIN COOK, Vice Chairman

Jim Woodward Janie Ward-Engelking
Tammy Nichols Carrie Semmelroth
Cindy Carlson
Van Burtenshaw
Christy Zito
Secretary: Savahanna Phelan Rm WW39, Ph: 332-1321

FINANCE (10)

Meeting Room C310

Daily 8:00 am

sfin@senate.idaho.gov

Capitol Mall Cable Ch. 3.3

C. SCOTT GROW, Chairman

JIM WOODWARD, Vice Chairman

Kevin Cook

Janie Ward-Engelking

Carl Bjerke

Melissa Wintrow

Phil Hart

Cindy Carlson

Glenneda Zuiderveld

Codi Galloway

Secretary: Linsy Heiner

Rm C305, Ph: 334-4735

HEALTH & WELFARE (9)

Meeting Room WW54

M, T, W, Th 3:00 pm

shel@senate.idaho.gov

Capitol Mall Cable Ch. 5.3

JULIE VANORDEN, Chairman

CARL BJERKE, Vice Chairman

Mark Harris

Melissa Wintrow

Glenneda Zuiderveld

Brian Lenney

Brandon Shippy

Camille Blaylock

Josh Keyser

Secretary: Rebecca Kozlowski

Rm WW35, Ph: 332-1319

JUDICIARY & RULES (9)

Meeting Room WW54

M, W, F 1:30 pm

sjud@senate.idaho.gov

Capitol Mall Cable Ch. 5.3

TODD LAKEY, Chairman

BRANDON SHIPPY, Vice Chairman

Doug Ricks

Melissa Wintrow

Daniel Foreman

James Ruchti

Dave Lent

Brian Lenney

Josh Keyser

Secretary: Sharon Pennington

Rm WW48, Ph: 332-1317

**LOCAL GOVERNMENT &
TAXATION (9)**

Meeting Room WW53

T, W, Th 3:00 pm

sloc@senate.idaho.gov

Capitol Mall Cable Ch. 5.2

DOUG RICKS, Chairman

BEN ADAMS, Vice Chairman

C. Scott Grow

Ali Rabe

Kelly Arthur Anthon

Ron Taylor

Treg Bernt

Lori Den Hartog

Ben Toews

Secretary: Meg Lawless

Rm WW50, Ph: 332-1315

**RESOURCES &
ENVIRONMENT (9)**

Meeting Room WW55

M, W, F 1:30 pm

sres@senate.idaho.gov

Capitol Mall Cable Ch. 6.1

VAN BURTONSHAW, Chairman

PHIL HART, Vice Chairman

Jim Guthrie

Ron Taylor

Mark Harris

Doug Okuniewicz

Kevin Cook

Julie VanOrden

Joshua Kohl

Secretary: Shelly Johnson

Rm WW37, Ph: 332-1323

STATE AFFAIRS (9)

Meeting Room WW55

M, W, F 8:00 am

sstaf@senate.idaho.gov

Capitol Mall Cable Ch. 6.1

JIM GUTHRIE, Chairman

TREG BERNT, Vice Chairman

Kelly Arthur Anthon

James Ruchti

Mark Harris

Ben Toews

Lori Den Hartog

Ben Adams

Brandon Shippy

Secretary: Kathryn Wells

Rm WW42, Ph: 332-1326

(All area codes are 208 unless otherwise noted)

TRANSPORTATION (9)

Meeting Room WW53

T, Th 1:30 pm

stran@senate.idaho.gov

Capitol Mall Cable Ch. 5.2

DOUG OKUNIEWICZ, Chairman

JOSH KEYSER, Vice Chairman

Van Burtenshaw

Ali Rabe

Phil Hart

Carrie Semmelroth

Ben Adams

Codi Galloway

Joshua Kohl

Secretary: Melissa Price

Rm WW33, Ph: 332-1332

(All area codes are 208 unless otherwise noted)

HOUSE COMMITTEES

AGRICULTURAL AFFAIRS Meeting Room EW42
(17) Even Days 1:30 pm
hagri@house.idaho.gov Capitol Mall Cable Ch. 4.2

KEVIN ANDRUS, Chairman

JERALD RAYMOND, Vice Chairman

David Cannon

Chris Mathias

Lori McCann

Todd Achilles

Jeff Ehlers

Dan Garner

Jack Nelsen

Douglas Pickett

Mark Sauter

Steve Miller

Rob Beiswenger

Shawn Dygert

David Leavitt

Ron Mendive

John Shirts

Secretary: Jayne Feik

Rm EW11, Ph: 332-1137

APPROPRIATIONS (10) Meeting Room C310
Daily am
happ@house.idaho.gov Capitol Mall Cable Ch. 3.3

WENDY HORMAN, Chairman

STEVE MILLER, Vice Chairman

Rod Furniss

Sofia Galaviz

Clay Handy

James Petzke

Josh Tanner

Dustin Manwaring

Brandon Mitchell

Elaine Price

Secretary: Alyson Jackson

Rm C316, Ph: 334-4736

BUSINESS (17)

Meeting Room EW41

Odd Days 1:30 pm

hbus@house.idaho.gov Capitol Mall Cable Ch. 96.2

LANCE CLOW, Chairman

JORDAN REDMAN, Vice Chairman

Brent Crane

Steve Berch

Joe Palmer

Brooke Green

Vito Barbieri

Jeff Cornilles

Jaron Crane

Jeff Ehlers

Jason Monks

David Cannon

Kyle Harris

Kent Marmon

Cornel Rasor

Faye Thompson

Josh Wheeler

Secretary: Michelle Anderson

Rm EW49, Ph: 332-1139

**COMMERCE & HUMAN
RESOURCES (15)**

Meeting Room EW05

Odd Days 1:30 pm

hcom@house.idaho.gov Capitol Mall Cable Ch. 6.2

JAMES HOLTZCLAW, Chairman

TONY WISNIEWSKI, Vice Chairman

Jon Weber

Megan Egbert

Lori McCann

Todd Achilles

Rick Cheatum

Dori Healey

Rob Beiswenger

Chris Bruce

Tanya Burgoyne

Lucas Cayler

Ben Fuhriman

David Leavitt

Steve Tanner

Secretary: Wendy Carver-Herbert

Rm EW08, Ph: 332-1149

EDUCATION (14)

Meeting Room EW41

Daily 9:00 am

hedu@house.idaho.gov Capitol Mall Cable Ch. 96.2

DOUGLAS PICKETT, Chairman

DALE HAWKINS, Vice Chairman

Lance Clow

Chris Mathias

Ron Mendive

Monica Church

Barbara Ehardt

Tony Wisniewski

Dan Garner

Jack Nelsen

Mark Sauter

Kyle Harris

Kent Marmon

Steve Tanner

Secretary: Amy Bengtzen

Rm EW58, Ph: 332-1148

**ENVIRONMENT, ENERGY &
TECHNOLOGY (16)**

Meeting Room EW41

Even Days 1:30 pm

henv@house.idaho.gov Capitol Mall Cable Ch. 96.2

VITO BARBIERI, Chairman

ROD FURNISS, Vice Chairman

John Vander Woude

Ilana Rubel

Wendy Horman

Megan Egbert

Heather Scott

Sofia Galaviz

Tony Wisniewski

Britt Raybould

Jordan Redman

Chris Bruce

Tanya Burgoyne

Ben Fuhrman

Steve Tanner

Faye Thompson

Secretary: Wendy Carver-Herbert

Rm EW08, Ph: 332-1128

(All area codes are 208 unless otherwise noted)

HEALTH & WELFARE (15) Meeting Room EW20
Daily 9:00 am
hhel@house.idaho.gov Capitol Mall Cable Ch. 6.3

JOHN VANDER WOUDE, Chairman

MARCO ERICKSON, Vice Chairman

Dori Healey

Ilana Rubel

Jordan Redman

Megan Egbert

Josh Wheeler

Rob Beiswenger

Tanya Burgoyne

Lucas Cayler

Ben Fuhriman

David Leavitt

Lori McCann

Cornel Rasor

Faye Thompson

Secretary: Irene Moore

Rm EW14, Ph: 332-1138

JUDICIARY, RULES & ADMINISTRATION (15) Meeting Room EW42
Odd Days 1:30 pm
hjud@house.idaho.gov Capitol Mall Cable Ch. 4.2

BRUCE SKAUG, Chairman

JOE ALFIERI, Vice Chairman

Heather Scott

John Gannon

Barbara Ehardt

Chris Mathias

Marco Erickson

Ilana Rubel

Dan Garner

Clay Handy

Dale Hawkins

Ted Hill

Clint Hostetler

Mike Pohanka

John Shirts

Secretary: Nancy Conrad

Rm EW56, Ph: 332-1127

LOCAL GOVERNMENT (15) Meeting Room EW05
Even Days 1:30 pm
hloc@house.idaho.gov Capitol Mall Cable Ch. 6.2

BARBARA EHARDT, Chairman

JEFF CORNILLES, Vice Chairman

Marco Erickson

Steve Berch

Bruce Skaug

Monica Church

Jon Weber

Joe Alfieri

Rick Cheatum

Dale Hawkins

Dori Healey

Elaine Price

Lucas Cayler

Cornel Rasor

Josh Wheeler

Secretary: Elijah Phipps

Rm EW16, Ph: 332-1147

RESOURCES & CONSERVATION (18) Meeting Room EW40
Odd Days 1:30 pm
hres@house.idaho.gov Capitol Mall Cable Ch. 96.1

RON MENDIVE, Chairman

CHARLIE SHEPHERD, Vice Chairman

Judy Boyle

Sofía Galaviz

John Vander Woude

Monica Church

Dustin Manwaring

Britt Raybould

Stephanie Mickelsen

Jack Nelsen

Douglas Pickett

Jerald Raymond

Josh Tanner

Steve Miller

Kevin Andrus

Shawn Dygert

James Petzke

Mark Sauter

Secretary: Andrea Blades

Rm EW62, Ph: 332-1136

REVENUE & TAXATION (15) Meeting Room EW42
Daily 9:00 am
hrev@house.idaho.gov Capitol Mall Cable Ch. 4.2

DAVID CANNON, Chairman

JON WEBER, Vice Chairman

Charlie Shepherd

John Gannon

Rick Cheatum

Steve Berch

Jeff Cornilles

Jeff Ehlers

Jason Monks

Jerald Raymond

Kevin Andrus

Chris Bruce

Ted Hill

Britt Raybould

John Shirts

Secretary: Cameron Douglas

Rm EW54, Ph: 332-1125

STATE AFFAIRS (15) Meeting Room EW40
Daily 9:00 am
hstaf@house.idaho.gov Capitol Mall Cable Ch. 96.1

BRENT CRANE, Chairman

HEATHER SCOTT, Vice Chairman

Joe Palmer

Todd Achilles

Vito Barbieri

Brooke Green

James Holtzclaw

Bruce Skaug

Joe Alfieri

Jaron Crane

Judy Boyle

Shawn Dygert

Clint Hostetler

Stephanie Mickelsen

Mike Pohanka

Secretary: Liaza Richardson

Rm EW46, Ph: 332-1145

(All area codes are 208 unless otherwise noted)

**TRANSPORTATION &
DEFENSE (16)**

htran@house.idaho.gov

Meeting Room EW40

Even Days 1:30 pm

Capitol Mall Cable Ch. 96.1

JOE PALMER, Chairman

BRANDON MITCHELL, Vice Chairman

James Holtzclaw

John Gannon

Jason Monks

Brooke Green

Charlie Shepherd

Jaron Crane

Clay Handy

Ted Hill

James Petzke

Judy Boyle

Lance Clow

Kyle Harris

Stephanie Mickelsen

Mike Pohanka

Secretary: Tracey McDonnell

Rm EW60, Ph: 332-1146

WAYS & MEANS (7)

hway@house.idaho.gov

Meeting Room EW05

On Call pm

Capitol Mall Cable Ch. 6.2

JEFF EHLERS, Chairman

Jason Monks

Ilana Rubel

Josh Tanner

Steve Berch

Jaron Crane

Todd Achilles

Secretary: Kyra Swearingen

Rm EW12, Ph: 332-1159

LEGISLATIVE ATTACHÉS & SUPPORT STAFF

(All area codes are 208 unless otherwise noted)

- A -

Abdulsalm, Rasak (700 W. State St.).....	334-4824
Admin Asst to Pro Tem (W331).....	332-1302
Aggers, Patrick (700 W. State St.).....	334-4865
Agricultural Affairs - House.....	332-1137
Agricultural Affairs - Senate.....	332-1330
Anderson, Michelle (EW49).....	332-1139
Andrulis, Ingrid (EG29).....	332-1131
Application Development (W118).....	334-4849
Appropriations - House.....	334-4736
Assistant Clerk (W326A).....	332-1311
Asst Chief Clerk (E306).....	332-1143
Audits (700 W. State St., Ste 100).....	334-4875

- B -

Bailey, Lauren (954 W. Jefferson).....	332-1469
Baker, Leslie (954 W. Jefferson).....	332-1468
Barron, Jake (WG48C).....	332-1335
Bartlett, Amanda (954 W. Jefferson).....	332-1473
Bench, Janel (700 W. State St.).....	332-1295
Bengtzen, Amy (EW58).....	332-1148
Bennett, Gaye (W428).....	332-1307
Blackburn, Kim (E311).....	332-1151
Blades, Andrea (EW62).....	332-1136
Bloom, Benjamin (700 W. State St.).....	334-4872
Boden, Allison (W407).....	332-1416
Born, Ciley (E407).....	332-1120
Bowden, J.E. (700 W. State St.).....	334-4827
Bowen, Elizabeth (W123).....	334-4851
Boyer, Sean (W128).....	332-1291
Broadhead, Christopher (700 W. State St.).....	334-4847
Brown, Amy (700 W. State St.).....	334-4866
Budget, Policy & Analysis (C305).....	334-3531
Bush, Ryan (W140).....	334-4857
Business - House.....	332-1139
Bybee, Keith (C305).....	334-4739

- C -

Campbell, Kevin (C417).....	334-4741
Carver-Herbert, Wendy (EW08).....	332-1149
Casey, Cailin (W114).....	334-4732
Castano, Lindsay (700 W. State St.).....	334-4846

LEGISLATIVE ATTACHÉS & SUPPORT STAFF

(All area codes are 208 unless otherwise noted)

Central Administration (W114).....	334-2475
Chaplain - House.....	332-1111
Chaplain - Senate.....	332-1302
Chen, Noreen (W117).....	332-1297
Chief Clerk - House (E304).....	332-1141
Chief Fiscal Officer - House (E333).....	332-1112
Chief of Staff to Speaker (E303).....	332-1111
Clark, Norma (W118).....	334-4849
Coburn, Michele (E110).....	332-1068
Combo, Jim (700 W. State St.).....	334-4840
Commerce & Human Resources - House.....	332-1149
Commerce & Human Resources - Senate.....	332-1333
Conrad, Nancy (EW56).....	332-1127
Cook, Peter (W141).....	334-4859
Cox, Tyler (700 W. State St.).....	332-1299
Crenshaw, Sawyer (W326A).....	332-1312
Csutoras, Jerry (WW26).....	332-1401

- D -

Davis, Brayden (700 W. State St.).....	334-4869
De Grouchy, Haley (700 W. State St.).....	334-4871
Disney, Lara (W143).....	334-4852
Djokic, Denis (W128).....	332-1296
Doorkeeper, Pending.....	332-1403
Douglas, Cameron (EW54).....	332-1125
Drake, Matt (W142).....	334-4825
Dupree, Brooke (C419).....	334-4743

- E -

Earl, Brad.....	332-1154
Education - House.....	332-1148
Education - Senate.....	332-1321
Elliott, Michael (W116).....	334-4731
Engstrom, Joe (WG10B).....	332-1408
Environment, Energy & Technology - House.....	332-1128
Ethics and House Policy - House.....	332-1111

- F -

Feffer, Samuel (700 W. State St.).....	334-4874
Feik, Jayne (EW11).....	332-1137
Figueiredo, Tamara (C305).....	334-3537
Finance - Senate.....	334-4735
Fischer, Marissa (C114).....	334-4822

LEGISLATIVE ATTACHÉS & SUPPORT STAFF

(All area codes are 208 unless otherwise noted)

Fowler-Rynearson, Alicia (W330)..... 332-1303
Franks-Smith, Terri (E333)..... 332-1112

- G -

Gift Shop (CG24)..... 332-1013
Gipson, Shanna (W113)..... 334-4879

- H -

Hancock, Jason (E303)..... 332-1111
Hancock, Sarah (EG56)..... 332-1191
Harrington, Monica (W132)..... 334-4835
Hartwig, Casey (C104)..... 332-1280
Hatfield, Alex (C104)..... 332-1282
Hays, Roxanne (700 W. State St.)..... 334-4862
Headlee, Paul (W124)..... 334-4746
Health & Welfare - House..... 332-1138
Health & Welfare - Senate..... 332-1319
Heiner, Linsy (C305)..... 334-4735
Hemingway, Kate (W147)..... 334-4820
Hendon, Lori (700 W. State St.)..... 334-4868
Hernandez, Sophia (700 W. State St.)..... 334-4841
Hill, Ian (W116)..... 334-4878
Hyon, Jonathan (WG48A)..... 332-1417

- J -

Jackson, Alyson (C316)..... 334-4736
Jacobsen, Soren (W121)..... 334-4848
Jensen, Linda (W133)..... 334-4845
Jessup, Janet (C416)..... 334-4730
Johnson, Olivia (W144)..... 334-4843
Johnson, Shelly (WW37)..... 332-1323
Jones, Justin (700 W. State St.)..... 334-4861
Journal Clerk - House (E306)..... 332-1142
Journal Clerk - Senate (W326A)..... 332-1312
Judiciary & Rules - Senate..... 332-1317
Judiciary, Rules & Administration - House..... 332-1127

- K -

Kaae-Domgaard, Hayley (W114)..... 334-4855
Kambeitz, Linda (WW46)..... 332-1333
Kish, Jennifer (W149)..... 334-4854
Klosterman, Christa (WG10)..... 332-1418
Kondeff, Terri (W125)..... 334-4828

LEGISLATIVE ATTACHÉS & SUPPORT STAFF

(All area codes are 208 unless otherwise noted)

Kozlowski, Rebecca (WW35)..... 332-1319

- L -

Langrill, Ryan (954 W Jefferson - 2nd flr)..... 332-1475

Lawless, Meg (WW50)..... 332-1315

Legislative Advisors' Lounge (WG21)..... 343-6444

Legislative Information Center (Grdn Rotunda)..... 332-1000

Legislative Research Library (1st Floor C114)..... 334-4822

Legislative Services Office (W114)..... 334-4828

Lehosit, Christopher (C319)..... 332-1285

Leonova, Anastasia (700 W. State St.)..... 334-4873

Lippitt, Frances (C415)..... 334-4745

Lobbyists (WG21)..... 332-1980

Local Government & Taxation - Senate..... 332-1315

Local Government - House..... 332-1147

- M -

Malevich, Kirill (W116)..... 334-4734

Manor, Austin (WW24)..... 332-1337

Manser, Alex (700 W. State St.)..... 334-4833

McDonald, Sarah Jane (W307)..... 332-1400

McDonnell, Tracey (EW60)..... 332-1146

McFarland, Jeff (W120)..... 334-4870

McGinnis, Erica (E304)..... 332-1141

McGurkin, Kellen (C420)..... 332-1284

Meyers, Steven (W116)..... 332-1298

Miller, Erin (W304)..... 332-1351

Miller, Laura (EG29)..... 332-1134

Montgomery, Dalton (W134)..... 334-4853

Moore, Irene (EW14)..... 332-1138

Moss, Mackenzie (954 W. Jefferson)..... 332-1476

Moyer, Peggy (W435)..... 332-1341

- N -

Network Administration (W121)..... 334-4747

Novak, Jennifer (W327)..... 332-1309

- O -

O'Brien, Michelle (W135)..... 334-4850

OPE - Performance Eval (954 W. Jefferson-2nd flr).... 332-1470

Olson, Alli (W139)..... 334-4867

- P -

Pages - House (EW63)..... 332-1156

LEGISLATIVE ATTACHÉS & SUPPORT STAFF

(All area codes are 208 unless otherwise noted)

Pages - House (E311).....	332-1153
Pages - Senate (W306).....	332-1359
Pages - Senate (WW26).....	332-1357
Pennington, Sharon (WW48).....	332-1317
Penny, Alex (C104).....	332-1281
Peterson, Noah (C418).....	334-4749
Petti, Casey (954 W. Jefferson).....	332-1474
Phelan, Michael (700 W. State St.).....	334-4836
Phelan, Savannah (WW39).....	332-1321
Phipps, Elijah (EW16).....	332-1147
President of the Senate (E219).....	334-2200
Price, Melissa (WW33).....	332-1332

- R -

Reister, Kelly (W117).....	334-4744
Renfro, April (700 W. State St.).....	334-4826
Research & Legislation (W133).....	334-4834
Resources & Conservation - House.....	332-1136
Resources & Environment - Senate.....	332-1323
Revenue & Taxation - House.....	332-1125
Richardson, Liaza (EW46).....	332-1145
Robertson, Halle (Gift Shop).....	332-1013
Rollins, Don (700 W. State St.).....	334-4839
Root, Nikki (W326A).....	332-1311

- S -

Schreiter, Tasha (954 W. Jefferson).....	332-1471
Sec to Sec of Senate (W326).....	332-1310
Secretary of the Senate (W327).....	332-1309
Security, Main.....	334-2222
Sergeant at Arms - House (E311).....	332-1150
Sergeant at Arms - Senate (W307).....	332-1400
Shank, Chris (954 W. Jefferson).....	332-1472
Sherfick, Chad (W129).....	334-4877
Silvey, Layce (C113).....	334-4863
Simplot Nally, Claudia (W326).....	332-1310
Slominski, Kyle (W131).....	334-4821
Smith, Dianne (Gift Shop).....	332-1013
Smith, Morgan (700 W. State St.).....	334-4837
State Affairs - House.....	332-1145
State Affairs - Senate.....	332-1326
Swearingen, Kyra (EW12).....	332-1159

LEGISLATIVE ATTACHÉS & SUPPORT STAFF

(All area codes are 208 unless otherwise noted)

- T -

Tatro, Jared (C318).....	334-4740
Thomas, Joy (E331).....	332-1132
Titus, Ashley (700 W. State St.).....	334-4838
Transportation & Defense - House.....	332-1146
Transportation - Senate.....	332-1332

- U -

Upton, Ellen (W114).....	334-4858
Uriarte, Maria (700 W. State St.).....	334-4829

- V -

Van Amburg, Jacobi (E138).....	332-1051
Verrette, Rachel (WW31).....	332-1330
Vore, Cyrus (E306).....	332-1143

- W -

Wall, Jeff (E311).....	332-1150
Ways & Means - House.....	332-1159
Wells, Kathryn (WW42).....	332-1326
Werlinger, Susan (EW45).....	332-1161
Wheeler, Janni (W148).....	334-4842
Williamson, Alex (C421).....	334-4742
Winslow, Shane (C317).....	334-4738
Wisdom, Rellie (W331).....	332-1302
Wonacott, Michelle (E306).....	332-1142
Woods, Shelley (700 W. State St.).....	334-4832
Woodward, Benjamin (700 W. State St.).....	334-4864

- Y -

Yanak, Ann (WG48B).....	332-1343
Young, Kayla (700 W. State St.).....	334-4844

STATE GOVERNMENT

(All area codes 208 unless otherwise noted)

- A -

Administration, Department of	
Steve Bailey, Director.....	332-1812
Steve Walker, Deputy Director.....	332-1960
Aging, Commission on	
Judy B. Taylor, Director.....	334-3833
Agriculture, Department of	
Chanel Tewalt, Director.....	332-8500
Appellate Public Defender, State	
Erik Lehtinen.....	334-2712
Arts, Commission on the	
Laura Curry, Executive Director.....	488-7504
Attorney General's Office	
Raúl Labrador, Attorney General.....	334-2400
Phil Broadbent, Chief Deputy.....	334-2400
Phil Skinner, Chief of Staff.....	334-2400

- B -

Blind and Visually Impaired, Commission for the	
Beth Cunningham, Administrator.....	639-8373
Boise State University	
Dr. Marlene Tromp, President.....	426-1491
Jennifer White, Government Relations.....	426-4407
Brand Inspector	
Cody Burlile, Brand Inspector.....	884-7070
Building Authority, Idaho State	
Wayne Meuleman, Executive Director.....	345-6057

- C -

Capitol Commission	
Andrew Erstad, Chairman.....	331-9031
Career & Technical Education	
Joshua C. Whitworth, Interim Administrator.....	429-5530
Child Support	
Rob Rinard, Bureau Chief.....	334-0620
College of Agricultural and Life Sciences, UI	
Michael P. Parrella, Ph.D., Dean.....	885-6681
College of Eastern Idaho	
Lori Barber, EdD, President.....	535-5419
Angela Sackett, PhD, VP, Acad & Student Affairs..	535-5426
Byron Miles, MBA, VP, Finance & Admin.....	535-5387

STATE GOVERNMENT

(All area codes 208 unless otherwise noted)

College of Southern Idaho	
Dr. L. Dean Fisher, President.....	732-6201
Chris Bragg, Vice President, Operations.....	732-6775
Dr. Jonathan Lord, VP Student Services.....	732-6280
Tiffany Seeley-Case, Vice President, Instruction....	732-6779
College of Western Idaho	
Gordon Jones, President.....	562-3200
Ashley Smith, Government Relations.....	562-3106
Ken Kline, Vice President, Finance.....	562-3146
Nic Miller, Vice President, Operations.....	562-2215
Commerce, Department of	
Tom Kealey, Director.....	334-2470
Cody Allred, Public Information Officer.....	780-5152
Controller's Office	
Brandon D Woolf, State Controller.....	334-3100
Scott Smith, Chief Deputy.....	334-3100
Correction, Board of	
Dr. David McClusky, Chairman.....	658-2000
Correction, Department of	
Josh Tewalt, Director.....	658-2139
Bree Derrick, Deputy Director.....	658-2036
Correctional Industries	
Todd Plimpton, Division Chief.....	863-2244
- D -	
Deaf and the Blind, Idaho Educational Services for the	
Brian Darcy, Administrator.....	934-4457
Dalonna Hurd, Director of Finance.....	934-4457
Dental Education Program, ISU	
J. Jeffrey Ybarguen DDS, Director.....	282-3289
Developmental Disabilities, Council on	
Christine Pisani, Executive Director.....	334-2178
Disability Determinations Service	
William Hernandez, Bureau Chief.....	696-5486
Jon Speiser, Program Manager.....	696-5213
Domestic Violence and Victim Assist., Council on	
Dana Wiemiller, Executive Director.....	332-1545
Drug Policy, Office of	
Marianne King, Director.....	854-3043

STATE GOVERNMENT

(All area codes 208 unless otherwise noted)

- E -

ECHO Idaho, UI

(Extension for Community Health Outcomes)

Eric Studebaker, Director.....364-4698

Education, Department of

Debbie Critchfield, Superintendent of Public Inst... 332-6812

Greg Wilson, Chief of Staff..... 332-6814

Education, State Board of

Joshua Whitworth, Executive Director..... 332-1570

Dr. Linda Clark, President.....332-1571

William G. Gilbert, Jr., Vice President.....332-1571

Emergency Management, Idaho Office of

Brad Richy, Director.....258-6501

Endowment Fund Investment Board

Chris Anton, Manager of Investments..... 334-3312

Energy and Mineral Resources, Idaho Governor's Office of

Richard Stover, Administrator.....332-1660

Environmental Quality, Department of

Jess Byrne, Director.....373-0240

Kristin Ryan, Deputy Director.....373-0240

- F -

Family Medicine Residency, ISU

Brandon Mickelsen, D.O., Director..... 282-4508

Finance, Department of

Patricia Perkins, Director..... 332-8010

Anthony Polidori, Deputy Director.....332-8060

Financial Management, Div of

Lori Wolff, Administrator.....334-3900

Brad Hunt, Coordinator, Administrative Rules..... 854-3096

Fish and Game Commission

Ron Davies, Chairman.....681-4166

Fish and Game, Department of

Jim Fredericks, Director.....334-3771

Jon Rachael, Deputy Director.....334-3771

Amber Worthington, Deputy Director.....334-3771

Full Circle Health

Ted Epperly, M.D., President and CEO.....954-8745

- G -

Governor's Office

Brad Little, Governor.....334-2100

STATE GOVERNMENT

(All area codes 208 unless otherwise noted)

Zach Hauge, Chief of Staff.....334-2100

- H -

Health and Welfare, Board of

Chad Henggeler, Chairman.....412-5076

Health and Welfare, Department of

Alex Adams, Director.....334-5500

Juliet Charron, Deputy Director.....334-5500

Michael Pearson, Deputy Director.....334-5500

Monty Prow, Deputy Director.....334-5500

Miren Unsworth, Deputy Director.....334-5500

Jared Larsen, Leg / Reg Affairs Chief.....334-5500

Hispanic Affairs, Commission on

Margie Gonzalez, Executive Director.....334-3776

Historical Society, Idaho State

Janet L. Gallimore, Executive Director.....334-2682

Human Resources, Division of

Janelle White, Administrator.....871-2871

Human Rights Commission

Benjamin J. Earwicker, JD, PhD, Administrator.....696-2448

- I -

Idaho Housing and Finance Association

Gerald M. Hunter, President.....331-4732

Idaho Potato Commission

Jamey Higham, President/CEO.....334-2350

Idaho Public Television

Jeff Tucker, General Manager.....373-7220

Idaho State Police

Colonel Bill Gardiner, Director.....884-7001

Lt. Colonel Russ Wheatley, Deputy Director.....884-7004

Lt. Colonel Fritz Zweigart, Deputy Director.....884-7002

Brad Johnson, Div Admin, POST Academy.....884-7251

Idaho State University

Robert Wagner, President.....282-3310

Idaho Water Resource Board

Jeff Raybould, Chairman.....287-4800

Jo Ann Cole-Hansen, Vice Chair.....287-4800

Industrial Commission

George Gutierrez, Director.....334-6000

Information Technology Services, Office of

Alberto Gonzalez, Administrator.....605-4067

STATE GOVERNMENT

(All area codes 208 unless otherwise noted)

Brian Smith, Deputy Administrator.....	605-4051
Insurance Fund, State	
Rick Ferguson, CEO.....	332-2100
Insurance, Department of	
Dean L. Cameron, Director.....	334-4250

- J -

Judicial Branch, Supreme Court	
Sara B. Omundson, Administrative Director.....	334-2246
Jason Slade Spillman, Legal Counsel.....	334-2246
Juvenile Corrections, Department of	
Ashley Dowell, Director.....	577-5404

- L -

Labor, Department of	
Jani Revier, Director.....	344-6110
Darlene Carnopis, Comm & Research.....	696-2380
Lands, Department of	
Dustin Miller, Director.....	334-0242
Bill Haagenson, Deputy Director.....	334-0242
Scott Phillips, Policy and Communications Chief...	334-0294
Lava Hot Springs Foundation	
Tyson Koester, Executive Director.....	776-5221
Legislative Services Office	
Terri Kondeff, Director.....	334-4828
Lewis-Clark State College	
Cynthia Pemberton, Ed.D., President.....	792-2216
Logan Fowler, Communications.....	792-2200
Libraries, Idaho Commission for	
Stephanie Bailey-White, State Librarian.....	639-4145
Lieutenant Governor's Office	
Scott Bedke, Lieutenant Governor.....	334-2200
Liquor Division	
Andrew Arulanandam , Director.....	947-9402
Lottery Commission	
Andrew Arulanandam, Director.....	780-2500

- M -

Military Division	
Maj Gen Tim Donnellan, Adjutant General.....	801-4200
Museum of Natural History, Idaho	
Dr. Leif Tapanila, Director.....	282-5417

STATE GOVERNMENT

(All area codes 208 unless otherwise noted)

- N -

North Idaho College

Nick Swayne, PhD, President..... 769-3301
Sarah Garcia, VP for Finance & Business Affairs... 769-3340
Tom Greene, Interim Chief Comm/Gov Rel..... 769-3404

Northwest Power and Conservation Council

Jeffery Allen, Idaho Member..... 947-4084
Ed Schriever, Idaho Member..... 947-4083

- O -

Occupational and Professional Licenses, Division of

Russell Barron, Division Administrator..... 577-2482
Katelyn Hobbs, Exec Management Assistant..... 577-2500

- P -

Pardons and Parole, Commission of

Christina Starr, Executive Director..... 334-2520

Parks and Recreation Board

Brian Beckley, Chairman..... 867-7945

Parks and Recreation, Department of

Susan Buxton, Director..... 514-2251

Public Defender, State

Eric Fredericksen, State Public Defender..... 810-0135
Kathleen Elliott, Deputy Director..... 869-3124

Public Employee Retirement System (PERSI)

Michael Hampton, Executive Director..... 287-9290
Alex Simpson, Deputy Director..... 287-9255
Jeff Cilek, Chairman..... 287-9230

Public Health Districts

Erik Ketner, Director, Hayden, D1..... 415-5100
Kayla Sprenger, Director, Lewiston, D2..... 799-3100
Nikole Zogg, Director, Caldwell, D3..... 455-5300
Russell Duke, Director, Boise, D4..... 375-5211
Melody Bowyer, Director, Twin Falls, D5..... 737-5900
Maggie Mann, Director, Pocatello, D6..... 233-9080
James Corbett, Director, Idaho Falls, D7..... 522-0310

Public Television, Idaho

Jeff Tucker, General Manager..... 373-7220

Public Utilities Commission

Maria Barratt-Riley, Executive Administrator..... 334-0337

STATE GOVERNMENT

(All area codes 208 unless otherwise noted)

- R -

Racing Commission

Anisha Jones, Business Operations Manager.....954-6830

- S -

Secretary of State, Office of the

Phil McGrane, Secretary of State..... 334-2300

Soil and Water Conservation Commission

Delwyne Trefz, Administrator.....332-1790

Species Conservation, Office of

Mike Edmondson, Administrator.....332-1551

- T -

Tax Appeals, Board of

Leland "Lee" Heinrich, Chairman.....334-3354

Cindy Pollock, Director & Clerk.....334-3354

Tax Commission

Jeff McCray, Chairman..... 334-7500

Aaron Yost, Government Affairs Manager.....334-7533

Janet Moyle, Commissioner..... 334-7500

Paul Woods, Commissioner..... 334-7500

Jared Zwygart, Commissioner..... 334-7500

Transportation Board, Idaho

Bill Moad, Chairman.....250-0113

To Be Determined, Member, D1.....### ####

Gary Osborn, Member, D2..... 509-336-3958

Julie DeLorenzo, Member, D3..... 703-4348

Mitch Watkins, Member, D4.....280-3031

John Bulger, Member, D5.....406-370-4095

Bob Hoff, Member, D6..... 521-2092

Transportation Department, Idaho

L. Scott Stokes, Director..... 334-8839

Dan McElhinney, Chief Operations Officer..... 334-8820

Treasurer, Office of the State

Julie A. Ellsworth, State Treasurer..... 334-3200

- U -

University of Idaho

C. Scott Green, President.....885-6365

Caroline Nilsson Troy, Governmental Relations.....885-8920

STATE GOVERNMENT

(All area codes 208 unless otherwise noted)

- V -

Veterans Services, Division of	
Mark Tschampl, Chief Administrator.....	780-1300
Vocational Rehabilitation, Division of	
Judy Thomas, Interim Administrator.....	334-3390

- W -

WIMU Veterinary Degree Program	
(Washington-Idaho-Montana-Utah)	
Michael P. Parrella, Ph.D., Dean.....	885-6681
WWAMI Medical Education, UI	
(Washington, Wyoming, Alaska, Montana, Idaho)	
Jeff Seegmiller, Ed.D., ATC, Regional Dean.....	885-6696
Water Resources, Department of	
Mathew Weaver, Director.....	287-4800
Shelley Keen, Deputy Director.....	287-4947
Brian Patton, Deputy Director.....	287-4837
Western Interstate Commission for Higher Education (WICHE)	
Dr. Demarée Michelau, President.....	303-541-0201

ELECTED OFFICIALS

(All area codes are 208 unless otherwise noted)

Congressional

Senator Mike Crapo (R)

Dirksen Senate Office Building

Room 239

Washington, DC 20510 202-224-6142

251 E. Front St., Ste. 205, Boise 83702 208-334-1776

Senator James E. Risch (R)

Russell Senate Office Building

Room 483

Washington, DC 20510 202-224-2752

350 N. 9th St., Ste. 302, Boise 83702 208-342-7985

Congressman Russ Fulcher (R)

Longworth House Office Building

Room 1520

Washington, DC 20515 202-225-6611

33 E Broadway Av Ste 251, Meridian 83642 . 208-888-3188

Congressman Mike Simpson (R)

Rayburn House Office Building

Room 2084

Washington, DC 20515 202-225-5531

802 W. Bannock, Ste. 600, Boise 83702 208-334-1953

State

Governor Brad Little (R) 334-2100

Capitol Building, Room W223

700 W. Jefferson St., P.O. Box 83720, Boise 83720-0034

Lieutenant Governor Scott Bedke (R) 334-2200

Capitol Building, Room E219

700 W. Jefferson St., P.O. Box 83720, Boise 83720-0057

Secretary of State Phil McGrane (R) 334-2300

Capitol Building, Room E205

700 W. Jefferson St., P.O. Box 83720, Boise 83720-0080

ELECTED OFFICIALS

(All area codes are 208 unless otherwise noted)

State

- State Controller Brandon D Woolf (R) 334-3100
J.R. Williams Building, 5th Floor
700 W. State St., P.O. Box 83720, Boise 83720-0011
- State Treasurer Julie A. Ellsworth (R) 334-3200
Capitol Building, Room E228
700 W Jefferson, P.O. Box 83720, Boise 83720-0091
- Attorney General Raúl Labrador (R) 334-2400
Capitol Building, Room C210
700 W. Jefferson St., P.O. Box 83720, Boise 83720-0010
- Supt Public Instruct Debbie Critchfield (R) 332-6812
Len B. Jordan Building, 2nd Floor
650 W. State St., P.O. Box 83720, Boise 83720-0027

Judicial Branch

- Administration 334-2246
451 W. State St., P.O. Box 83720, Boise 83720-0101

Supreme Court:

Chief Justice G. Richard Bevan
Justices: Robyn Brody, Cynthia K.C. Meyer,
Gregory W. Moeller, Colleen Zahn

Court of Appeals:

Chief Judge David W. Gratton
Judges: Molly J. Huskey, Jessica M. Lorello,
Michael Tribe

CAPITOL CORRESPONDENTS

(All area codes are 208 unless otherwise noted)

- Associated Press 863-8761
Rebecca Boone, rboone@ap.org
- Boise Weekly 344-2055
Jeanne Huff, jhuff@boiseweekly.com . . x3015
Kate Noden, knoden@boiseweekly.com . . x3034
- BoiseDev
Margaret Carmel, margaret@boisedev.com
Sydney Kidd, sydney@boisedev.com
Erin Banks Rusby, erin@boisedev.com
Don Day, don@boisedev.com
- Capital Press Ag Weekly, Boise 914-8264
Brad Carlson, bcarlson@capitalpress.com 891-2406
- Idaho Business Review
Marc Lutz, mlutz@idahobusinessreview.com . . 639-3518
Steve Lombard, slombard@idahobusinessreview.com
- Idaho Capital Sun
Clark Corbin, ccorbin@idahocapitalsun.com
Christina Lords, clords@idahocapitalsun.com
Mia Maldonado, mmaldonado@idahocapitalsun.com
Kyle Pfannenstiel, kpfann@idahocapitalsun.com
- Idaho Education News
Jennifer Swindell 473-8811
jswindell@idahoednews.org
Kevin Richert, krichert@idahoednews.org 867-1403
Ryan Suppe, ryan@idahoednews.org . . (702) 271-5740
- Idaho Falls Post Register 522-1800
news@postregister.com
- Idaho Press, Nampa 465-8124
Laura Guido, lguido@idahopress.com . . (509) 339-5783
Royce McCandless 859-8299
rmccandless@idahopress.com
- Idaho Statesman, Boise 377-6400
Ian Stevenson 274-3538
istevenson@idahostatesman.com
Scott McIntosh 377-6202
smcintosh@idahostatesman.com
Becca Savransky 495-5661
bsavransky@idahostatesman.com

CAPITOL CORRESPONDENTS

(All area codes are 208 unless otherwise noted)

- Lewiston Tribune 743-9411
Matt Baney, mbaney@lmtribune.com
August Frank, afrank@lmtribune.com
Liesbeth Powers, lpowers@lmtribune.com
- Idaho Public Television 373-7220
Idaho Reports
Ruth Brown, Ruth.Brown@idahoptv.org
Morgan McCollum, Morgan.McCollum@idahoptv.org
Logan Finney, Logan.Finney@idahoptv.org
Melissa Davlin, Melissa.Davlin@idahoptv.org
Kaylie Hilliker, Kaylie.Hilliker@idahoptv.org
createid
Marcia Franklin, Marcia.Franklin@idahoptv.org
Science Trek
Joan Cartan-Hansen, JCH@idahoptv.org
- KBOI-TV 2, "CBS2," Boise 472-2207
Marcos Guadarrama, mguadarrama@idahonews.com
Eric Walker, ewwalker@idahonews.com
- KIFI-TV 8 "Local News 8," Idaho Falls 525-2520
KIDK-TV 3; KXPI- Fox
Linda Larson, linda.larson@localnews8.com
Stephanie Lucas, stephanie.lucas@localnews8.com
- KIVI-TV 6 "Idaho News 6," Nampa 381-6660
Don Nelson, Don.Nelson@kivitv.com
- KMVT-TV 11 "News 11," Twin Falls 733-6407
Heatherann Wagner (818) 239-9834
Heatherann.Wagner@kmtv.com
- KPVI-TV 6 "News 6," Pocatello 232-6666
Misty Inglet, minglet@kpvi.com
- KTVB-TV 7, Boise 321-5614
Joe Parris, jparris@ktvb.com
- KBSX 91.5, BSU Public Radio 426-3663
James Dawson, jdawson@boisestate.edu 426-3627
Samantha Wright, swright@boisestate.edu 426-3613
Troy Oppie, troyoppie@boisestate.edu . . (206) 235-3989

* Capitol Correspondents are members of the media who are officially credentialed to work in the Capitol Building during the legislative session.

ORDERS OF BUSINESS

SENATE

1. Roll Call
2. Prayer and Pledge of Allegiance
3. Reading and correction of Journal
4. Reading of communications
5. Presentation of petitions, resolutions and memorials
6. Reports of standing committees
7. Reports of special committees
8. Consideration of messages from the Governor
9. Consideration of messages from the House of Representatives
10. Motions and consideration of petitions, resolutions and memorials
11. Introduction, first reading and reference of bills
12. Second reading of bills
13. Third reading of bills
14. Consideration of general calendar
15. Miscellaneous business

HOUSE

1. Roll Call
2. Prayer and Pledge of Allegiance
3. Approval of Journal
4. Consideration of messages from the Governor and the Senate
5. Report of standing committees
6. Report of select committees
7. Motions, memorials and resolutions
8. Introduction, first reading and reference of bills and joint resolutions
9. First reading of engrossed bills
10. Second reading of bills and joint resolutions
11. Third reading of bills and joint resolutions
12. Consideration of general orders
13. Miscellaneous and unfinished business
14. Presentation of petitions and communications
15. Announcements
16. Adjournment